

PHILIPS

AC4076

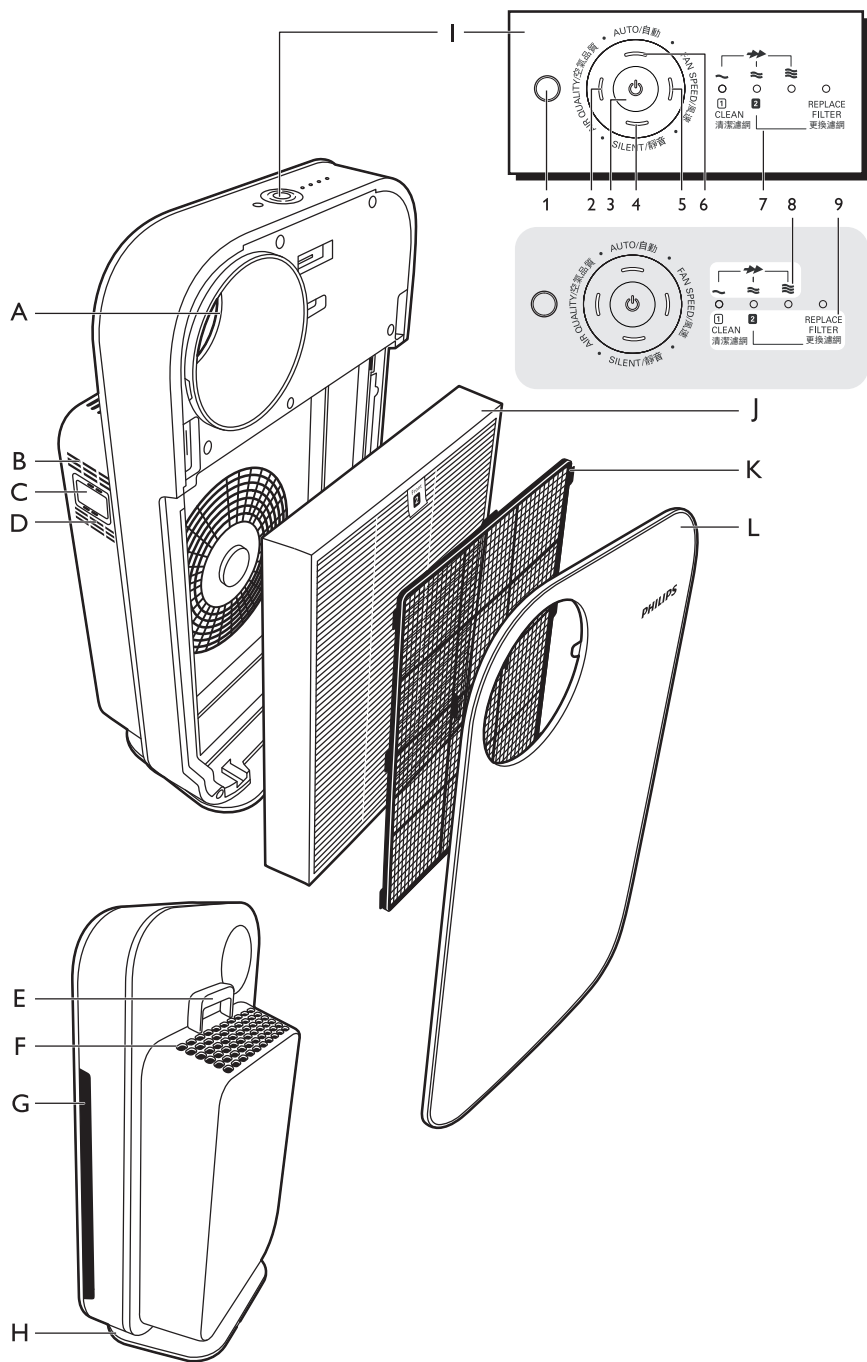



Introduction

Congratulations on your purchase and welcome to Philips! To fully benefit from the support that Philips offers, register your product at www.philips.com/welcome.

With this air purifier with advanced highly effective German filtration technology, you breathe cleaner air in your home. For the best result, place the air purifier in a room where you spend most of your time, such as your bedroom, living room, or children's room.

There are many pollution sources. In a home, there can be high condensation of formaldehyde and other harmful gases coming from furniture, paints and smoking, etc. Because these harmful pollutants can be invisible and odorless, they can affect your health. The Philips air purifier filters off these harmful gases quickly and effectively. Furthermore, it can also filter out pollutants such as pollens pm2.5 and bacteria, airborne particles that can affect your well-being. With our air purifier, it improves the air quality and ensures you and your family members breathe cleaner air at your home.

Filtration in a professional and credible way

The air purifier has all-in-one high-efficiency formaldehyde removal HEPA filter that ensures the best air quality in your home:

- Stage 1: The pre-filter has been treated with antibacterial substances. It catches big particles like human hair, pet hair, etc.
- Stage 2: The high-efficiency formaldehyde removal HEPA filter filters out dust, pollen and ultrafine particles larger than 20 nanometers, including bacteria and some viruses. According to publications of the World Health Organization, the avian and human influenza viruses and Legionella bacterium are larger than 20 nanometers.

General description (Fig. 1)

- A Air quality light ring
- B Air quality sensor outlet
- C Air quality sensor
- D Air quality sensor inlet
- E Handle
- F Air outlet
- G Air inlet
- H Cord storage facility
- I Control panel
 - 1 Light sensor for night mode
 - 2 AIR QUALITY on/off button with light
 - 3 Power on/off button with light
 - 4 SILENT button with light
 - 5 FAN SPEED button with light

- 6 AUTO button with light
- 7 Fan speed lights (1, 2, 3 and boost power)/filter replacement lights
- 8 FAN SPEED indications
- 9 REPLACE FILTER indications
- J Filter 2: High-efficiency formaldehyde removal HEPA filter AC4147
- K Filter 1: pre-filter
- L Front panel

Important

Read this user manual carefully before you use the appliance and save it for future reference.

Danger

- Do not let water or any other liquid or flammable detergent enter the appliance to avoid electric shock and/or a fire hazard.
- Do not clean the appliance with water or any other liquid or a (flammable) detergent to avoid electric shock and/or a fire hazard.

Warning

- Check if the voltage indicated on the bottom of the appliance corresponds to the local mains voltage before you connect the appliance.
- If the mains cord is damaged, you must have it replaced by Philips, a service centre authorised by Philips or similarly qualified persons in order to avoid a hazard.
- Do not use the appliance if the plug, the mains cord or the appliance itself is damaged.
- This appliance can be used by children aged from 8 years and above and persons with reduced physical, sensory or mental capabilities or lack of experience and knowledge if they have been given supervision or instruction concerning use of the appliance in a safe way and understand the hazards involved. Children shall not play with the appliance. Cleaning and maintenance shall not be made by children without supervision.
- Do not block the air inlet and outlet, e.g. by placing items on the air outlet or in front of the air inlet.

Caution

- This appliance is not a substitute for proper ventilation, regular vacuum cleaning or use of an extractor hood or fan while cooking.
- If the wall socket used to power the appliance has poor connections, the plug of the appliance becomes hot. Make sure you plug the appliance into a properly connected wall socket.

- Always place and use the appliance on a dry, stable, level and horizontal surface.
- Leave at least 20cm free space behind and on both sides of the appliance and leave at least 30cm free space above the appliance.
- Do not place anything on top of the appliance and do not sit on the appliance.
- Do not place the appliance directly below an air conditioner to prevent condensation from dripping onto the appliance.
- Make sure all filters are properly installed before you switch on the appliance.
- Only use the original Philips filters specially intended for this appliance. Do not use any other filters.
- Avoid knocking against the appliance (the air inlet and outlet in particular) with hard objects.
- Always lift or move the appliance by the handle at the back of the appliance.
- Do not insert your fingers or objects into the air outlet.
- Do not use this appliance when you have used indoor smoke-type insect repellents or in places with oily residues, burning incense or chemical fumes.
- Do not use the appliance near gas appliances, heating devices or fireplaces.
- Always unplug the appliance after use and before you clean it.
- Do not use the appliance in a room with major temperature changes, as this may cause condensation inside the appliance.
- The appliance is only intended for household use under normal operating conditions.
- Do not use the appliance in wet surroundings or in surroundings with high ambient temperatures, such as the bathroom, toilet or kitchen.
- The appliance does not remove carbon monoxide (CO) or radon (Rn). It cannot be used as a safety device in case of accidents with combustion processes and hazardous chemicals.

Electromagnetic fields (EMF)

This Philips appliance complies with all applicable standards and regulations regarding exposure to electromagnetic fields.

Before first use

Placing the filters

Before using the appliance for the first time, remove the packaging materials of filter 2 and place it into the appliance as described below.

Tip: Place the appliance against a wall for more stability when you remove or insert filters.

Note: Make sure you insert the filters in the correct position.

- 1** Place your fingers in the recesses of the side panels and gently pull the top part of the front panel towards you. Then lift the hooks at the bottom of the panel out of the bottom of the appliance.

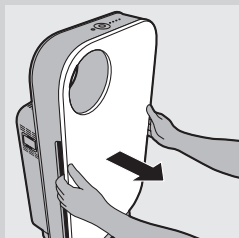

- 2** Grab the two projections and pull the pre-filter towards you to take it out of the appliance.

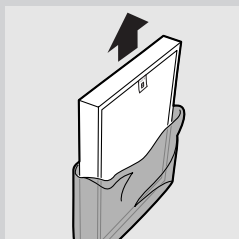

- 3** Remove the packaging material of filter 2 (high-efficiency formaldehyde removal HEPA filter).

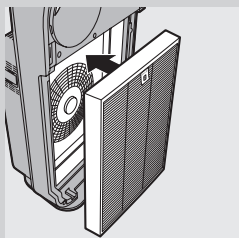

- 4** Put filter 2 (high-efficiency formaldehyde removal HEPA filter) into the appliance.

Note: Make sure that the side with the tag is pointing towards you.

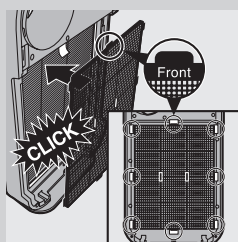

- 5** Place filter 1 (pre-filter) in the appliance.

Note: Make sure that the side with the two projections is pointing towards you.

Note: Make sure that all hooks are properly attached to the appliance.

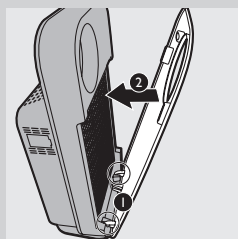

- 6** To reattach the front panel, insert the bottom hooks into the bottom of the appliance first (1). Then push the panel against the body of the appliance (2).

Using the appliance

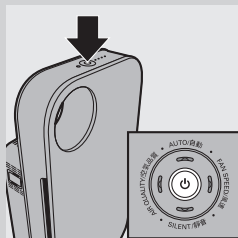

- 1** Put the plug in the wall socket

► All lights go on twice and you hear a beep. Then the lights go out again.

- 2** Press the on/off button to switch on the appliance.

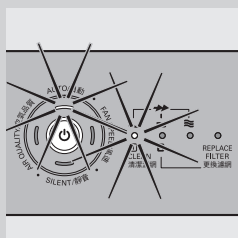

► The power-on light, the AUTO light, and the AIR QUALITY light on the control panel go on.

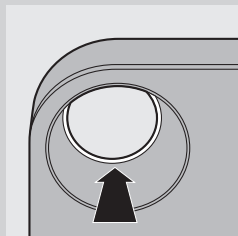

► The air quality light ring shows the quality of the air.

Air quality indication

Colour	Air quality
Blue	Very good
Deep purple	Good
Purple	Fair
Red	Bad

To switch off the air quality light ring, press the AIR QUALITY button.

Note: *The air quality light ring automatically goes on when the appliance is switched on.*

► The appliance automatically starts operating in the AUTO mode.

To switch off the appliance, press the on/off button again and unplug the appliance.

Note: *When the humidity level in the room is very high, it is possible that condensation develops on the air quality sensor. As a result, the AIR QUALITY light on the control panel and the air quality light ring may indicate that the air quality is bad even though the air quality is good. In this case, the auto mode causes the appliance to run at high fan speed. You can solve this by cleaning the air quality sensor. If condensation develops frequently during periods of high humidity, we advise you to use one of the manual speed settings.*

Fan speed lights/filter replacement lights

- The lights on the right-hand side of the control panel have a dual function: they either indicate the fan speed or they indicate that the filters should be replaced or cleaned.
- When lights 1 to 2 light up continuously, they indicate the current fan speed.
- When light 1 flashes, you have to clean the pre-filter. When lights 2 flashes, you have to replace the high-efficiency formaldehyde removal HEPA filter.
- When light 2 and the REPLACE FILTER light are flashing continuously, the high-efficiency formaldehyde removal HEPA filter have to be replaced, and the appliance is locked (see chapter 'Filter replacement lock' for more information).

Adjusting the air quality sensor sensitivity

People with certain health problems (e.g. allergies or asthma) have a greater need for healthy air. For this reason, the appliance allows you to adjust the sensitivity of the air quality sensor. If you set it to higher sensitivity level, the appliance starts cleaning the air at lower pollution level.

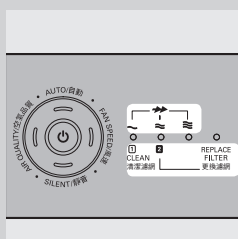

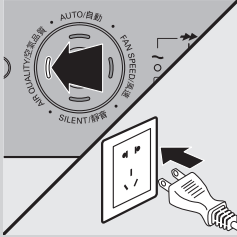

There are 3 sensitivity levels:

- standard
- sensitive
- extra sensitive

The pollution sensor is set to standard sensitivity by default. You can adjust the sensitivity of the air quality sensor in the following way:

- 1** If the appliance is already plugged in, unplug the appliance and wait for a few minutes.
- 2** Press the AIR QUALITY button and simultaneously put the mains plug in the wall socket.
- ▶ The appliance beeps twice and one of the fan speed lights flashes to show the current sensitivity level of the air quality sensor.

Sensitivity level:

Fan speed light	Sensitivity level
~	Extra sensitive
~	Sensitive
~	Standard

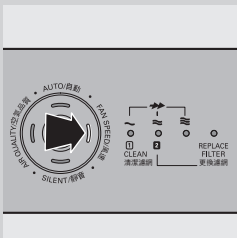

- 3** Press the FAN SPEED button to adjust the sensitivity level of the air quality sensor.

▶ One of the fan speed lights flashes to show the set sensitivity level of the air quality sensor.

- 4** Press the on/off button to switch off the appliance.

Note: When you change the sensitivity level, the appliance automatically starts operating at the set sensitivity level whenever you switch on the appliance.

Auto mode

When the appliance is switched on, the built-in air quality sensor automatically measures the ambient air quality. When the auto mode is activated, the appliance selects the most appropriate fan speed for the measured air quality.

- 1** Press the on/off button to switch on the appliance.
- 2** Press the AUTO button to activate the auto mode.

Note: When the appliance is operating in another mode and you want to activate the auto mode, simply press the **AUTO** button.

- ▶ The AUTO light goes on.

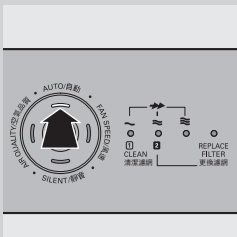

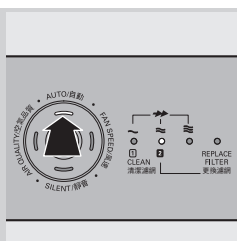

- The FAN SPEED light indicates at which fan speed the appliance is operating.

Note: When the air quality is very good and the appliance operates at a very low fan speed, the FAN SPEED light for the lowest speed setting does not go on. In this case only the power-on light and the AUTO light are on.

Note: The built-in air quality sensor measures the air quality and automatically selects the appropriate speed setting to ensure the best possible air quality in your room. When the air is clean, the appliance stops running. When the air quality deteriorates, the appliance starts running at a low fan speed and noise level so that the energy consumption is minimised.

Night mode

The appliance works in harmony with its surroundings. In auto mode, the appliance automatically switches to night mode when the room in which it is operating becomes dark. When the room has been dark for 3 minutes, the lights of the appliance go out, the fan speed and noise level are reduced and the energy consumption is minimised. If the room becomes bright again for 5 minutes or longer, the appliance resumes normal operation.

Note: The night mode only works when the appliance is operating in the auto mode.

Fan speed

If you do not use the auto mode, you can select the desired fan speed yourself.

- 1 Press the on/off button to switch on the appliance.
 - 2 Press the FAN SPEED button one or more times to select the desired fan speed.
- The corresponding fan speed light and the indications above the lights show the set fan speed (～, ≈, ≡ or ➞).

Note: Select boost power (➞) if you need an extra strong airflow when the air in the room is very dirty. Lights ～ to ≈ light go on.

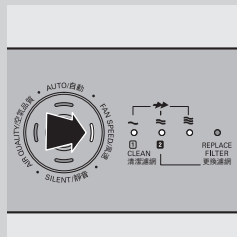
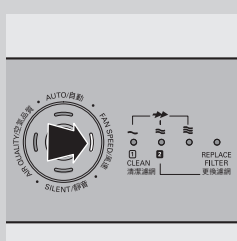

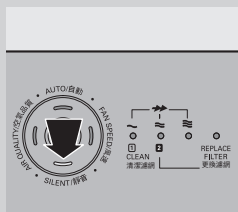

Silent mode

When you use the appliance in silent mode, it operates very quietly.

1 Press the on/off button to switch on the appliance.

2 Press the SILENT button to activate the silent mode.

► The SILENT light goes on.

If you want to go back to the FAN SPEED mode or AUTO mode, simply press the FAN SPEED or AUTO button.

Cleaning

Always unplug the appliance before you clean it.

Never immerse the appliance in water or any other liquid.

Never use aggressive or flammable cleaning agents such as bleach or alcohol to clean any part of the appliance.

Only the pre-filter is washable.

Body of the appliance

Regularly clean the inside and outside of the body to prevent dust from collecting on the inside and outside.

1 Wipe away dust with a soft dry cloth from the body of the appliance.

2 Clean the air inlet and the air outlet with a soft dry cloth.

Pre-filter

The pre-filter is washable and vacuum cleanable.

- Clean the pre-filter when the first filter replacement light flashes to ensure optimal functioning of the appliance.

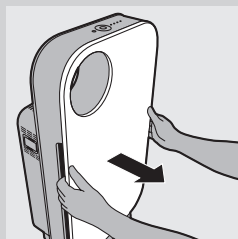
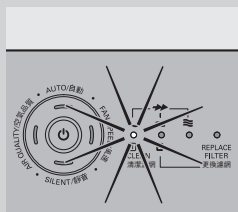

1 Place your fingers in the recesses of the side panels and gently pull the top part of the front panel towards you. Then lift the hooks at the bottom of the panel out of the bottom of the appliance.

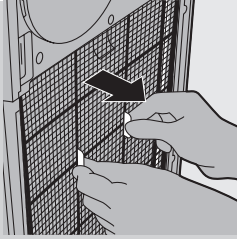

- 2** To remove the pre-filter, grab the two projections and pull the filter towards you.

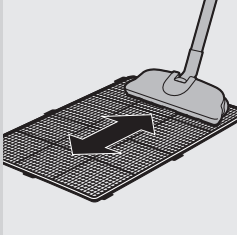

- 3** Clean the pre-filter by removing the dust with a vacuum cleaner.

Tip: Alternatively, you can wash the pre-filter under a running tap. If the pre-filter is very dirty, use a soft brush to brush away the dust. In this case, make sure that the pre-filter is completely dry before putting it back into the air purifier. If it is still wet, bacteria may multiply in it and shorten the lifetime of the pre-filter.

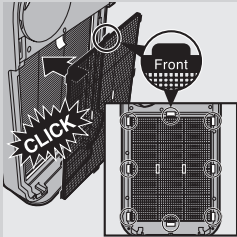

- 4** Put the pre-filter back into the appliance. Attach all hooks properly to the appliance.

Note: Make sure that the side with the two projections is pointing towards you.

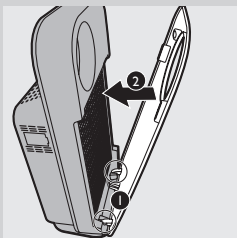

- 5** To reattach the front panel, insert the bottom hooks into the bottom of the appliance first (1). Then push the panel against the body of the appliance (2).

Air quality sensor

Clean the air quality sensor every 2 months for optimal functioning of the appliance. Clean it more frequently if you use the appliance in a dusty environment.

Note: When the humidity level in the room is very high, it is possible that condensation develops on the air quality sensor. As a result, the AIR QUALITY light on the control panel and the air quality light ring may indicate that the air quality is bad even though the air quality is good. In this case you have to clean the air quality sensor or use one of the manual speed settings.

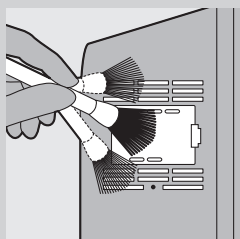

1 Clean the air quality sensor inlet and the air quality sensor outlet with a soft brush.

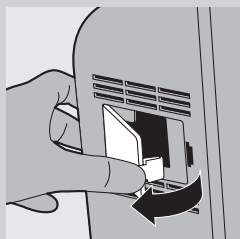

2 Remove the air quality sensor cover.

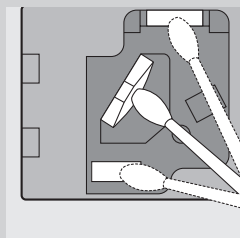

3 Clean the air quality sensor, the dust inlet and the dust outlet with a lightly moistened cotton swab.

4 Dry them with a dry cotton swab.

5 Reattach the air quality sensor cover.

Filter replacement

Filter maintenance

This appliance is equipped with the Healthy air protect lock to ensure that the filters are in optimal condition when the appliance is operating. When one of the filters is almost full and has to be cleaned or replaced, the appropriate filter replacement light starts to flash. When you do not replace the high-efficiency formaldehyde removal HEPA filter, the appliance stops operating and the appliance is locked. When the appliance is locked, the filter replacement light of the filter concerned lights up continuously.

Note: Only replace a filter when the filter replacement light flashes. If you replace the filter before the filter replacement light starts flashing, the lifetime counter will not be reset but will continue counting the lifetime of the previous filter. As a result, the filter replacement light will start flashing much too soon.

Filter replacement lights

The filter replacement lights indicate which filter has to be cleaned or replaced.

- Filter replacement light 1 flashes: filter 1 (the pre-filter) has to be cleaned. See chapter 'Cleaning' for further instructions.
- Filter replacement light 2 flashes: the high-efficiency formaldehyde removal HEPA filter has to be replaced.

Healthy air protect lock

If you do not replace the filter in time, the appliance stops operating approx. 2 weeks after the filter replacement light started flashing. When the appliance is locked, it does not operate until you have replaced with the new filter and pressed the reset button.

Note: When filter replacement lights 2 and REPLACE FILTER on the control panel are on continuously, the appliance is locked (see section 'Filter maintenance' in this chapter for more information).

How long it takes before the appliance is locked depends on the operating time and speed level selected after the filter replacement alert.

Approximately 1 day before the appliance locks, it beeps every 30 minutes to inform you that one of the filters needs to be replaced.

When the appliance is locked, you hear a beep when you press any button. You can switch off the appliance by pressing the on/off button.

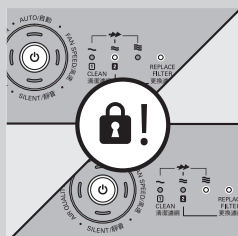
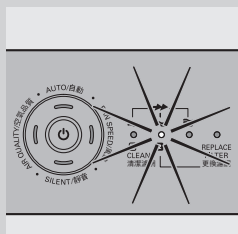
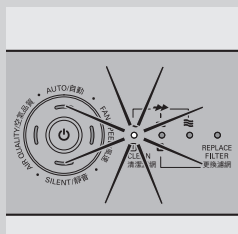

If the appliance is locked:

- 1** Check which filter needs to be replaced (see section 'Filter replacement lights').
- 2** Switch off the appliance and unplug it.
- 3** Replace the appropriate filter (see section 'Replacing the filters').

Replacing the filters

Tip: Place the appliance against a wall for more stability when you remove or insert filters.

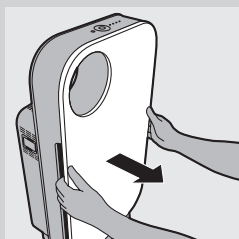

- 1** Switch off the appliance and unplug it.
- 2** Place your fingers in the recesses of the side panels and gently pull the top part of the front panel towards you. Then lift the hooks at the bottom of the panel out of the bottom of the appliance.



- 3** To remove filter 1 (pre-filter), grab the two projections and pull the filter towards you.

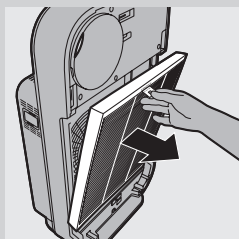

- 4** To remove filter 2 (high-efficiency formaldehyde removal HEPA filter), grab its tag and pull it towards you.
- 5** Discard the filter that needs to be replaced and unpack the new filter.

Note: Do not touch the pleated filter surface, or smell the filter as it has collected pollutants from the air.

Note: Wash your hands after disposing of the used filters.

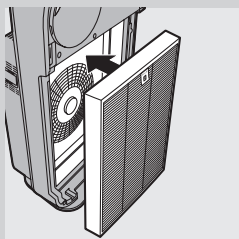

- 6** Put filter 2 (high-efficiency formaldehyde removal HEPA filter) back into the appliance.

Note: Make sure that the side with the tag is pointing towards you.

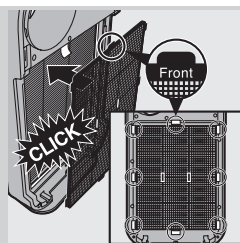

- 7** Put filter 1 (pre-filter) back into the appliance.

Note: Make sure that the side with the two projections is pointing towards you.

Note: Make sure that all hooks are properly attached to the appliance.

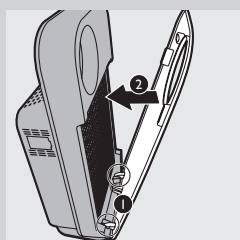

- 8** To reattach the front panel, insert the bottom hooks into the bottom of the appliance first (1). Then push the panel against the body of the appliance (2).

- 9** Put the plug in the wall socket and switch on the appliance again.

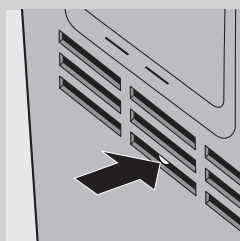

- 10** Press the filter reset button with a thin tool.

Note: You do not need to press the filter reset button after cleaning filter 1 (pre-filter).

Note: You cannot reset the appliance when you replace a filter before its filter replacement light starts flashing.

Note: You cannot reset the appliance if it is not plugged in and switched on.

Storage

To store the mains cord, wind it round the cord storage facility at the bottom of the appliance.

Accessories

New filters are available under the following type numbers:

Filter	Type number
Filter 2: High-efficiency formaldehyde removal HEPA filter	AC4147

Environment

- Do not throw away the product with the normal household waste at the end of its life, but hand it in at an official collection point for recycling. By doing this, you help to preserve the environment.
- Follow your country's rules for the separate collection of electrical and electronic products. Correct disposal helps prevent negative consequences for the environment and human health.

Guarantee and service

If you need information or if you have a problem, please visit the Philips website at www.philips.com or contact the Philips Consumer Care Centre in your country (you find its phone number in the worldwide guarantee leaflet). If there is no Consumer Care Centre in your country, go to your local Philips dealer.

Troubleshooting

This chapter summarises the most common problems you could encounter with the appliance. If you are unable to solve the problem with the information below, contact the Consumer Care Centre in your country.

Problem	Possible solution
Buttons are not responding.	Replace the high-efficiency formaldehyde removal HEPA filter when the filter replacement light started flashing and the appliance has sounded every 30 minutes after approx. 2 weeks. Replace the filter and reset the appliance (see chapter 'Filter replacement') so that the appliance can operate again.
No air comes out of the air outlet	<ul style="list-style-type: none"> • The appliance is not switched on. Put the plug in the wall socket and switch on the appliance. • The air quality is good and the auto mode is activated. In this case, the appliance switches off automatically when the air is clean to save electricity.
The fan speed does not change when the AUTO mode is activated.	When the room becomes dark, the night mode is activated automatically when the appliance is in auto mode. In this case, the fan speed is set to a very low level. If you want to change the fan speed, press the FAN SPEED button one or more times to set the desired fan speed.
The airflow that comes out of the air outlet is significantly weaker than before.	<ul style="list-style-type: none"> • The pre-filter is dirty. Clean the pre-filter (see chapter 'Cleaning'). • You haven't removed all packaging material from the filters. Make sure that you have removed all packaging material.

Problem	Possible solution
The air quality does not improve, even though the appliance has been operating for a long time.	<ul style="list-style-type: none"> One of the filters has not been placed in the appliance. Make sure that all filters are properly installed in the following order, starting with the innermost filter: 1) high-efficiency formaldehyde removal HEPA filter, 2) pre-filter.
	<ul style="list-style-type: none"> The air quality sensor is wet. The humidity level in your room is high and causes condensation. Make sure that the air quality sensor is clean and dry (see chapter 'Cleaning').
The colour of the air quality light ring and the air quality light always stays the same.	<ul style="list-style-type: none"> The air quality sensor is dirty. Clean the air quality sensor (see chapter 'Cleaning').
	<ul style="list-style-type: none"> There is not enough ventilation in the room. Open a window, to improve the air circulation.
I need cleaner air because I have an allergy.	You can change the air quality sensor sensitivity (see chapter 'Using the appliance') to make the appliance clean the air even better.
The appliance is extra loud.	<ul style="list-style-type: none"> Please check if you have removed all the packaging material from the filters. If the appliance is still too loud; you can change the fan speed to a lower fan speed level.
The appliance still indicates that I need to replace a filter, but I already did.	Perhaps you did not press the filter reset button properly. Plug in the appliance, press the on/off button and press the filter reset button with a flat tool.
The appliance stops operating, although the power-on light is still on.	The built in quality sensor has determined that the air quality is good and that the air does not need to be cleaned anymore. When the air quality deteriorates, the appliance starts running at a low fan speed and noise level so that the energy consumption is minimised.
The appliance does not work. Fan speed lights 1 and 2 flash, all other lights are out.	This is a component defect. Contact the Consumer Care Centre in your country (you find its phone number in the worldwide guarantee leaflet). If there is no Consumer Care Centre in your country, go to your local Philips dealer.
The appliance does not work. The air quality light ring flashes blue, all other lights are out.	This is air particle sensor error or an air particle sensor and gas sensor error. Contact the Consumer Care Centre in your country (you find its phone number in the worldwide guarantee leaflet). If there is no Consumer Care Centre in your country, go to your local Philips dealer.
The air quality light ring keeps flashing purple.	This is a gas sensor error. Switch off the appliance and unplug it. Take the appliance to your Philips dealer or an authorised Philips service centre.

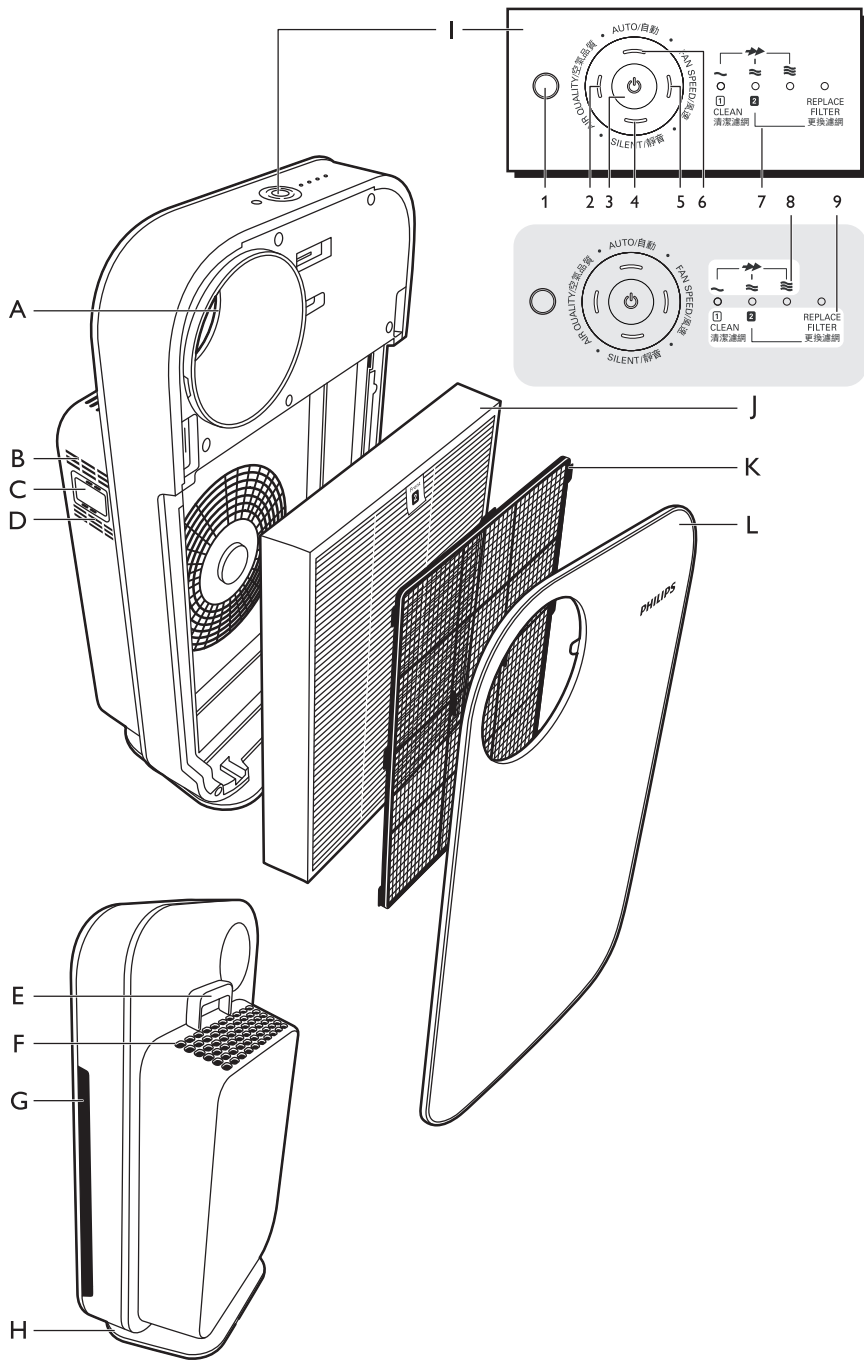

簡介

恭喜您購買本產品並歡迎加入飛利浦！

請至 www.Philips.com/welcome 註冊您的產品，以獲得飛利浦提供的完整支援。

本空氣清淨機採用德國先進的高效率過濾技術，能讓您在家中能呼吸更潔淨的空氣。為了達到最佳效果，請將空氣清淨機放在您最長時間出入的房間內，例如臥室、客廳或兒童房。

汙染來源所在多有。在家裡，可能有來自家具、油漆和吸煙等高濃度甲醛和其他有害氣體。因為這些有害汙染物可能無色無味，進而影響您的健康。飛利浦空氣清淨機能夠迅速有效地濾淨這些有害氣體。此外，還能濾淨會影響健康的 pm2.5 花粉、細菌和空氣微粒。這台空氣清淨機能改善空氣品質，確保您和家人在家呼吸更潔淨的好空氣。

專業可靠的過濾方式

本空氣清淨機採用多功能的複合高效去甲醛HEPA濾網，確保您的家居環境擁有最佳空氣品質：

- 第 1 階段：預過濾網經抗菌物質處理，可捕捉人類頭髮、寵物毛髮等較大粒子。
- 第 2 階段：複合高效去甲醛HEPA濾網能有效濾除灰塵、花粉與大於 20 奈米的超微粒，其中包括病毒與細菌。根據世界衛生組織的出版物指出，禽鳥類與人類的流感病毒以及退伍軍人菌 (Legionella) 大於 20 奈米。

一般說明 (圖 1)

- A 空氣品質環狀指示燈
- B 空氣質量感測器出風口
- C 空氣質量感測器
- D 空氣質量感測器進風口
- E 握柄
- F 出風口
- G 進風口
- H 電源線收納裝置
- I 控制面板
 - 1 夜間模式光線感應器
 - 2 空氣品質 (AIR QUALITY) 開/關按鈕附指示燈
 - 3 電源開/關按鈕附指示燈
 - 4 靜音 (SILENT) 按鈕附指示燈
 - 5 風速 (FAN SPEED) 按鈕附指示燈
 - 6 自動 (AUTO) 按鈕附指示燈
 - 7 風速指示燈 (1、2、3，及超高速)/濾網更換指示燈
 - 8 風速 (FAN SPEED) 指示
 - 9 更換濾網 (REPLACE FILTER) 指示

- J 濾網 2：複合高效去甲醛HEPA濾網 AC4147
- K 濾網 1：預過濾網
- L 正面護板

重要事項

在使用本產品前，請先仔細閱讀本使用手冊，並保留說明以供日後參考。

危險

- 請勿讓水或其他液體，或是易燃清潔劑進入產品內，以避免電擊和 / 或火災。
- 請勿用水或其他液體，或是 (易燃) 清潔劑清潔產品，以避免電擊和 / 或火災。

警示

- 在連接本產品的電源之前，請確認本產品機體底部所標示的電壓與當地的室內電壓是否相同。
- 如果電源線損壞，則必須交由飛利浦、飛利浦授權之服務中心，或是具備相同資格的技師更換，以免發生危險。
- 當插頭、電線或產品本身受損時，請勿使用產品。
- 本產品可供 8 歲以上孩童、身體官能或心智能力退化者，或是經驗與使用知識缺乏者使用，但需要有人在旁監督或適當指示如何安全使用本產品，以及可能遭受的危險。請勿讓兒童把玩本產品。若無人在旁監督，不得讓孩童清潔與維護本產品。
- 請勿在出風口上方或進風口前面放置物品，擋住進出風口。

注意

- 本產品不可用來作為維持良好通風的設備、替代吸塵器清潔，或烹調時用來當作抽油煙機使用。
- 如果供應產品電力的牆上插座接頭不良，產品插頭會發熱。請確定將產品插入接頭良好的牆上插座。
- 請將本產品放置在乾燥平穩的水平面上使用。
- 產品的背面及側面須至少保留 20 公分的間隔距離，頂部則至少保留 30 公分的間隔距離。
- 產品頂部請勿堆放任何物品，請勿坐在產品上。
- 請勿將產品放置在冷氣機正下方，以免冷氣機滴水，造成產品發生水滴凝結的現象。
- 請在開啟產品電源前，先確認所有濾網皆已正確安裝。
- 請僅使用產品專用的飛利浦原廠濾網。請勿使用其他濾網。
- 切勿使用堅硬的物體敲打本產品 (特別是進風口及出風口)。
- 請務必使用產品背面的握柄提起或搬動產品。
- 請勿將手指或任何物體放入出風口。
- 當您使用室內噴霧式驅蟲劑或在充滿油漬、燒香、香煙的火星或化學煙霧的地方時，請勿使用本產品。

- 請勿在氣體用品、加熱裝置或壁爐附近使用本產品。
- 使用完畢後或進行清潔之前，請務必先拔除電源插頭。
- 請勿在溫差變化極大的室內使用本產品，因為室溫差距太大會造成本產品內部凝結水珠。
- 本產品為家用產品，僅限於在正常操作環境下使用。
- 請勿在極為潮濕或周遭溫度很高的環境下使用本產品，例如浴室、廁所或廚房。
- 本產品無法清除一氧化碳 (CO) 或氫氣 (Rn)。發生燃燒意外及危險化學物品意外時，本產品無法當作安全裝置使用。

電磁場 (EMF)

本飛利浦產品符合所有電磁場暴露的相關適用標準和法規。

第一次使用前

放置濾網

第一次使用前，必須先拆下濾網 2 的包裝，然後按照以下步驟把濾網 2 放入產品中。

秘訣：取出或裝入濾網時，將本產品靠牆擺放可獲得較穩定的支撐。

備註：請確定濾網裝入正確的位置。

1 將手指放入兩邊護板的凹處，朝自己的方向輕輕拉出正面護板的頂部。然後將護板底部的扣鉤自產品底部提起。

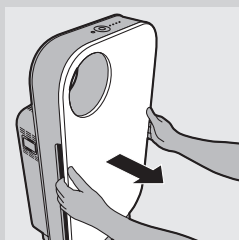

2 抓住預過濾網上兩個凸出部分，朝向自己拉，將其從產品中取出。



3 從包裝材料取出新濾網。

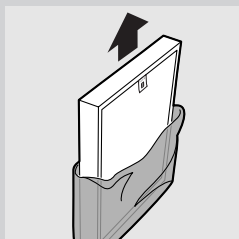

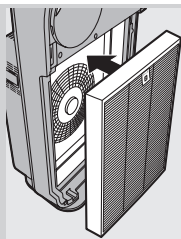

4 將濾網 2 (複合高效去甲醛HEPA濾網) 裝入產品。

備註：請確認有拉片的那一側朝向自己。

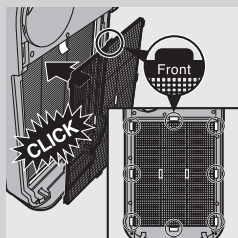

5 將濾網 1 (預過濾網) 裝入產品。

備註：請確認有兩個凸出部分的那一側朝向自己。

備註：請確認所有扣鉤皆已正確裝入產品。

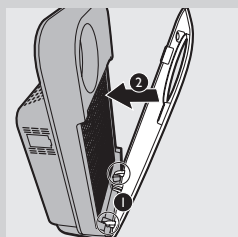

6 若要重新裝入正面護板，先將底部扣鉤裝入產品底部 (1)。然後將護板推入產品機體 (2)。

使用本產品

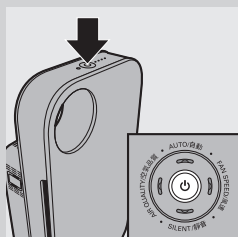

1 將電源插頭插入牆上插座

▶ 所有指示燈亮起兩次，並發出嗶聲，然後指示燈再次熄滅。

2 按下開/關按鈕，開啟產品電源。

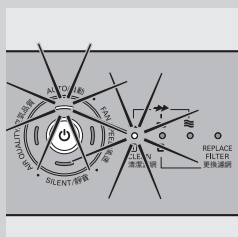

▶ 控制面板上的電源開啟指示燈、自動 (AUTO) 指示燈與空氣品質 (AIR QUALITY) 指示燈會亮起。

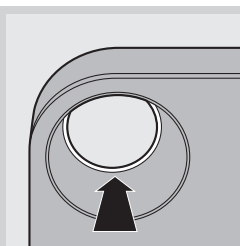

- 空氣品質環狀指示燈會顯示空氣品質。

空氣品質指示

顏色	空氣品質
藍色	非常好
深紫	很棒
紫色	普通
紅色	不良

若要關閉空氣品質環狀指示燈，請按下空氣品質 (AIR QUALITY) 按鈕。

備註：產品電源開啟後，環狀空氣品質指示燈就會自動亮起。

- 本產品會在自動 (AUTO) 模式下自動開始運作。
要關閉產品電源，請再次按下開/關按鈕並拔掉插頭。

備註：當室內濕度等級很高的時候，空氣質量感測器上可能會凝結水滴。如此一來，即使空氣品質良好，控制面板上的空氣品質 (AIR QUALITY) 指示燈及空氣品質環狀指示燈可能會顯示空氣品質不良。在此情況下，自動模式會讓產品風扇高速運轉。您可以清潔空氣質量感測器來解決此問題。如果高濕度期間經常發生水滴凝結問題，建議您使用手動風速設定。

風速指示燈/濾網更換指示燈

- 控制面板右側的指示燈有雙重功能：一是指示風速，二是顯示濾網是否應更換或清潔。
- 指示燈 1 至 2 持續亮起，表示目前風速。
- 指示燈 1 閃爍，表示必須清潔預過濾網。指示燈 2 閃爍，表示必須更換複合高效去甲醛HEPA濾網。
- 當指示燈 2 和更換濾網 (REPLACE FILTER) 指示燈持續閃爍時，必須更換複合高效去甲醛HEPA濾網，且產品已鎖住 (請參閱「濾網更換鎖」單元以取得更多資訊)。

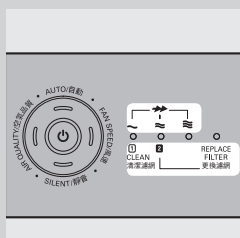

調整空氣質量感測器敏感度

具有某些健康問題 (例如過敏或氣喘) 的人更需要乾淨的空氣。基於這個原因，本產品可讓您調整空氣質量感測器的敏感度。如果您將敏感度的等級設為較高，產品在污染程度較低時就會開始潔淨空氣。

敏感度的等級有 3 種：

- 標準
- 敏感
- 超敏感

污染感測器的設定預設為標準敏感度。空氣質量感測器的敏感度可依照下列方式調整：

- 1** 如果產品已經插電，請將產品的插頭拔下，等待幾分鐘。
- 2** 按下空氣品質 (AIR QUALITY) 按鈕，同時將電源插頭插入電源插座。
 - ▶ 產品會發出嗶聲兩次，其中一個風速指示燈會閃爍，顯示空氣質量感測器目前的敏感度等級。

敏感度等級：

風速指示燈	敏感度等級
~	超敏感
~	敏感
~	標準

- 3** 按下風速 (FAN SPEED) 按鈕，調整空氣質量感測器的敏感度等級。
 - ▶ 其中一個風速指示燈會閃爍，顯示要設定的空氣質量感測器敏感度等級。

- 4** 按下開/關按鈕，關閉產品電源。

備註：若您變更了敏感度等級，產品在開啟電源後，會依照您設定的敏感度等級，自動開始運作。

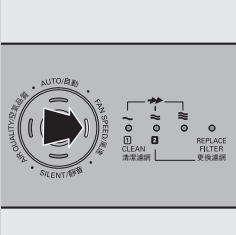
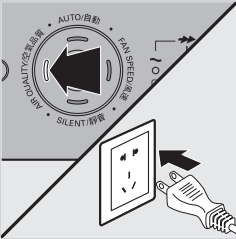

自動模式

產品電源開啟後，內建的空氣質量感測器會自動檢測周遭環境的空氣品質。啟動自動模式後，產品會根據所檢測到的空氣品質，選擇最適當的風速。

1 按下開/關按鈕，開啟產品電源。

2 按下自動 (AUTO) 按鈕，啟動自動模式。

備註：若產品以另一種模式運作，但您想要啟動自動模式時，只要按下自動 (AUTO) 按鈕即可。

▶ 自動 (AUTO) 指示燈會亮起。

▶ 風速 (FAN SPEED) 指示燈會顯示產品是以何種風速運作。

備註：當空氣品質非常良好時，產品會以非常低的風速運作，顯示最低風速設定的風速 (FAN SPEED) 指示燈不會亮起。在此情況下，只有電源開啟指示燈與自動 (AUTO) 指示燈會亮起。

備註：內建空氣質量感測器會檢測空氣品質並自動選擇適當的速度設定，以盡可能確保最佳的室內空氣品質。當空氣乾淨時，產品會停止運作。當空氣品質降低時，產品會以低風速和低噪音等級開始運作，將能源消耗降至最低。

夜間模式

本產品能因應周遭環境協調運作。在自動模式下，產品所處的室內光線變暗時，會自動切換到夜間模式。室內光線變暗長達 3 分鐘，產品的指示燈就會熄滅，風速和噪音等級會降低，耗電量也會降至最低。如果室內光線再度變亮長達 5 分鐘以上，本產品會恢復正常運作。

備註：產品只有在自動模式下運作時，才會啟動夜間模式。

風速

如果不使用自動模式，可選擇所需的風速。

1 按下開/關按鈕，開啟產品電源。

2 按下風速 (FAN SPEED) 按鈕一次或多次，選擇所需的風速。

▶ 相對應的風速指示燈與指示燈上方的指示，會顯示設定的風速 (～、≈、≡ 或 ➔)。

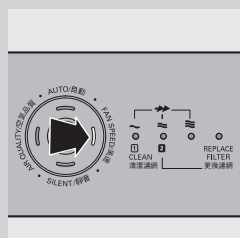
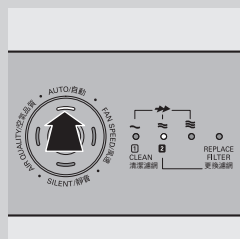
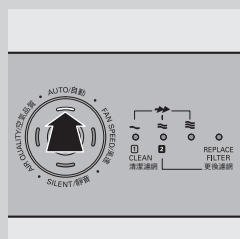

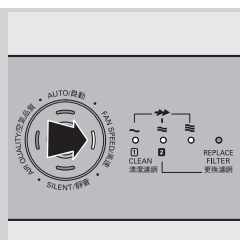

備註：如果室內空氣很髒，需要超強風速時，請選擇超高速 (↗)。指示燈 ~ 至 ≈ 指示燈會亮起。

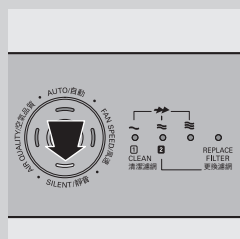

靜音模式

本產品處於靜音模式時，會十分安靜地運作。

1 按下開/關按鈕，開啟產品電源。

2 按下靜音 (SILENT) 按鈕，啟動靜音模式。

▶ 靜音 (SILENT) 指示燈會亮起。

如果想要返回風速 (FAN SPEED) 模式或自動 (AUTO) 模式，只要按下風速 (FAN SPEED) 按鈕或自動 (AUTO) 按鈕即可。

清潔

進行清潔前，請務必先拔離電源插頭。

切勿讓產品浸入水或其他液體中。

切勿使用漂白劑或酒精等刺激性或易燃洗劑清潔產品的任何部分。

只有預過濾網可水洗。

產品機體

定期清理機體內部與外殼，可避免內部與外殼累積灰塵。

1 請使用柔軟的乾布擦拭產品的機體。

2 請使用柔軟的乾布清潔進風口及出風口。

預過濾網

預過濾網可水洗並可用吸塵器清潔。

- 第一個濾網更換指示燈閃爍時，請清洗預過濾網，確保產品發揮最佳效果。

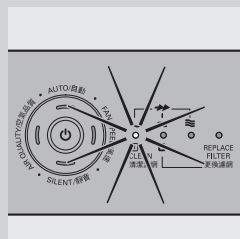

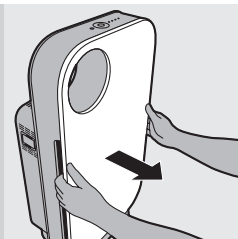

- 1** 將手指放入兩邊護板的凹處，朝自己的方向輕輕拉出正面護板的頂部。然後將護板底部的扣鉤自產品底部提起。



- 2** 若要取出預過濾網，抓住濾網上兩個凸出部分，朝向自己拉出。

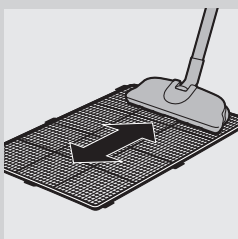

- 3** 使用吸塵器去除灰塵來清潔預過濾網。

秘訣：也可以將預過濾網置於水龍頭下清洗。如果預過濾網很髒，請使用軟刷來清除灰塵。在這種情況下，請先確認預過濾網已完全乾燥，再裝回空氣清淨機。如果預過濾網未乾，細菌可能會在其中滋生，造成其使用壽命縮短。

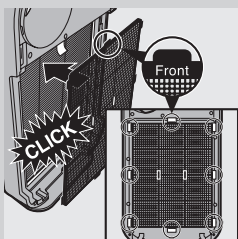

- 4** 將預過濾網裝回產品中。將所有扣鉤正確扣入產品。

備註：請確認有兩個凸出部分的那一側朝向自己。

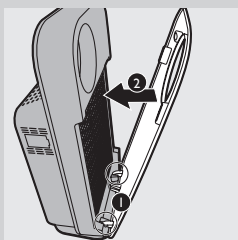

- 5** 若要重新裝入正面護板，先將底部扣鉤裝入產品底部 (1)。然後將護板推入產品機體 (2)。

空氣質量感測器

每 2 個月清理空氣質量感測器，可確保產品發揮最佳效果。如果在佈滿灰塵的環境中使用產品，就要更常進行清潔。

備註：當室內濕度等級很高的時候，空氣質量感測器上可能會凝結水滴。如此一來，即使空氣品質良好，控制面板上的空氣品質 (AIR QUALITY) 指示燈及空氣品質環狀指示燈可能會顯示空氣品質不良。在此情況下，您必須清潔空氣質量感測器，或使用手動風速設定。

1 請使用軟刷來清潔空氣質量感測器的進風口及出風口。

2 取下空氣質量感測器的護蓋。

3 請使用略濕的棉棒，清潔空氣質量感測器、進風口和出風口。

4 使用乾的棉棒擦乾。

5 重新裝入空氣質量感測器的護蓋。

更換濾網

保養濾網

本產品配備健康空氣保護鎖功能，可確保濾網在產品運作時處於最佳狀態。當其中一個濾網阻塞而必須清潔或更換時，對應的濾網更換指示燈會開始閃爍。若不更換複合高效去甲醛 HEPA 濾網，產品會停止運作，然後鎖定。

產品鎖定後，對應濾網的濾網更換指示燈會持續亮起。

備註：僅在濾網更換指示燈閃爍時才更換濾網。若在濾網更換指示燈開始閃爍之前就更換濾網，使用壽命計時器不會重設，而會持續計算原濾網的使用壽命。結果會造成濾網更換指示燈太早開始閃爍。

濾網更換指示燈

濾網更換指示燈會顯示哪一個濾網必須清潔或更換。

- 濾網更換指示燈 1 閃爍：必須清潔濾網 1 (預過濾網)。如需進一步說明，請參閱「清潔」單元。
- 濾網更換指示燈 2 閃爍：必須更換複合高效去甲醛HEPA濾網。

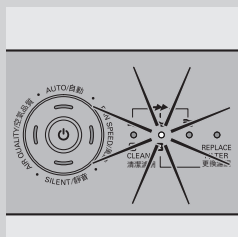
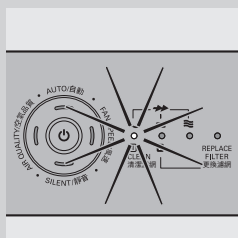

健康空氣智能鎖

如果不即時更換濾網，本產品會在濾網更換指示燈開始閃爍約 2 週後停止運作。產品鎖定後，必須更換新濾網，並按下重設按鈕才能恢復運作。

備註：當濾網更換指示燈 2 以及控制面板上的更換濾網 (REPLACE FILTER) 指示燈持續亮起時，產品已鎖住 (請參閱此單元中的「保養濾網」一節，以取得更多資訊)。

產品會在多久時間後鎖住，則根據濾網更換警示燈亮起後的運作時間與所選的速度等級而定。

本產品進入鎖定狀態的前 1 天，每隔 30 分鐘會發出嗶聲，提示有濾網需要更換。

本產品鎖住後，按下任一按鈕，都會聽見嗶聲。您可以按下開/關按鈕以關閉產品電源。

如果產品已鎖住：

- 1 檢查哪個濾網需要更換 (請參閱「濾網更換指示燈」一節)。
- 2 關閉產品電源，並拔除插頭。
- 3 更換對應的濾網 (請參閱「更換濾網」一節)。

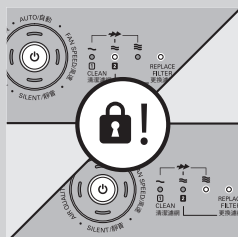

更換濾網

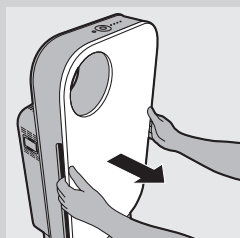

秘訣：取出或裝入濾網時，將本產品靠牆擺放可獲得較穩定的支撐。

1 關閉產品電源，並拔除插頭。

2 將手指放入兩邊護板的凹處，朝自己的方向輕輕拉出正面護板的頂部。然後將護板底部的扣鉤自產品底部提起。



3 若要取出濾網 1 (即預過濾網)，抓住濾網上兩個凸出部分，朝自己拉出。

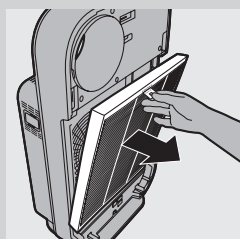

4 若要取出濾網 2 (複合高效去甲醛HEPA濾網)，抓住濾網拉片，朝自己拉出。

5 丟棄已用的濾網，拆開新濾網的包裝。

備註：請勿碰觸有皺摺的濾網表面或嗅聞濾網，因為它收集了空氣中的污染物。

備註：丟棄舊濾網後務必洗手。

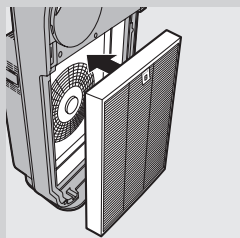

6 將濾網 2 (複合高效去甲醛HEPA濾網) 裝回產品。

備註：請確認有拉片的那一側朝向自己。

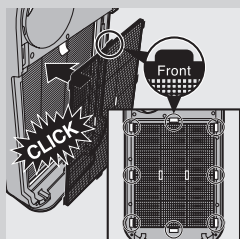

7 將濾網 1 (預過濾網) 裝回產品。

備註：請確認有兩個凸出部分的那一側朝向自己。

備註：請確認所有扣鉤皆已正確裝入產品。

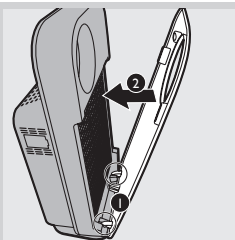

8 若要重新裝入正面護板，先將底部扣鉤裝入產品底部 (1)。然後將護板推入產品機體 (2)。

9 請將插頭插入牆上插座，然後再度開啟產品電源。

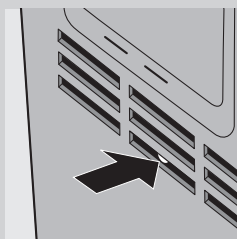

10 利用細長的工具，按下濾網重設按鈕。

備註：清潔濾網 1 (預過濾網) 之後，不需按下濾網重設按鈕。

備註：若在濾網更換指示燈開始閃爍之前即更換濾網，就無法重設本產品。

備註：如果未插插頭或未開啟電源，您便無法重設本產品。

收納

請將電源線纏繞在產品底部的電源線收納裝置上，加以收納。

配件

我們提供下列型號的新濾網：

濾網

濾網 2：複合高效去甲醛HEPA濾網

型號

AC4147

環境保護

- 請勿在本產品使用壽命結束後當作一般家庭垃圾廢棄，應交給官方回收站作循環再用。這樣做有助保護環境。
- 請遵守您的國家/地區回收電器和電子產品的法則。正確處理廢棄產品有助避免對環境和人體造成負面影響。

保固與服務

若您需要相關資訊，或是有任何問題，請造訪飛利浦網站：
www.philips.com，或連絡您所在國家/地區的飛利浦客戶服務中心
 (您可在全球保證書上找到電話號碼)。若當地沒有客戶服務中心，
 請洽詢當地的飛利浦經銷商。

疑難排解

本單元概述您使用本產品時最常遇到的問題。如果您無法利用以下資訊解決您遇到的問題，請聯絡您所在國家/地區的客戶服務中心。

問題	可能的解決方法
按鈕沒有回應。	當濾網更換指示燈開始閃爍，且在約 2 週後產品開始每隔 30 分鐘發出嗶聲時，更換複合高效去甲醛HEPA濾網。更換濾網並重設本產品(請參閱「更換濾網」單元)，才可再度運作。
出風口沒有空氣流出	<ul style="list-style-type: none"> 您的產品沒有開啟電源。將插頭插入牆上插座，然後開啟產品電源。 空氣品質良好，且自動模式啟動。在此情況下，產品會在空氣乾淨時自動關閉電源，以節省電力。
自動模式啟動時，風速沒有改變。	室內光線變暗時，若產品處於自動模式，夜間模式會自動啟動。在此情況下，風速會設得很低。如果想要更改風速，請按下風速 (FAN SPEED) 按鈕一次或多次，設定所需的風速。
出風口流出的風速比之前慢很多。	<ul style="list-style-type: none"> 預過濾網髒污。清潔預過濾網(請參閱「清潔」單元)。 您尚未拆下濾網的所有包裝材料。請確認已拆下所有包裝材料。
即使本產品已經長時間運作，空氣品質仍未獲得改善。	<ul style="list-style-type: none"> 其中一個濾網尚未裝入產品中。請確認所有濾網都已按照下列順序正確安裝，濾網從內至外分別為：(1) 複合高效去甲醛HEPA濾網；(2) 預過濾網。 空氣質量感測器潮濕。室內的濕度等級很高，造成水珠凝結。請確認空氣質量感測器乾淨且乾燥(請參閱「清潔」單元)。
空氣品質環狀指示燈及空氣品質指示燈的顏色一直維持不變。	<ul style="list-style-type: none"> 空氣質量感測器髒污。清潔空氣質量感測器(請參閱「清潔」單元) 室內空氣不夠流通。請開窗，促進空氣對流。
我會過敏，需要更乾淨的空氣。	您可以變更空氣質量感測器敏感度(請參閱「使用本產品」單元)，讓本產品把空氣清潔得更加徹底。
產品噪音很大。	<ul style="list-style-type: none"> 請檢查是否已拆下濾網的所有包裝材料。 如果產品噪音仍然很大，可將風速變更為較低的速度等級。
產品不斷要求更換濾網，但濾網已經更換了。	您可能未確實按下濾網重設按鈕。請為本產品插上電源，按下開/關按鈕，然後用扁平工具按下濾網重設按鈕。
產品停止運作，而電源指示燈仍亮起。	內建空氣質量感測器判定空氣品質良好，因此不再需要清潔空氣。當空氣品質降低時，產品會以低風速和低噪音等級開始運作，將能源消耗降至最低。
本產品無法運作。風速指示燈 1 和 2 閃爍，其他所有指示燈均熄滅。	此為元件故障。請聯絡您所在國家/地區的客戶服務中心(您可在全球保證書上找到電話號碼)。若當地沒有客戶服務中心，請洽詢當地的飛利浦經銷商。

問題

可能的解決方法

本產品無法運作。空氣品質環狀指示燈閃爍藍光，其他所有指示燈均熄滅。

此為空氣微粒感測器錯誤或空氣微粒感測器與空氣感測器錯誤。請聯絡您所在國家/地區的客戶服務中心 (您可在全球保證書上找到電話號碼)。若當地沒有客戶服務中心，請洽詢當地的飛利浦經銷商。

空氣品質環狀指示燈持續閃爍紫光。

此為空氣感測器錯誤。關閉產品電源，並拔除插頭。將本產品送到飛利浦經銷商或飛利浦授權之服務中心。

設備名稱: 飛利浦空氣清淨機, 型號 (型式) : AC4076/80 Equipment name Type designation (Type)							
單元 Unit	限用物質及其化學符號 Restricted substances and its chemical symbols						
	鉛 Lead (Pb)	汞 Mercury (Hg)	鎘 Cadmium (Cd)	六價鉻 Hexavalent chromium (Cr ⁶⁺)	多溴聯苯 Polybrominated biphenyl ethers (PBB)	多溴二苯醚 Polybrominated diphenyl ethers (PBDE)	
電源線組	—	○	○	○	○	○	
塑膠外殼	○	○	○	○	○	○	
電源板組件	—	○	○	○	○	○	
電動機	—	○	○	○	○	○	
主電路板組件	—	○	○	○	○	○	

備考1: “超出0.1 wt %” 及 “超出0.01 wt %” 係指限用物質之百分比含量超出百分比含量基準值。

Note 1: “Exceeding 0.1 wt %” and “exceeding 0.01 wt %” indicate that the percentage content of the restricted substance exceeds the reference percentage value of presence condition.

備考2: “○” 係指該項限用物質之百分比含量未超出百分比含量基準值。

Note 2: “○” indicates that the percentage content of the restricted substance does not exceed the percentage of reference value of presence.

備考3: “—” 係指該項限用物質為排除項目。

Note 3: The “—” indicates that the restricted substance corresponds to the exemption.

