

PHILIPS

AquaTrio Cordless

双滚刷无线智能洗地机

7000 系列

XW7110

微信扫码
发现更多会员专属权益



飞利浦双滚刷无线智能
洗地机7000系列



English 5
简体中文 8



1

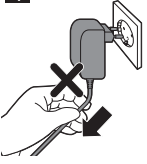

2

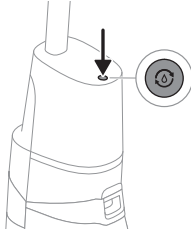

3



4



5

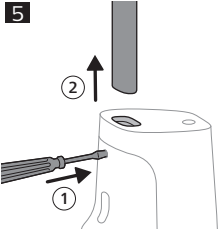

6

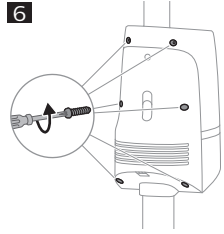

7

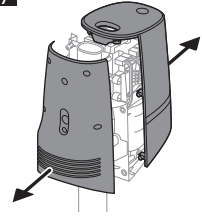

8

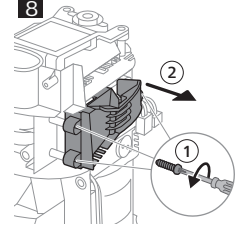

9

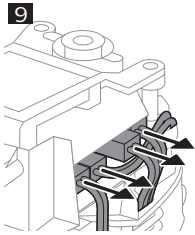

10

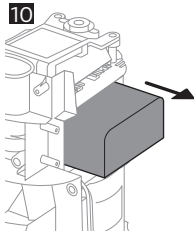

Important safety information

Read this important information carefully before you use the appliance and its accessories and save it for future reference. The accessories supplied may vary for different products.

Danger

- Never vacuum up flammable substances, and do not vacuum up ashes until they are cold.
- Never immerse the appliance or the adapter in water or any other liquid, nor rinse it under the tap.

Warning

- Check if the voltage indicated on the adapter corresponds to the local mains voltage before you connect the appliance.
- Always check the appliance before you use it. Do not use the appliance or the adapter if it is damaged. Always replace a damaged part with one of the original type.
- The adapter contains a transformer. Do not cut off the adapter to replace it with another plug, as this causes a hazardous situation.
- Philips has only tested this appliance with XV1792 Philips Floor Cleaner. Add a maximum of 15 ml to the clean water tank. Other detergents may lead to excessive foaming, which reduces performance and may cause the appliance to malfunction. XV1792 Philips Floor Cleaner is available in selected markets. When using any other suitable liquid floor cleaner, add a maximum of 15 ml to the clean water tank.
- This appliance is not intended for use by persons (including children) with reduced physical, sensory or mental capabilities, or lack of experience and knowledge, unless they have been given supervision or instruction concerning use of the appliance by a person responsible for their safety.
- Children should be supervised to ensure that they do not play with the appliance.
- The plug must be removed from the socket-outlet before cleaning or maintaining the appliance.
- Unplug the adapter if you are not going to use the appliance for some time.
- When storing the appliance for more than a month (without usage or charging), make sure that the battery is charged to at least 50%. Storing the appliance with an empty battery may lead to irreversible damage to the battery.
- Do not let the motorized nozzle move over the mains cords of other appliances or other cables as this may cause a hazard.
- Keep loose clothing, hair and body parts away from the motorized brushes.
- Do not cover or block the ventilation openings when the appliance is operating.
- Take the appliance to an authorized Philips service center when you can no longer recharge it or when it runs out of power quickly.
- If the appliance is damaged, do not try to charge it.
- This appliance is designed for household use only. Do not use this appliance to vacuum up building waste, cement dust, ashes, fine sand, lime and similar substances. Always clean all parts of the appliance as shown in the user manual. Do not clean any parts with water and/or cleaning agents if this is not specifically shown in the user manual.
- This product contains a rechargeable battery. The battery may only be replaced by a qualified service engineer.

Caution

- Do not hold the appliance upside down as this will cause water to leak through the air openings of the appliance. If this does happen, the appliance can still function safely.
- During charging, the adapter becomes warm to the touch. This is normal.
- Do not plug in, unplug or operate the appliance with wet hands.

6 English

- Do not unplug the appliance by pulling at the cord. Always unplug by pulling the small plug out of the appliance and the adapter out of the wall socket (Fig. 1).
- Always switch off the appliance after use and before you charge it.
- Never block the exhaust air openings at the back of the appliance during use.
- Do not clean the removable parts of the appliance in the dishwasher. These parts are not dishwasher-proof.
- Never use any accessories or parts from other manufacturers or that Philips does not specifically recommend. If you use such accessories or parts, your warranty becomes invalid.
- Make sure that the appliance is installed with the after-clean and storage station assembled according to the instructions in the user manual.
- In rare cases, when the appliance performs the AUTOCLEAN cycle, it may happen that the appliance suddenly stops working in an environment with electrostatic discharge. In this case you can restart the AUTOCLEAN function by pressing the AUTOCLEAN button (Fig. 2). It might be necessary to press the on/off button first. This will activate the display.
- As this appliance uses water to clean, the floor may remain wet and slippery for a while (Fig. 3).
- Do not leave the appliance unattended when the AquaSpin nozzle is unlocked or when the appliance is switched on.

Battery safety instructions

- Only use this product for its intended purpose and follow the general and battery safety instructions as described in this user manual. Any misuse can cause electric shock, burns, fire and other hazards or injuries.
- **Warning:** Only charge the appliance with the adapter supplied. Only use 34V adapter S036-1A340100HE. The corresponding adapter number can be found on the adapter.
- Charge, use and store the product at a temperature between 5 °C and 35 °C.
- Do not expose the device to direct sunlight or to high temperatures (near hot stoves, in microwave ovens or on induction cookers). Batteries may explode if overheated.
- If the product becomes abnormally hot or smelly, changes color or if charging takes longer than usual, stop using and charging the product and contact Philips.
- Do not place products and their batteries in microwave ovens or on induction cookers.
- When you handle batteries, make sure that your hands, the product and the batteries are dry.
- To prevent batteries from heating up or releasing toxic or hazardous substances, do not modify, pierce or damage products and batteries and do not disassemble, short-circuit, overcharge or reverse charge batteries.
- To avoid accidental short-circuiting of batteries after removal, do not let battery terminals come into contact with metal objects (e.g. coins, hairpins, rings). Do not wrap batteries in aluminum foil. Tape battery terminals or put batteries in a plastic bag before you discard them.
- If batteries are damaged or leaking, avoid contact with the skin or eyes. If this occurs, immediately rinse well with water and seek medical care.

Removal of built-in rechargeable battery

Remove the rechargeable battery before discarding the appliance. If the battery is removed by a third party, this can only be done by a qualified service engineer. Before removing the battery, make sure that the appliance is disconnected from the wall socket and that the battery is completely empty.

Take any necessary safety precautions when you handle tools to open the appliance and when you dispose of the rechargeable battery.

When you handle batteries, make sure that your hands, the product and the batteries are dry.

To avoid accidental short-circuiting of batteries after removal, do not let battery terminals come into contact with metal objects (e.g. coins, hairpins, rings). Do not wrap batteries in aluminum foil. Tape battery terminals or put batteries in a plastic bag before you discard them.

- 1 Disconnect the appliance from the wall socket and let it run until the motor stops.
- 2 Remove the grip handle (Fig. 5), clean water tank and dirty water tank from the appliance.
- 3 Remove the six screws from the back of the main body (Fig. 6).
- 4 Pull the front and back cover from the main body (Fig. 7).
- 5 Remove the three cover screws from the right side of the main body and remove the battery cover (Fig. 8).
- 6 Disconnect all four connectors from the printed circuit board (Fig. 9).
- 7 Remove the battery from the appliance and dispose of it according to the rules (Fig. 10).

Electromagnetic fields (EMF)

This appliance complies with the applicable standards and regulations regarding exposure to electromagnetic fields.

Ordering accessories

To buy accessories or spare parts, visit www.philips.com/parts-and-accessories or go to your Philips dealer. You can also contact the Philips Consumer Care Center in your country.

Warranty and support

Versuni offers a two-year warranty after purchase on this product. This warranty is not valid if a defect is due to incorrect use or poor maintenance. Our warranty does not affect your rights under law as a consumer. For more information or for invoking the warranty, please visit our website www.philips.com/support.

Recycling

- This symbol means that electrical products and batteries shall not be disposed of with normal household waste (Fig. 4).
- Follow your country's rules for the separate collection of electrical products and batteries.

重要安全信息

使用本产品及其附件之前，请仔细阅读本重要信息，并妥善保管以供日后参考。随附的附件可能因产品而异。

危险

- 切勿吸入易燃物质，也不要吸入未冷却的灰烬。
- 切勿将本产品或适配器浸入水或其他任何液体中，也不要将它们放在水龙头下冲洗。

警告

- 在将本产品连接电源前，务必检查当地的电压是否与电源适配器所标电压一致。
- 使用前，请务必检查产品。如果产品或适配器受损，请停止使用。请务必用原装型号更换损坏的部件。
- 适配器中包含一个变压器。请勿剪下适配器更换其他插头，否则将导致严重后果。
- 飞利浦仅使用 XV1792 飞利浦地板清洁剂对本产品进行了测试。最多只能在净水箱中加入 15 毫升。其他清洁剂可能会产生大量泡沫，从而降低性能，并可能导致产品发生故障。XV1792 飞利浦地板清洁剂在部分市场有售。在使用任何其他合适的液体地板清洁剂时，最多只能在净水箱中加入 15 毫升。
- 产品不建议由有肢体、感官或精神能力缺陷或缺乏使用经验和知识的人（包括儿童）使用，除非有负责他们安全的人对他们进行与产品使用有关的监督或指导。
- 请照顾好儿童，本产品不能用于玩耍。
- 清洁或维护产品之前，必须先从插座拔掉插头。
- 如果在一段时期内不使用本产品，请拔下适配器插头。
- 将产品存放超过一个月（不使用或不充电）时，请确保电池至少有 50% 的电量。如果在电池电量耗尽的情况下存放产品，可能会对电池造成不可逆的损坏。
- 请勿在其它产品的电源线或其它线缆上移动电动吸嘴，否则可能会引发危险。
- 确保宽松的衣服、毛发和身体部位远离电动刷。
- 产品运行时，切勿覆盖或堵塞通风口。
- 当充电电池无法继续充电或耗电很快时，请将产品送至授权的飞利浦服务中心。
- 如果产品损坏，切勿尝试为其充电。
- 本产品仅限于家用。切勿使用本产品清理建筑垃圾、水泥灰、灰烬、细沙、石灰和类似的物质。务必按照用户手册中的说明清洁本产品的所有部件。请勿使用水和/或清洁剂清洁任何部件（如果用户手册中未特别说明）。
- 本产品包含充电电池。只有具备资格的服务工程师才能更换电池。

注意

- 请勿将本产品倒置，否则会导致产品通风口处漏水。即使漏水，产品仍可以安全运行。
- 充电期间，适配器会有微热。这是正常现象。
- 切勿用湿手插入、拔下或操作产品。
- 切勿以拉扯电源线的方式拔下产品插头。拔下插头时，请务必将小插头从产品中拔出，并将适配器从电源插座上拔下(图 1)。
- 使用后和充电前，请务必关闭产品。
- 使用时切勿堵塞产品背后的排气口。
- 请勿将本产品的任何可拆卸部件放入洗碗机中清洗。这些部件不可在洗碗机中清洗。
- 切勿使用其他制造商生产的或未经飞利浦特别推荐的任何配件或部件。如果您使用了此类配件或部件，本产品的保修将会失效。
- 在安装本产品时，确保按照用户手册中的说明将清洁后装置和收纳座进行组装。
- 在极少数情况下，当产品执行 AUTOCLEAN 周期时，在有静电放电的环境中，产品可能会突然停止工作。此时，可以按下 AUTOCLEAN 按钮，重启 AUTOCLEAN 功能(图 2)。首先可能需要按下开/关按钮，以激活显示屏。
- 因本产品使用水来清洁，清洁后的一段时间内(图 3)地板上会有些湿和打滑。
- AquaSpin 吸嘴处于解锁状态或产品打开时，本产品必须有人看管。

电池安全说明

- 仅可将本产品用于原定用途，并应遵循本用户手册中的一般说明和电池安全说明。如有滥用，可能会导致电击、烧伤、火灾和其他危害或伤害。
- **警告：**只能用随附的适配器为本产品充电。请仅使用 34 伏适配器 S036-1A340100HE。可以在适配器上找到相应的适配器编号。
- 充电、使用和存放本产品的温度应介于 5 ° C 至 35 ° C 之间。
- 请勿将设备暴露在直射的阳光下或高温下（靠近热炉、在微波炉中或在电磁炉上）。如果过热，电池可能会爆炸。
- 如果产品异常发热或发出异味、变色或充电时间比平时长，请停止使用并停止为其充电，并联系飞利浦。
- 切勿将产品及其电池放置在微波炉中或电磁炉上。
- 处理电池时，请确保您的双手、产品和电池都是干燥的。
- 为防止电池发热或释放有毒有害物质，切勿改装、刺穿或损坏产品和电池，切勿拆卸电池、使电池短路、过度充电或反向充电。
- 为避免电池拆卸后发生意外短路，切勿让电池端子接触金属物体（例如硬币、发夹、戒指）。切勿用铝箔包裹电池。在丢弃之前，请用胶带将电池端子粘住或将电池放在塑料袋中。

10 简体中文

- 如果电池损坏或出现泄漏，请避免与皮肤或眼睛接触。如果不慎接触，请立即用清水冲洗并就医。

取出内置充电电池

在丢弃产品之前请取出充电电池。如果由第三方取出电池，仅可由具备资格的服务工程师完成。取出电池之前，请确保产品与电源插座断开连接并且电池电量已完全耗尽。

当您使用工具打开产品时以及在您弃置充电电池时，请采取必要的安全保护措施。

处理电池时，请确保您的双手、产品和电池都是干燥的。

为避免电池拆卸后发生意外短路，切勿让电池端子接触金属物体（例如硬币、发夹、戒指）。切勿用铝箔包裹电池。在丢弃之前，请用胶带将电池端子粘住或将电池放在塑料袋中。

- 1 断开本产品的电源连接并让其继续运行，直至电机停止转动。
- 2 从产品上卸下手柄、净水箱和污水箱 (图 5)。
- 3 卸下机体背面的六个螺丝 (图 6)。
- 4 拉开机体的前盖和后盖 (图 7)。
- 5 卸下机体右侧的三个盖用螺丝，然后卸下电池盖 (图 8)。
- 6 断开印刷电路板上的所有四个连接器 (图 9)。
- 7 从产品中取出电池并按照规定处理电池 (图 10)。

电磁场 (EMF)

本产品符合有关暴露于电磁场的适用标准和法规。

订购配件

如需购买附件或备件，请访问 www.philips.com/parts-and-accessories 或联系您的飞利浦经销商。您还可以与所在国家/地区的飞利浦客户服务中心联系。

保修和支持

购买本产品后，Versuni 将为其提供两年的保修。如因错误使用或保养不当造成缺陷，则本保修无效。我们提供的保修不会影响您作为消费者的合法权益。如需了解更多信息或援引保修，请访问我们的网站 www.philips.com/support。

回收

- 此符号表示电器产品和电池不能与一般的生活垃圾一同弃置(图 4)。
- 请遵守您所在国家/地区有关分类回收电器产品和电池的规定。

产品中有害物质的名称及含量						
部件名称	有害物质					
	铅 (Pb)	汞 (Hg)	镉 (Cd)	六价铬 (Cr (VI))	多溴联苯 (PBB)	多溴二苯醚 (PBDE)
充电式吸尘器	X	○	○	○	○	○
电源适配器	X	○	○	○	○	○

本表格依据 SJ/T 11364 的规定编制。
 ○: 表示该有害物质在该部件所有均质材料中的含量均在 GB/T 26572 规定的限量要求以下。
 X: 表示该有害物质至少在该部件的某一均质材料中的含量超出 GB/T 26572 规定的限量要求。

- 该表格中所显示的“有害物质”在产品正常使用情况下不会对人身和环境产生任何伤害。
- 该表格中所显示的“有害物质”及其存在的部件向消费者和回收处理从业者提供相关物质的存在信息，有助于产品废弃时的妥善处理。

PHILIPS

产品：双滚刷无线智能洗地机
(带吸水式吸尘器功能)

型号：XW7110 

额定电压：25.2V 

额定功率：175W

充电电压：34V 

充电电流：1.0A

电源适配器额定输入：100-240V~
50/60Hz 1.0A

生产日期：请见产品本体
产地：中国江苏苏州

范颂尼（中国）投资有限公司
上海市静安区灵石路728弄20号201室
全国顾客服务热线：4008 203 160

本产品根据国标 GB4706.1-2005,
GB4706.7-2014, GB4343.1-2018及
GB17625.1-2012制造

_ |

| _

_ |

inside back page

| _

© 2023 Versuni Holding B.V.

All rights reserved

PHILIPS and the Philips Shield Emblem are registered trademarks of Koninklijke Philips N.V. and are used under license.

This product has been manufactured by and is sold under the responsibility of Versuni Holding B.V., and Versuni Holding B.V. is the warrantor in relation to this product.

保留所有权利

PHILIPS 和 Philips 盾徽 是 Koninklijke Philips N.V. 的注册商标，并在许可下使用。

本产品由 Versuni Holding B.V. 制造并负责销售，Versuni Holding B.V. 是本产品的担保人。

642001001228 (07/2023)

> 75% 循环再造纸

保留备用



>75 % recycled paper
>75 % papier recyclé