

Display panel

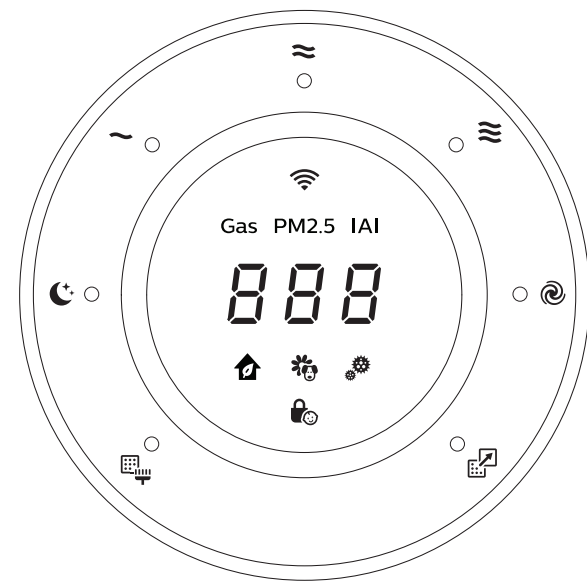

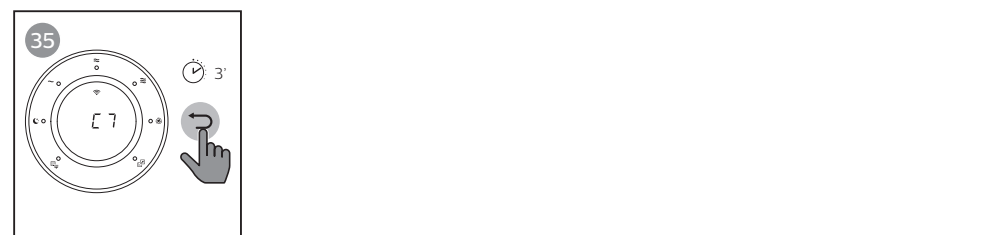
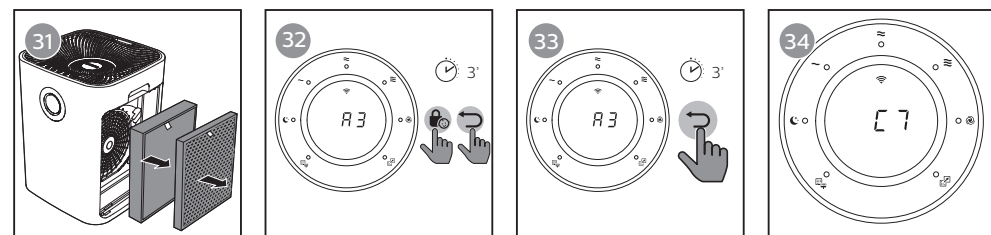
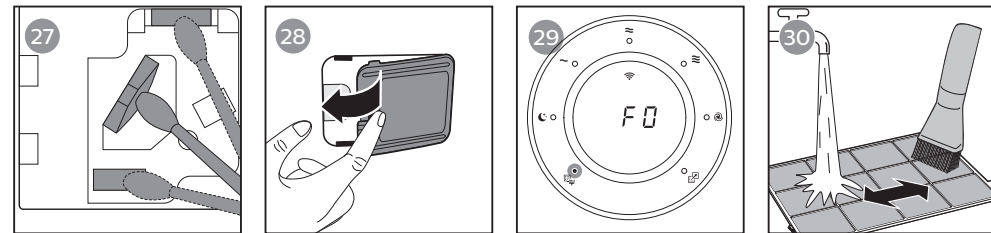
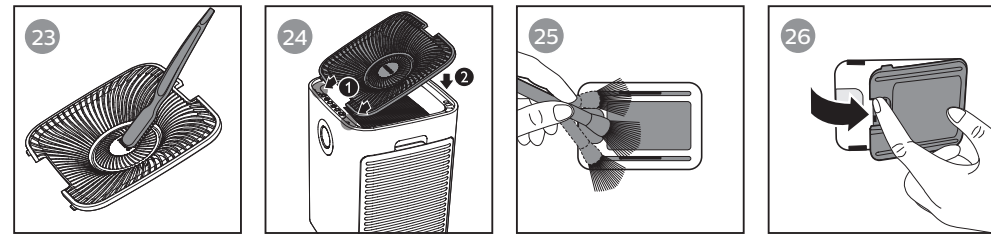
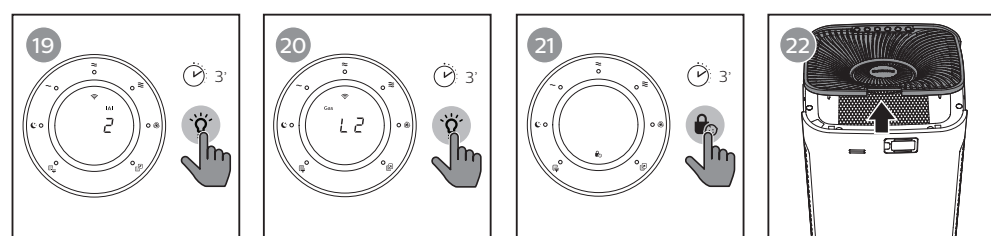
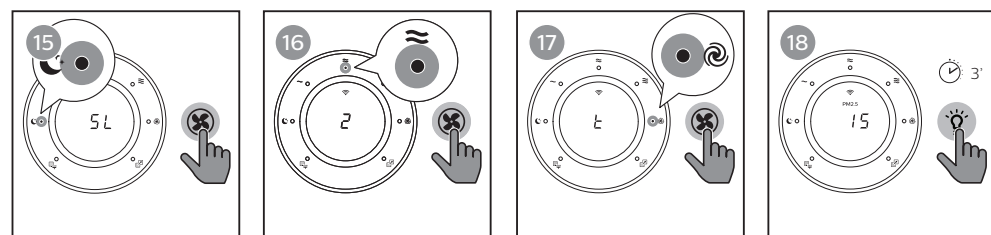
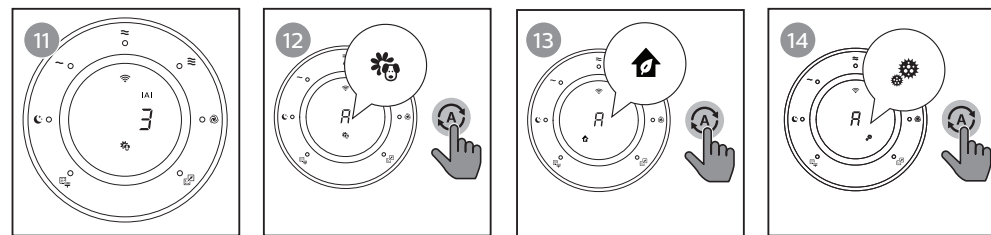
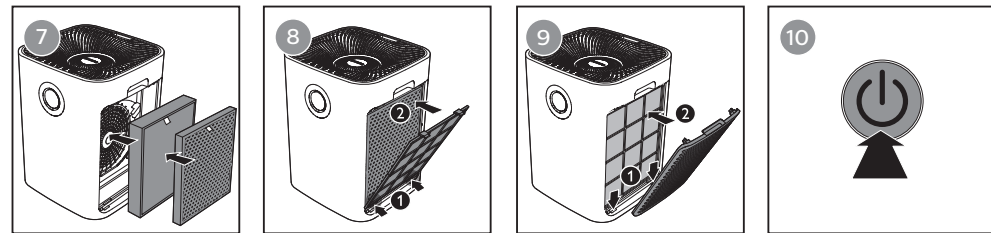
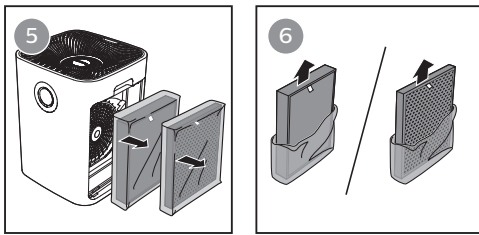
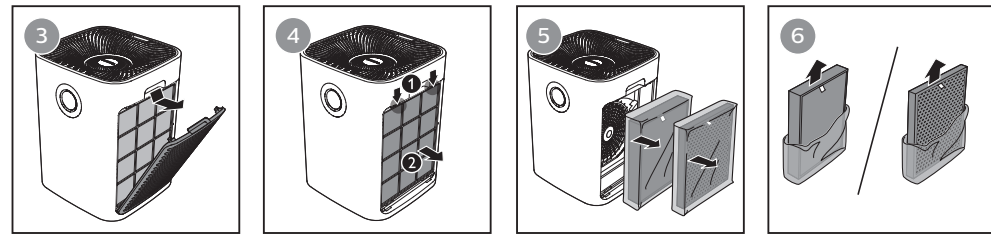

Contents

1 Important	2
Safety	2
2 Your air purifier	5
Product overview (fig. ①)	5
Controls overview (fig. ②)	5
3 Getting started	6
Installing the filters	6
Wi-Fi connection	6
4 Using the air purifier	7
Understanding the air quality light	7
Turning on and off	8
Changing the Auto mode setting	8
Changing the fan speed	9
Using the light on/off function	9
Switching the display indicator	9
Setting the child lock	10
5 Cleaning	10
Cleaning the body of the air purifier	10
Cleaning the air outlet cover	11
Cleaning the air quality sensor	11
Cleaning the pre-filter	11
6 Replacing the filters	12
Filter replacement indicator	12
Replacing the filters	12
Filter reset	13

7 Storage	14
8 Troubleshooting	15
9 Guarantee and service	17
Order parts or accessories	17
10 Notices	17
Electromagnetic fields (EMF)	17
Recycling	18
Notice	18

Environmental friendly paper used. Thanks for your contribution to save trees.

1 Important

Safety

Read this user manual carefully before you use the appliance, and save it for future reference.

Danger

- Do not let water or any other liquid or flammable detergent enter the appliance to avoid electric shock and/or a fire hazard.
- Do not clean the appliance with water, any other liquid, or a (flammable) detergent to avoid electric shock and/or a fire hazard.
- Do not spray any flammable materials such as insecticides or fragrance around the appliance.

Warning

- Check if the voltage indicated on the appliance corresponds to the local power voltage before you connect the appliance.

- If the power cord is damaged, you must have it replaced by Philips, a service center authorized by Philips, or similarly qualified persons in order to avoid a hazard.
- Do not use the appliance if the plug, the power cord, or the appliance itself is damaged.
- This appliance can be used by children aged from 8 years and above and persons with reduced physical, sensory or mental capabilities or lack of experience and knowledge if they have been given supervision or instruction concerning use of the appliance in a safe way and understand the hazards involved. Child shall not play with the appliance. Cleaning and maintenance shall not be made by children without supervision.
- Do not block the air inlet and outlet, e.g. by placing items on the air outlet or in front of the air inlet.

- Make sure that foreign objects do not fall into the appliance through the air outlet.
- Standard WiFi interface based on 802.11b/g/n at 2.4 GHz with a maximum output power of 31.62 mW EIRP.

Caution

- This appliance is not a substitute for proper ventilation, regular vacuum cleaning, or use of an extractor hood or fan while cooking.
- If the power socket used to power the appliance has poor connections, the plug of the appliance becomes hot. Make sure that you plug the appliance into a properly connected power socket.
- Always place and use the appliance on a dry, stable, level, and horizontal surface.
- Leave at least 20cm free space behind and on both sides of the appliance and leave at least 30cm free space above the appliance.
- Do not place anything on top of the appliance.
- Do not sit or stand on the appliance. Sitting or standing on the appliance may lead to potential injury.
- Do not place the appliance directly below an air conditioner to prevent condensation from dripping onto the appliance.
- Make sure all filters are properly installed before you switch on the appliance.
- Only use the original Philips filters specially intended for this appliance. Do not use any other filters.
- Combustion of the filter may cause irreversible human hazard and/or jeopardize other lives. Do not use the filter as fuel or for similar purpose.
- Avoid knocking against the appliance (the air inlet and outlet in particular) with hard objects.

- Do not insert your fingers or objects into the air outlet or the air inlet to prevent physical injury or malfunctioning of the appliance.
- Do not use this appliance when you have used indoor smoke-type insect repellents or in places with oily residues, burning incense, or chemical fumes.
- Do not use the appliance near gas appliances, heating devices or fireplaces.
- Always unplug the appliance after use and before cleaning, or carrying out other maintenance or replacing the filters.
- Do not use the appliance in a room with major temperature changes, as this may cause condensation inside the appliance.
- To prevent interference, place the appliance at least 2 meters away from electrical appliances that use airborne radio waves such as TVs, radios, and radio-controlled clocks.
- The appliance is only intended for household use under normal operating conditions.
- Do not use the appliance in wet surroundings or in surroundings with high ambient temperatures, such as the bathroom, toilet, or kitchen.
- The appliance does not remove carbon monoxide (CO) or radon (Rn). It cannot be used as a safety device in case of accidents with combustion processes and hazardous chemicals.
- If you need to move the appliance, disconnect the appliance from the power supply first.
- Do not move the appliance by pulling its power cord.
- Always cleanse your hands after changing the filters.

2 Your air purifier

Congratulations on your purchase, and welcome to Philips!

To fully benefit from the support that Philips offers, register your product at www.philips.com/welcome.

Product overview (fig. ①)













- A Control buttons
- B Air outlet cover
- C Air quality sensor
- D Display panel
- E NanoProtect filter HEPA Series 3 (FY5185)
- F NanoProtect filter Active Carbon (FY5182)
- G Pre-filter
- H Side covers

Controls overview (fig. ②)

Control buttons

- I Power on/off button
- J Light on/off button
- K Auto mode button
- L Fan speed button
- M Child lock button
- N Reset button

Display panel:

-  Sleep mode
-  Speed 1
-  Speed 2
-  Speed 3
-  Turbo mode
-  Filter replacement alert
-  Pre-filter cleaning alert
-  Wi-Fi indicator
- Gas** Gas display
- PM2.5** PM2.5 display
- IAI** Indoor Allergen Index display
-  General mode
-  Allergen mode
-  Bacteria & Virus mode
-  Child lock indicator

3 Getting started

Installing the filters



Note

- There is one set of filters on each side of the appliance. Each side is equipped with one pre-filter and one air purification filter.
- Make sure that you place the air purification filter in the appliance first and then the pre-filter.
- Make sure that the side with the tag is pointing towards you when installing the filter.

- 1 Pull the top part of the side panel to remove it from the air purifier (fig.③).
- 2 Press the two clips down (1) and pull the pre-filter towards you (2) (fig.④).
- 3 Remove all filters (fig.⑤).
- 4 Remove all packaging materials from the filters (fig.⑥).
- 5 Place the thick filter (**FY5185**) into the air purifier and then the thin AC filter (**FY5182**). The model numbers are shown on each filter (fig.⑦).
- 6 Attach the pre-filter back into the air purifier (fig.⑧).



Note

- Make sure the side with the two clips is pointing towards you, and that all hooks of the pre-filter are properly attached to the purifier.

- 7 Reattach the front panel by pressing the top part of the panel onto the top of the air purifier (1). Then, gently push the panel against the body of the air purifier (2) (fig.⑨).



- 8 Repeat the above steps and assemble the filter for the other side of the air purifier.
- 9 Wash your hands thoroughly after installing filters.

Wi-Fi connection

Setting up the Wi-Fi connection for the first time

- 1 Download and install the Philips "Clean Home+" app from the **App Store** or **Google Play**.



- 2 Put the plug of the air purifier in the power socket and touch  to turn on the air purifier.
↳ The Wi-Fi indicator  blinks orange for the first time.
- 3 Make sure that your smartphone or tablet is successfully connected to your Wi-Fi network.
- 4 Launch the "Clean Home+" app and click on "Connect a New Device" or press the "+" button on the top of the screen. Follow the onscreen instructions to connect the air purifier to your network.
- 5 After the successful pairing and connection, the Wi-Fi indicator  will light up white. If pairing is not successful, consult the troubleshooting section, or the help section in the "Clean Home+" App for extensive and up-to-date troubleshooting tips.



Note

- This instruction is only valid when the air purifier is being set up for the first time. If the network has changed or the setup needs to be performed again, consult section "Reset the Wi-Fi connection" on page 7.
- If you want to connect more than one air purifier to your smartphone or tablet, you have to do this one by one. Complete the set up of one air purifier before you turn on the other air purifier.
- Make sure that the distance between your smartphone or tablet and the air purifier is less than 10 m without any obstructions.
- This App supports the latest versions of Android and iOS. Please check www.philips.com/cleanhome for the latest update of supported operating systems and devices.

Reset the Wi-Fi connection



Note

- This applies when the default network to which your purifier is connected has changed.
- Reset the Wi-Fi connection when your default network has changed.

- 1 Put the plug of the air purifier in the power socket and touch to turn on the air purifier.
- 2 Touch and simultaneously for 3 seconds until you hear a beep.
 - ➔ The air purifier goes to pairing mode.
 - ➔ The Wi-Fi indicator blinks orange.
- 3 Follow the steps 4-5 in "Setting up the Wi-Fi connection for the first time" section.

4 Using the air purifier

Understanding the air quality light

IAI is a real-time numerical display that provides visual and immediate feedback on indoor allergen level.

IAI	Air quality light color	Air quality level
1-3	Blue	Good
4-6	Blue-Purple	Fair
7-9	Purple-Red	Poor
10-12	Red	Very poor

The air quality light automatically goes on when the air purifier is switched on, and lights up all colors in sequence. After approximately 30 seconds, the air quality sensors select the color that corresponds to the surrounding air quality of airborne particles.

IAI

The professional-grade **AeraSense** sensor detects the level of indoor air allergen and with numerical feedback from 1 to 12 the potential risk level of indoor air allergens can be displayed. 1 indicates best air quality.



GAS

With an advanced as sensor, a display ranging from L1 to L4 shows the density level of potential harmful gases (incl. VOC, odor, etc.) detected. L1 indicates best air quality.

Turning on and off

Note



- Always place the air purifier on a stable, horizontal, and level surface with the front of the unit facing away from walls or furniture.
- For optimum purification performance, close doors and windows.
- Keep curtains away from the air inlet or air outlet.

- 1 Put the plug of the air purifier in the power socket.
 - ↳ The air purifier beeps.
 - ↳ All lights go on once and then go out again.
- 2 Touch  to switch on the air purifier (fig. 10).
 - ↳ The air purifier operates under the allergen mode by default.
 - ↳ When the air purifier is warming up, "----" displays on the screen. After measuring the particulate matter only in the air, the air purifier shows the IAI level and operates in the auto mode with  displayed on the screen (fig. 11).
 - ↳ After 30 seconds, the air purifier shows the IAI level on the screen. The air quality sensor automatically selects the appropriate air quality light color.
- 3 Touch and hold  for 3 seconds to switch off the air purifier.

Note



- If the air purifier stays connected to the electrical outlet after turning OFF, the air purifier will operate under the previous settings when turned ON again.

Changing the Auto mode setting

You can choose the Allergen mode () , the General mode () or the Bacteria & Virus mode () .



Allergen mode

The extra-sensitive allergen mode is designed to react to even a small change in allergen levels in the surrounding air.

- Touch the Auto mode button  to select the Allergen mode (fig. 12).
 - ↳ Auto () and  display on the screen.

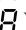

General mode

A smart auto-setting that automatically adjusts the air purifier's settings to the ideal level.

- Touch the Auto mode button  to select the General mode (fig. 13).
 - ↳ Auto () and  display on the screen.

Bacteria & Virus mode

The bacteria & virus mode boosts the airflow to quickly reduce bacteria & viruses.

- Touch the Auto mode button  to select the Bacteria & Virus mode (fig. 14).
 - ↳ Auto () and  display on the screen.

Changing the fan speed

In addition to the Auto modes, there are several fan speeds available.

When using the manual fan speed settings, the purifier will still monitor the air quality, but it will not automatically adjust the fan speed if it detects changes in the air quality.

Sleep mode (☾)

In sleep mode, the air purifier operates quietly at a very low speed.

- Touch the fan speed button (⊗) to select the sleep mode (SL) (fig.15).
 - ↳ The "SL" displays on the screen.
 - ↳ The sleep mode indicator ☾ goes on.

Manual

- Touch the fan speed button (⊗) repeatedly to select the fan speed you need (fig.16):
 - ~ (Speed 1)
 - ≡ (Speed 2)
 - ≡ (Speed 3)

Turbo (t)

In turbo mode, the air purifier operates on the highest speed.

- Touch the fan speed button (⊗) to select the turbo mode (t) (fig.17).
 - ↳ The "t" displays on the screen.
 - ↳ The turbo speed indicator Ⓢ goes on.

Using the light on/off function

With the light on/off button, you can switch on or off the air quality light, the display screen and the function indicator if desired.

- 1 Touch the light on/off button ☼ once, the air quality light will be dimmed.
- 2 Touch the light on/off button ☼ again, the air quality light will go off.
- 3 Touch the light on/off button ☼ for the third time, all lights will be on again.

Switching the display indicator

The air purifier has three display indicators, IAI index, PM2.5 index, and Gas level.



Note

- The air purifier operates in IAI index by default.

- 1 Touch the light on/off button ☼ for 3 seconds to switch to PM2.5 display mode (fig.18).
 - ↳ The PM2.5 level displays on the screen.
- 2 Touch the light on/off button ☼ for 3 seconds again to switch back to IAI display mode (fig.19).
 - ↳ The IAI indicator and the actual IAI index display on the screen.

- 3 Touch the light on/off button  for 3 seconds again to switch to Gas level display (fig. 20).

↳ The Gas indicator and the actual Gas level display on the screen.

Note

- It is possible that the air quality light may still be red even if the PM2.5 index is very low. It's normal. This is because that at least one of the index (the IAQ index or Gas level) is high that turns the air quality light to red. The appliance real-time displays the air quality index with the highest risk.

Setting the child lock

- 1 Touch and hold the child lock button  for 3 seconds to activate child lock (fig. 21).

↳ The child lock icon  displays on the screen.

↳ When the child lock is on, all the other buttons are not responsive.

- 2 Touch and hold the child lock button  for 3 seconds again to deactivate child lock.

↳ The child lock icon  disappears.

Note

- You can still control the appliance through the App even child lock is activated.

5 Cleaning

Note

- Always turn the air purifier off and unplug from the electrical outlet before cleaning.
- Never immerse the air purifier in water or any other liquid.
- Never use abrasive, aggressive, or flammable cleaning agents such as bleach or alcohol to clean any part of the air purifier.
- Only the pre-filter is washable. The air filters are not washable.
- Do not attempt to clean the filters or air quality sensor with a vacuum.

Cleaning the body of the air purifier

Regularly clean the inside and outside of the air purifier to prevent dust from collecting.

- 1 Use a soft, dry cloth to clean both the interior and exterior of the air purifier.
- 2 The air outlet can also be cleaned with a dry, soft cloth.

Cleaning the air outlet cover

- 1 To unlock the air outlet cover, grab the handle on the cover and pull the cover up (fig. 22).
- 2 Clean the cover with a brush (fig. 23).
- 3 To reattach the cover, mount it onto the top of the appliance first, and then push the side with the handle towards the appliance (fig. 24).

Cleaning the air quality sensor

Clean the air quality sensor every two months for optimal functioning of the appliance. Clean it more frequently if you use the appliance in a dusty environment.



Note

- If the air purifier is used in a dusty environment, it may need to be cleaned more often.
- If the humidity level in the room is very high, condensation may develop on the air quality sensor and the air quality light may indicate a poorer air quality even though the air quality is actually good. If this occurs, clean the air quality sensor or use the air purifier on a manual speed setting.

- 1 Switch off the air purifier and unplug from the power socket.
- 2 Clean the air quality sensor inlet and outlet with a soft brush (fig. 25).
- 3 Open the air quality sensor cover (fig. 26).
- 4 Clean the air quality sensor, the dust inlet and the dust outlet with a damp cotton swab (fig. 27).
- 5 Dry all parts thoroughly with a dry cotton swab.
- 6 Reattach the air quality sensor cover (fig. 28).

Cleaning the pre-filter



Clean the pre-filter when **F0** is displayed on the screen and the pre-filter cleaning indicator  is on (fig. 29).

- 1 Switch off the air purifier and unplug from the power socket.
- 2 Pull the top part of the side panel to remove it from the air purifier (fig. 3).
- 3 Press the two clips down (1) and pull the pre-filter towards you (2) (fig. 4).
- 4 If the pre-filter is very dirty, use a soft brush to brush away the dust. Then wash the pre-filter under running tap water (fig. 30).
- 5 Allow the pre-filter to air dry thoroughly before placing back in the air purifier.
- 6 Put the pre-filter back into the air purifier (fig. 8).



Note

- To optimize the lifetime of the pre-filter, make sure it air dries completely after cleaning.
- Wash your hands after handling the filter.
- Make sure the side with the two clips is pointing towards you, and that all hooks of the pre-filter are properly attached to the air purifier.

- 7** To reattach the front panel, press the top part of the panel onto the top of the air purifier (1). Then, gently push the panel against the body of the air purifier (2) (fig. 9).
- 8** Put the plug of the air purifier in the power socket.
- 9** Touch the  button to switch on the appliance.
- 10** Touch and hold the reset button  for 3 seconds to reset the pre-filter cleaning time.
- 11** Wash your hands thoroughly after installing filters.

6 Replacing the filters

Filter replacement indicator

This air purifier is equipped with a filter replacement indicator to make sure that the air purification filter is in optimal condition when the air purifier is operating. When the filters need to be replaced, the filter code displays on the screen (see Filter alert chart).

If the filters are not replaced in time, the air purifier will stop operating and automatically lock to protect the air quality in the room. Replace the filters as soon as possible according to the filter code.



Replacing the filters



Note

- The air filters are not washable or reusable.
- Always turn off the air purifier and unplug from the electrical outlet before replacing the filters.
- Do not clean the filters with a vacuum.
- If the pre-filter is damaged, worn or broken, do not use. Visit www.philips.com/support or contact the Consumer Care Center in your country.

Filter alert chart

Filter alert light status	Action
A3 displays on the screen and the filter replacement alert  goes on	Replace the NanoProtect filter HEPA Series 3 (FY5185)
C7 displays on the screen and the filter replacement alert  goes on	Replace the NanoProtect filter Active Carbon (FY5182)
A3 and C7 display on the screen alternately and the filter replacement alert  goes on	Replace both filters

- 1 Turn off the air purifier and unplug from the power socket.
- 2 Take out the used air filter according to the filter alert light status displayed on the screen. Discard used filters (fig. 31).

Note

- Do not touch the pleated filter surface, or smell the filters as they have collected pollutants from the air.





- 3 Remove all packaging material from the new filters (fig. 6).
- 4 Place the new filters into the air purifier (fig. 7).
- 5 Put the plug of the air purifier in the power socket.
- 6 Touch and hold the reset button  for 3 seconds to reset the filter lifetime counter.

Note

- Wash your hands after changing a filter.
- This air purifier has no other user-serviceable parts. For assistance, contact the Consumer Care Center in your country.

Filter reset

You can replace filters even if there is no filter replacement code displayed on the screen. After replacing a filter, you need to reset the filter lifetime counter manually.

- 1 Touch  and  simultaneously for 3 seconds to enter the filter reset mode (fig. 32).
↳ Code (A3) of the NanoProtect filter HEPA Series 3 displays on the screen.
- 2 Touch and hold  for 3 seconds to force reset the filter lifetime counter of the NanoProtect filter HEPA Series 3 (fig. 33).
- 3 Code (C7) of the NanoProtect filter Active Carbon displays on the screen after the lifetime counter of the NanoProtect filter HEPA Series 3 has been reset (fig. 34).
- 4 Touch and hold  for 3 seconds to force reset the filter lifetime counter of the NanoProtect filter Active Carbon and exit the filter reset mode (fig. 35).



7 Storage

- 1 Turn off the air purifier and unplug from the power socket.
- 2 Clean the air purifier, air quality sensor and pre-filter (see chapter 'Cleaning').
- 3 Let all parts air dry thoroughly before storing.
- 4 Wrap the filters and pre-filters separately in air tight plastic bags.
- 5 Store the air purifier, filters and pre-filters in a cool, dry location.
- 6 Always thoroughly wash hands after handling filters.

8 Troubleshooting

This chapter summarizes the most common problems you could encounter with the appliance. If you are unable to solve the problem with the information below, contact the Consumer Care Center in your country.

Problem	Possible solution
The air purifier does not work even though it is plugged into the power socket and switched on.	<ul style="list-style-type: none"> • Check if the top cover is properly installed. • The filter replacement light has been on continuously but you have not replaced the corresponding filter. As a result, the appliance is now locked. In this case, replace the filter and reset the filter lifetime counter.
The airflow that comes out of the air outlet is significantly weaker than before.	<ul style="list-style-type: none"> • The pre-filter is dirty. Clean the pre-filter (see chapter "Cleaning").
The air quality does not improve, even though the air purifier has been operating for a long time.	<ul style="list-style-type: none"> • Check if the packing material is removed from the filters. • One of the filters has not been placed in the air purifier or a filter is not placed properly. Make sure that all filters are properly installed in the following order, starting with the innermost filter: 1) NanoProtect filter HEPA Series 3 (FY5185); 2) NanoProtect filter Active Carbon (FY5182); 3) pre-filter. • The air quality sensor is wet. Make sure that the air quality sensor is clean and dry (see chapter "Cleaning").
The air purifier produces a unpleasant smell.	<ul style="list-style-type: none"> • The first few times you use the appliance, it may produce a plastic smell. This is normal. However, if the appliance produces a burnt smell, contact your Philips dealer or an authorized Philips service center. The filter may produce smell after being used for a while because of the absorption of indoor air. Remove the filter and place it where it has direct sunlight and ventilation for several hours. Re-install and try using it again. If the odor remains, please replace the filter.
The air purifier is loud.	<ul style="list-style-type: none"> • If the air purifier is too loud, change the fan speed to a lower fan speed level. When using the air purifier in a bedroom at night, choose the sleep mode.

Problem	Possible solution
The air purifier still indicates that I need to replace a filter, but I already did.	<ul style="list-style-type: none"> Perhaps you did not reset the filter lifetime counter. Plug in the air purifier, touch  to switch on the air purifier, and touch and hold the reset button  for 3 seconds (see Filter reset section).
Error code "E1" displays on the screen.	<ul style="list-style-type: none"> The motor has malfunctions. Contact the Consumer Care Center in your country.
Error codes "E2", "E3", "E4" or "E5" displays on the screen.	<ul style="list-style-type: none"> The sensor has malfunctions. Contact the Consumer Care Center in your country.
Which App I should download?	<ul style="list-style-type: none"> Download and install the Philips "Clean Home+" app from the App Store or Google Play.
The Wi-Fi setup is not successful.	<ul style="list-style-type: none"> If the router your purifier is connected to is dual-band and currently it is not connecting to a 2.4GHz network, please switch to another band of the same router (2.4GHz) and try to pair your purifier again. 5GHz networks are not supported. Web authentication networks are not supported. Check if the purifier is within range of the Wi-Fi router. You can try to locate the air purifier closer to the Wi-Fi router. Check if the network name is correct. The network name is case-sensitive. Check if the Wi-Fi password is correct. The password is case-sensitive. Retry the setup with the instructions in section 'Set up the Wi-Fi connection when the network has changed'. The Wi-Fi connectivity can be interrupted by electromagnetic or other interferences. Keep the appliance away from other electronic devices that may cause interferences. Check if the mobile device is in airplane mode. Make sure to have the airplane mode deactivated when connecting to the Wi-Fi network. Consult the help section in the App for extensive and up-to-date troubleshooting tips.

9 Guarantee and service

If you need information or if you have a problem, please visit the Philips website at www.philips.com or contact the Philips Consumer Care Center in your country (you find its phone number in the worldwide guarantee leaflet). If there is no Consumer Care Centre in your country, go to your local Philips dealer.

Order parts or accessories

If you have to replace a part or want to purchase an additional part, go to your Philips dealer or visit www.philips.com/support.

If you have problems obtaining the parts, please contact the Philips Consumer Care Center in your country (you can find its phone number in the worldwide guarantee leaflet).

10 Notices

Electromagnetic fields (EMF)

This Philips appliance complies with all applicable standards and regulations regarding exposure to electromagnetic fields.

Compliance with EMF

Koninklijke Philips N.V. manufactures and sells many products targeted at consumers, which, like any electronic apparatus, in general have the ability to emit and receive electromagnetic signals.

One of Philips' leading Business Principles is to take all necessary health and safety measures for our products, to comply with all applicable legal requirements and to stay well within the EMF standards applicable at the time of producing the products.

Philips is committed to develop, produce and market products that cause no adverse health effects. Philips confirms that if its products are handled properly for their intended use, they are safe to use according to scientific evidence available today.

Philips plays an active role in the development of international EMF and safety standards, enabling Philips to anticipate further developments in standardization for early integration in its products.

Recycling

Do not throw away the product with the normal household waste at the end of its life, but hand it in at an official collection point for recycling. By doing this, you help to preserve the environment.

Follow your country's rules for the separate collection of electrical and electronic products. Correct disposal helps prevent negative consequences for the environment and human health.

Notice

App Store is a service mark of Apple Inc.
Google Play is a trademark of Google Inc.

This Philips appliance and Clean Home+ app applied multiple open source softwares. Copies of open source software license text used in this product can be derived from website- www.philips.com/cleanhome.

目錄

1 重要事項	20	7 收納	29
安全性	20		
2 您的空氣清淨機	22	8 疑難排解	30
產品概要 (圖 ①)	22		
控制項目概要 (圖 ②)	22	9 保固與服務	32
		訂購零件或配件	32
3 快速入門	23	10 聲明	32
安裝濾網	23	電磁場 (EMF)	32
Wi-Fi 連線	23	回收	32
		注意	33
4 使用空氣清淨機	24		
瞭解空氣品質指示燈	24		
開關機	25		
變更自動模式設定	25		
變更風速	26		
使用開/關燈按鈕	26		
切換顯示指示燈	26		
設定兒童鎖	26		
5 清潔	27		
清潔空氣清淨機的機體	27		
清潔空氣出風口護蓋	27		
清潔空氣品質感測器	27		
清潔前層濾網	27		
6 更換濾網	28		
濾網更換指示器	28		
更換濾網	28		
濾網重設	29		

使用環保紙張。感謝您為守護樹木貢獻一份心力。

1 重要事項

安全性

在使用本產品前，請先仔細閱讀本使用手冊，並保留說明以供日後參考。

危險

- 請勿讓水或其他液體，或是易燃清潔劑進入產品內，以避免觸電和 / 或火災。
- 請勿用水、其他液體，或是 (易燃) 清潔劑清潔產品，以避免觸電和 / 或火災。
- 請勿在產品周圍噴灑殺蟲劑或芳香劑等任何易燃物質。

警告

- 在您連接電源之前，請檢查本地的電源電壓是否與產品所示的電壓相符。
- 如果電源線損壞，您必須將其交由飛利浦、飛利浦授權之服務中心，或是具備相同資格的技師進行更換，以免發生危險。
- 當插頭、電源線或產品本身受損時，請勿使用本產品。
- 本產品可供 8 歲以上孩童、身體官能或心智能力退化者，或是經驗與使用知識缺乏者使用，但需要有人在旁監督或適當指示如何安全使

用本產品，以及可能遭受的危險。請勿讓孩童把玩本產品。若無人在旁監督，不得讓孩童清潔與維護本產品。

- 請勿在出風口上方或進風口前面放置物品，擋住進出風口。
- 確定沒有異物透過出風口掉入產品。
- 2.4 GHz 802.11b/g/n 標準 WiFi 介面，最大輸出功率為 31.62 mW EIRP。

注意

- 本產品不可用來作為維持良好通風的設備、替代吸塵器清潔，或烹調時用來當作抽油煙機使用。
- 如果供應產品電力的電源插座接頭不良，產品插頭會發熱。請確定將產品插入接頭良好的插座。
- 請將本產品放置在乾燥平穩的水平面上使用。
- 產品的背面及側面須至少保留 20 公分的間隔距離，頂部則至少保留 30 公分的間隔距離。
- 產品頂部請勿放置任何物品。

- 請勿坐在或站在產品上。站或坐在本產品上可能引發潛在傷害。
- 請勿將產品放置在冷氣機正下方，以免冷氣機滴水，造成產品發生水滴凝結的現象。
- 請在開啟產品電源前，先確認所有濾網皆已正確安裝。
- 請僅使用產品專用的飛利浦原廠濾網。請勿使用其他濾網。
- 燃燒濾網可能會對人體造成不可逆危險和/或危及其他生命。請勿將濾網當成燃料，或以類似目的使用濾網。
- 切勿使用硬物敲打產品 (特別是進風口及出風口)。
- 請勿將手指或物體插入出風口或進風口，以避免身體受傷或損壞產品。
- 當您使用室內噴霧式驅蟲劑或在充滿油漬、燒香、香煙的火星或化學煙霧的地方時，請勿使用本產品。
- 請勿在氣體用品、加熱裝置或壁爐附近使用本產品。
- 使用完畢後，以及在進行清潔或其他維修或更換濾網之前，請務必先拔除產品的電源插頭。
- 請勿在溫差變化極大的室內使用本產品，因為室溫差距太大會造成本產品內部凝結水珠。
- 請將本產品遠離使用無線電電波的電器至少 2 公尺以避免干擾，例如電視、無線電廣播、無線電信號控制的時鐘。
- 本產品為家用產品，僅限於在正常操作環境下使用。
- 請勿在極為潮濕或周遭溫度很高的環境下使用本產品，例如浴室、廁所或廚房。
- 本產品無法清除一氧化碳 (CO) 或氫氣 (Rn)。發生燃燒意外及危險化學物品意外時，本產品無法當作安全裝置使用。
- 若您需要搬動產品，請先切斷產品電源供應。
- 請勿以拉動電源線的方式移動本產品。
- 更換濾網後請務必清潔雙手。

2 您的空氣清淨機

感謝您購買本產品。歡迎來到飛利浦的世界！

請至 www.philips.com/welcome 註冊您的產品，以獲得飛利浦提供的完整支援。

產品概要 (圖 ①)





- A 控制按鈕
- B 空氣出風口護蓋
- C 空氣品質感測器
- D 顯示面板
- E 納米級防護HEPA S3型濾網 (FY5185)
- F 納米級防護活性炭濾網 (FY5182)
- G 前層濾網
- H 側邊護蓋

控制項目概要 (圖 ②)

控制按鈕

- I 電源開/關按鈕
- J 開/關燈按鈕
- K 自動模式按鈕
- L 風速按鈕
- M 兒童鎖按鈕
- N 重設按鈕

顯示面板：

-  睡眠模式
-  速度 1
-  速度 2
-  速度 3
-  超高速
-  濾網更換警示
-  前層濾網清潔警示
-  Wi-Fi 指示燈
- Gas** 氣體指示燈
- PM2.5** PM2.5 指示燈
- IAI** 過敏原指數指示燈
-  一般模式
-  過敏原模式
-  細菌與病毒模式
-  兒童鎖指示燈

3 快速入門

安裝濾網

備註

- 本產品的兩側都有一組濾網。每邊配備一個前層濾網和一個空氣淨化濾網。
- 務必先安裝空氣淨化濾網，再裝前層濾網。
- 安裝濾網時，請確認有拉片的一側朝向自己。

- 1 拉出側面護板的頂部，將它從空氣清淨機中取出 (圖 ③)。
- 2 按壓兩個固定夾 (1)，再朝自己的方向拉出前層濾網 (2) (圖 ④)。
- 3 取出所有濾網 (圖 ⑤)。
- 4 拆下濾網的所有包裝材料 (圖 ⑥)。
- 5 將較厚的濾網 (FY5185) 裝至空氣清淨機，然後裝上較薄的 AC 濾網 (FY5182) 每個濾網皆會顯示型號 (圖 ⑦)。
- 6 將前層濾網裝回空氣清淨機 (圖 ⑧)。

備註

- 請確認具兩個固定夾的一側朝向自己，且前層濾網的所有扣鉤皆已正確裝入清淨機。



- 7 重新裝入正面護板，請先將護板頂部壓入空氣清淨機頂部 (1)。接著，輕輕將護板輕推入空氣清淨機機體 (2) (圖 ⑨)。
- 8 重複上述步驟，安裝空氣清淨機另一側的濾網。
- 9 裝好濾網後，請徹底清潔雙手。

Wi-Fi 連線

第一次設定 Wi-Fi 連線

- 1 前往 App Store 或 Google Play 下載並安裝 Philips 「Clean Home+」應用程式。

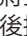

- 2 將空氣清淨機的插頭插入電源插座，然後按下  以開啟空氣清淨機。
↳ 第一次使用時，Wi-Fi 指示燈  會閃爍橘光。
- 3 請確定智慧型手機或平板裝置已成功連線至您的 Wi-Fi 網路。
- 4 啟動「Clean Home+」應用程式並按一下「連接新裝置」或按下畫面上方的「+」按鈕。依照螢幕指示將空氣清淨機連接至您的網路。
- 5 成功配對和連線後，Wi-Fi 指示燈  會亮起白光。如果配對不成功，請參閱疑難排解部分，或「Clean Home+」應用程式的說明部分，以深入掌握最新的疑難排解秘訣。





備註

- 此說明僅在第一次設定空氣清淨機時才適用。如果網路已變更或需要再次執行設定，請參閱第 24 頁的「重設 Wi-Fi 連線」部分。
- 如要將一台以上的空氣清淨機連線到智慧型手機或平板裝置，必須逐一設定。請先完成一台空氣清淨機的設定後，再開啟其他空氣清淨機。
- 務請確定您的智慧型手機或平板裝置與空氣清淨機之間的距離少於 10 公尺，且沒有任何阻礙物。
- 本應用程式支援最新版 Android 和 iOS。請至 www.philips.com/cleanhome 查看最新更新的支援作業系統和裝置。

重設 Wi-Fi 連線

備註

- 這適用於空氣清淨機連線的預設網路已變更時。
- 在預設網路已變更時重設 Wi-Fi 連線。

- 1 將空氣清淨機的插頭插入電源插座，然後按下  以開啟空氣清淨機。
- 2 同時按下  和  3 秒鐘，直到聽到嗶聲。
 - ↳ 此時空氣清淨機會進入配對模式。
 - ↳ Wi-Fi 指示燈  會閃爍橘光。
- 3 請依照「第一次設定 Wi-Fi 連線」部分的步驟 4-5 進行。

4 使用空氣清淨機

瞭解空氣品質指示燈

IAI 為即時的數字顯示，對室內過敏原等級提供立即可見的回饋資訊。

IAI	空氣品質指示燈顏色	空氣品質等級
1-3	藍色	很棒
4-6	藍色 - 紫色	普通
7-9	紫色 - 紅色	不良
10-12	紅色	非常不良

空氣清淨機電源開啟後，空氣品質指示燈會自動亮起，並依序閃爍所有燈色。在約 30 秒後，空氣品質感測器會選擇符合周遭空氣粒子品質的相應顏色。

IAI

專業級的 AeraSense 感測器能偵測到室內空氣過敏原的等級，並提供 1 到 12 的數據回饋資訊，顯示室內空氣過敏原的潛在危險等級。1 表示空氣品質最佳。



氣體

配備進階氣體感測器，範圍從 L1 到 L4 的顯示器會顯示偵測到的潛在有害氣體密度等級 (包括揮發性有機物 (VOC)、異味等)。L1 表示空氣品質最佳。

開關機

備註



- 請務必將空氣清淨機放在平穩的水平表面上，產品正面背對牆壁或家具。
- 為達最佳淨化效能，請關閉門窗。
- 進風口或出風口需遠離窗簾。

- 1 將空氣清淨機的插頭插入電源插座。
 - ↳ 空氣清淨機會發出嗶聲。
 - ↳ 所有燈號亮一次後，再次熄滅。
- 2 按下  以開啟空氣清淨機的電源 (圖 10)。
 - ↳ 空氣清淨機預設為以過敏原模式運作。
 - ↳ 空氣清淨機正在暖機時，螢幕上會顯示「---」。在僅測量空氣中的懸浮微粒後，空氣清淨機會顯示 IA1 等級，並以自動模式運作， 會顯示在螢幕上 (圖 11)。
 - ↳ 30 秒後，空氣清淨機螢幕會顯示 IA1 等級。空氣品質感測器會自動選擇適當的空氣品質指示燈顏色。
- 3 按住  3 秒鐘即可關閉空氣清淨機的電源。

備註



- 如果空氣清淨機在關閉之後保持連接至電源插座，則當空氣清淨機再次開啟時，會以先前的設定運作。

變更自動模式設定

您可以選擇過敏原模式 ()、一般模式 () 或細菌和病毒模式 ()。

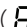

過敏原模式

超敏感的過敏原模式經專門設計，即使周遭空氣中的過敏原等級只有小幅度變化，亦可做出因應。

- 按下自動模式按鈕  以選擇過敏原模式 (圖 12)。
- ↳ 螢幕上會顯示自動 () 和 。

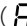

一般模式

此智慧型自動設定可將空氣清淨機的設定自動調整至最適合的程度。

- 按下自動模式按鈕  以選擇一般模式 (圖 13)。
- ↳ 螢幕上會顯示自動 () 和 。

細菌和病毒模式

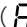
細菌和病毒模式可增強風量，以快速減少細菌和病毒。

- 按下自動模式按鈕  以選擇細菌與病毒模式 (圖 14)。
- ↳ 螢幕上會顯示自動 () 和 。

變更風速

除了自動模式，還有多種風速可用。

使用手動風速設定時，清淨機還是會監控空氣品質，但不會在偵測到空氣品質發生變化時自動調整風速。

睡眠模式 (☾)

在睡眠模式中，空氣清淨機會以非常低的速度安靜地運作。

- 按下風速按鈕 (⊗) 以選擇睡眠模式 (SL) (圖 15)。
 - 螢幕上會顯示「SL」。
 - 睡眠模式指示燈 ☾ 會亮起。

手動

- 重複按下風速按鈕 (⊗) 以選擇所需風速：(圖 16)：
 - ～ (速度 1)
 - ≡ (速度 2)
 - ≡ (速度 3)

超高速 (t)

在超高速模式下，空氣清淨機會以最高速度運作。

- 按下風速按鈕 (⊗) 以選擇超高速模式 (t) (圖 17)。
 - 螢幕上會顯示「t」。
 - 超高速指示燈 t 會亮起。

使用開/關燈按鈕

透過開/關燈按鈕，就能視需要開啟或關閉空氣品質指示燈、顯示螢幕及功能指示燈。

- 按一下開/關燈按鈕 ☼，空氣品質指示燈隨即變暗。
- 再按一下開/關燈按鈕 ☼，空氣品質指示燈隨即熄滅。
- 三度按下開/關燈按鈕 ☼，所有指示燈即會再次亮起。

切換顯示指示燈

本空氣清淨機有三種顯示指示燈：IAI 指數、PM2.5 指數及氣體等級。

備註

- 空氣清淨機預設以 IAI 指數運作。

- 按下開/關燈按鈕 ☼ 3 秒鐘，以切換至 PM2.5 顯示模式 (圖 18)。
 - 螢幕會顯示 PM2.5 等級。
- 再次按下開/關燈按鈕 ☼ 3 秒鐘，以切換回到 IAI 顯示模式 (圖 19)。
 - 螢幕上會顯示 IAI 指示燈和實際 IAI 指數。
- 再次按下開/關燈按鈕 ☼ 3 秒鐘可切換至氣體等級顯示幕 (圖 20)。
 - 螢幕上會顯示氣體指示燈及實際氣體等級畫面。

備註

- 即使 PM2.5 指數非常低，空氣品質指示燈有可能仍會顯示紅色。此為正常現象。這是因為至少其中一個指數 (IAI 指數或氣體等級) 過高，導致空氣品質指示燈轉為紅色。本產品會即時顯示空氣品質，並說明可能性最高的風險。

設定兒童鎖

- 按住保護鎖按鈕 3 秒鐘，可啟動保護鎖 (圖 21)。
 - 螢幕會顯示兒童鎖圖示 。
 - 兒童鎖啟用時，所有其他按鈕都不會有反應。
- 再次按住兒童鎖按鈕 3 秒，即可停用兒童鎖。
 - 兒童鎖圖示 會消失。

備註

- 即使保護鎖已啟動，您仍可透過應用程式控制本產品。

5 清潔

備註

- 清潔前請務必關閉空氣清淨機電源，並從電源插座拔掉插頭。
- 切勿讓空氣清淨機浸入水或其他液體中。
- 切勿使用漂白劑或酒精等具磨蝕性、刺激性或易燃洗劑清潔空氣清淨機的任何部分。
- 只有前層濾網可水洗。空氣濾網皆不得水洗。
- 請勿試圖以吸塵器清理濾網或空氣品質感測器。

清潔空氣清淨機的機體

定期清潔空氣清淨機的內部與外殼，可避免累積灰塵。

- 1 使用柔軟乾布清潔空氣清淨機的外內部。
- 2 出風口亦可使用柔軟乾布清潔。

清潔空氣出風口護蓋

- 1 若要鬆開空氣出風口護蓋，握住護蓋上的握把，將護蓋向上拉 (圖 22)。
- 2 用軟刷清潔護蓋 (圖 23)。
- 3 若要裝回蓋子，將其先裝入產品頂部，然後使用握把朝產品的方向按壓側邊 (圖 24)。

清潔空氣品質感測器

每兩個月清潔空氣品質感測器，使產品發揮最佳功效。如果在佈滿灰塵的環境中使用產品，就要更常進行清潔。

備註

- 若在佈滿灰塵的環境中使用空氣清淨機，可能需要更常清潔。
- 若房間溼度過高，空氣品質感測器可能有水滴凝結，在這種情況下，縱使空氣品質良好，空氣品質指示燈也可能指示空氣品質不佳。若發生此種情形，請清潔空氣品質感測器，或依手動風速設定使用本空氣清淨機。

- 1 關閉空氣清淨機的電源，從電源插座拔掉插頭。
- 2 請使用軟刷來清潔空氣品質感測器的進風口及出風口 (圖 25)。
- 3 打開空氣品質感測器的護蓋 (圖 26)。
- 4 請使用溼棉棒清潔空氣品質感測器、覆有灰塵的進風口和出風口 (圖 27)。
- 5 使用乾棉棒擦乾所有零件。
- 6 重新裝上空氣品質感測器的護蓋 (圖 28)。



清潔前層濾網

螢幕上顯示 F0 且前層濾網清潔指示燈 (圖 29) 亮起時，請清潔前層濾網。

- 1 關閉空氣清淨機的電源，從電源插座拔掉插頭。
- 2 拉出正面護板的底部，將它從空氣清淨機中取出 (圖 3)。
- 3 按壓兩個固定夾 (1)，再朝自己的方向拉出前層濾網 (2) (圖 4)。
- 4 如果前層濾網很髒，請使用軟刷來清除灰塵。接著，以流動的自來水清洗前層濾網 (圖 30)。
- 5 先確保前層濾網徹底風乾後，再放回空氣清淨機。
- 6 將前層濾網裝回空氣清淨機 (圖 8)。

備註

- 為使前層濾網壽命最佳化，清潔後請確認濾網完全風乾。
- 裝卸濾網後請洗手。
- 請確認具兩個固定夾的一側朝向自己，且前層濾網的所有扣鉤皆已正確裝入空氣清淨機。

- 7 若要重新裝入正面護板，請先將護板頂部壓入空氣清淨機頂部 (1)。接著，輕輕將護板輕推入空氣清淨機機體 (2) (圖 9)。
- 8 將空氣清淨機的插頭插入電源插座。
- 9 按下  按鈕以開啟產品電源。
- 10 按住重設按鈕  3 秒以重設前層濾網清潔時間。
- 11 裝好濾網後，請徹底清潔雙手。

6 更換濾網

濾網更換指示器

本空氣清淨機配備了濾網更換指示燈，用以確認空氣清淨機運作時空氣淨化濾網處於最佳狀態。濾網需要更換時，螢幕會顯示濾網代碼 (請參閱濾網警示表)。



若未及時更換濾網，空氣清淨機會停止運作並自動鎖定，以保護房內的空氣品質。請根據濾網代碼盡速更換濾網。

更換濾網

備註

- 空氣濾網不得水洗或重複使用。
- 更換濾網前，請務必關閉空氣清淨機電源，再從電源插座拔掉插頭。
- 請勿使用吸塵器清潔濾網。
- 如果前層濾網損壞、磨損或破裂，則請勿使用。請造訪 www.philips.com/support 或聯絡您所在國家/地區的客戶服務中心。

濾網警示表

濾網警示燈狀態	動作
螢幕上會顯示 A3，且濾網更換警示燈  會亮起	更換納米級防護 HEPA S3 型濾網 (FY5185)
螢幕上會顯示 C7，且濾網更換警示燈  會亮起	更換納米級防護活性炭濾網 (FY5182)
螢幕上會顯示 A3 和 C7，且濾網更換警示燈  會亮起	更換兩個濾網

- 1 關閉空氣清淨機的電源，從電源插座拔掉插頭。
- 2 根據螢幕顯示的濾網警示燈狀態取出用過的空氣濾網。請丟棄用過的濾網 (圖 31)。

≡ 備註

- 請勿碰觸有皺摺的濾網表面或嗅聞濾網，因其收集了空氣中的污染物。

- 3 拆下新濾網的所有包裝材料 (圖 6)。
- 4 將新濾網裝至空氣清淨機 (圖 7)。
- 5 將空氣清淨機的插頭插入電源插座。
- 6 按住重設按鈕  3 秒鐘，可重設濾網使用壽命計數器。

≡ 備註

- 更換濾網後請清洗雙手。
- 此空氣清淨機沒有其他使用者可自行維修的零件。如需協助，請聯絡您所在國家/地區的客戶服務中心。



7 收納

- 1 關閉空氣清淨機的電源，從電源插座拔掉插頭。
- 2 清潔空氣清淨機、空氣品質感測器和前層濾網 (參閱「清潔」單元)。
- 3 收納之前，請確保所有零件徹底風乾。
- 4 將濾網和前層濾網分別包在氣密塑膠袋中。
- 5 將空氣清淨機、濾網和前層濾網存放在涼爽乾燥處。
- 6 接觸過濾網後，請務必徹底清洗雙手。

中文說明書

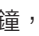
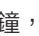

濾網重設

即使螢幕未顯示濾網更換代碼，您仍可以更換濾網。更換濾網後，您需要手動重設濾網使用壽命計數器。

- 1 同時按下  和  3 秒鐘，可進入濾網重設模式 (圖 32)。
↳ 螢幕會顯示納米級防護HEPA S3型濾網的代碼 (A3)。
- 2 按住  3 秒鐘，可強制重設納米級防護HEPA S3型濾網的濾網使用壽命計數器 (圖)。
- 3 在重設納米級防護HEPA S3型濾網的使用壽命計數器後，螢幕會顯示納米級防護活性炭濾網的代碼 (C7) (圖 34)。
- 4 按住  3 秒鐘，可強制重設納米級防護活性炭濾網的使用壽命計數器，並退出濾網重設模式 (圖 6)。

8 疑難排解

本單元概述您使用本產品時可能遇到的最常見問題。如果您無法利用以下資訊解決您遇到的問題，請聯絡您所在國家/地區的客戶服務中心。

問題	可能的解決方法
即使空氣清淨機已插電且電源已開啟，仍無法運作。	<ul style="list-style-type: none">請檢查上蓋是否正確安裝。濾網更換指示燈持續亮起，但卻未更換相應濾網，如今空氣清淨機已鎖定。在此情況下，請更換濾網並重設濾網壽命計數器。
出風口流出的風速比之前慢很多。	<ul style="list-style-type: none">前層濾網髒污。清潔前層濾網 (參閱「清潔」單元)。
即使空氣清淨機已經長時間運作，空氣品質仍未獲得改善。	<ul style="list-style-type: none">請檢查濾網外面的包裝材料是否已移除。其中一個濾網尚未裝在空氣清淨機中或濾網未妥善安裝。請確認所有濾網都已按照下列順序正確安裝，濾網從內至外分別為：1) 納米級防護HEPA S3型濾網 (FY5185)；2) 納米級防護活性碳濾網 (FY5182)；3) 前層濾網。空氣品質感測器潮溼。請確認空氣品質感測器乾淨且乾燥 (參閱「清潔」單元)。
空氣品質指示燈的顏色一直維持不變。	<ul style="list-style-type: none">空氣品質感測器髒污。清潔空氣品質感測器 (參閱「清潔」單元)。
空氣清淨機產生異味。	<ul style="list-style-type: none">使用本產品的前幾分鐘，可能會產生塑膠味。這是正常現象。然而，產品如果產生燒焦味，請聯絡飛利浦經銷商或飛利浦授權之服務中心。濾網使用一段時間之後，可能會因為吸收室內氣體而產生異味。取出濾網，放在陽光直射且通風良好處數小時。重新安裝，並嘗試再次使用產品。若仍會有味道，請更換濾網。
空氣清淨機聲音過大。	<ul style="list-style-type: none">如果空氣清淨機聲音過大，可將風速變更為較低的速度等級。夜間於臥室使用空氣清淨機時，請選擇睡眠模式。
空氣清淨機不斷要求更換濾網，但濾網已經更換了。	<ul style="list-style-type: none">您或許未重設濾網壽命計數器。將空氣清淨機插上電源，按下  開啟空氣清淨機的電源，然後按住重設按鈕  3 秒鐘 (參閱「濾網強制重設」一節)。
螢幕顯示「E1」錯誤代碼。	<ul style="list-style-type: none">產品馬達故障。請聯絡您所在國家/地區的客戶服務中心。
螢幕顯示錯誤代碼「E2」、「E3」、「E4」或「E5」。	<ul style="list-style-type: none">產品傳感器故障。請聯絡您所在國家/地區的客戶服務中心。

問題	可能的解決方法
我該下載哪個應用程式？	<ul style="list-style-type: none"> 前往App Store 或 Google Play 下載並安裝 Philips 「Clean Home+」 應用程式。
Wi-Fi 設定不成功。	<ul style="list-style-type: none"> 如果清淨機連接的路由器為雙波段，且目前並未連接至 2.4GHz 網路，請切換到相同路由器的另一個波段 (2.4GHz) 並嘗試再次配對您的清淨機。不支援 5GHz 網路。 不支援 Web 認證網路。 檢查清淨機是否位於 Wi-Fi 路由器的範圍內。您可以嘗試將空氣清淨機移近 Wi-Fi 路由器。 檢查網路名稱是否正確。網路名稱需區分大小寫。 檢查 Wi-Fi 密碼是否正確。密碼需區分大小寫。 請依照「在網路已變更時設定 Wi-Fi 連線」一節中的指示，重試設定。 Wi-Fi 連線可能受到電磁干擾或其他干擾而中斷。請讓本產品盡量遠離可能造成干擾的其他電子裝置。 檢查行動裝置是否處於飛航模式。連接至 Wi-Fi 網路時，請務必先停用飛航模式。 請參閱應用程式的說明章節，以深入掌握最新的疑難排解秘訣。

9 保固與服務

若您需要相關資訊，或是有任何問題，請造訪飛利浦網站：www.philips.com，或聯絡您所在國家/地區的飛利浦客戶服務中心（您可在全球保證書上找到電話號碼）。若當地沒有客戶服務中心，請洽詢當地的飛利浦經銷商。

訂購零件或配件

如果您必須更換零件或想購買其他零件，請聯絡您的飛利浦經銷商，或造訪 www.philips.com/support。

如果您有取得零件方面的問題，請聯絡您所在國家/地區的飛利浦客戶服務中心（您可在全球保證書上找到電話號碼）。

10 聲明

電磁場 (EMF)

本飛利浦產品符合所有電磁場暴露的相關適用標準和法規。

符合 EMF 標準

Koninklijke Philips N.V. 製造銷售多項消費性產品，這些產品就如同其他電器，通常能收發電磁訊號。

飛利浦的一大企業原則，就是針對自身的產品進行必要的健康與安全檢測，以符合所有適用的法律規定，以及在產品生產期間符合適用的 EMF 標準。

飛利浦致力於開發、生產及銷售不危害健康的產品。飛利浦保證，只要依照正確用途並妥善使用，根據現有的科學研究資料，使用本公司產品並無安全顧慮。

飛利浦積極參與國際 EMF 與安全標準的開發，因此得以掌握標準化的發展，及早將標準化與自身的產品整合。

回收

本產品使用壽命結束時，請勿與一般家庭廢棄物一併丟棄。請將該產品送至政府指定的回收點進行回收。此舉能為環保盡一份心力。

請遵循您所在國家/地區對電氣與電子產品分類收集的規定。正確處理廢棄產品有助於避免對環境和人類健康帶來負面影響。

注意

App Store 是 Apple Inc 的服務標章。

Google Play 是 Google Inc 的商標。

本飛利浦產品與 Clean Home+ 應用程式含有多個開放原始碼軟體，本產品使用的開放原始碼軟體授權文本副本可於此網站取得：www.philips.com/cleanhome。

低功率電波輻射性電機管理辦法

第十二條

經型式認證合格之低功率射頻電機，非經許可，公司、商號或使用者均不得擅自變更頻率、加大功率或變更原設計之特性以及功能。

第十四條

低功率射頻電機之使用不得影響飛航安全及干擾合法通信；經發現有干擾現象時，應立即停用，並改善至無干擾方得繼續使用。

前項合法通信，指依電信法規定作業之無線電通信。低功率射頻電機須忍受合法通信或工業、科學及醫療用電波輻射性電機設備之干擾。

設備名稱：飛利浦空氣清淨機， Equipment name		型號（型式）：AC5659 Type designation (Type)				
單元 Unit	限用物質及其化學符號 Restricted substances and its chemical symbols					
	鉛 Lead (Pb)	汞 Mercury (Hg)	鎘 Cadmium (Cd)	六價鉻 Hexavalent chromium (Cr ⁶⁺)	多溴聯苯 Polybrominated biphenyls (PBB)	多溴二苯醚 Polybrominated diphenyl ethers (PBDE)
氣體傳感器	—	○	○	○	○	○
傳感器電源轉接板	—	○	○	○	○	○
主電路板組件	—	○	○	○	○	○
電源電路板	—	○	○	○	○	○
馬達組件	—	○	○	○	○	○

備考1：“超出0.1 wt %”及“超出0.01 wt %”係指限用物質之百分比含量超出百分比含量基準值。
Note 1: “Exceeding 0.1 wt %” and “exceeding 0.01 wt %” indicate that the percentage content of the restricted substance exceeds the reference percentage value of presence condition.

備考2：“○”係指該項限用物質之百分比含量未超出百分比含量基準值。
Note 2: “○” indicates that the percentage content of the restricted substance does not exceed the percentage of reference value of presence.

備考3：“—”係指該項限用物質為排除項目。
Note 3: The “—” indicates that the restricted substance corresponds to the exemption.



