

PHILIPS

HD3081



EN User manual 1

ZH-S 简体中文 27



Contents

1	Important	4
	Safety	4
	Power failure backup function	7
	Electromagnetic fields (EMF)	7
2	Your Mini Rice Cooker with Induction Heating	8
	What's in the box	8
	Product overview	9
	Controls overview	10
3	Using your Mini Rice Cooker with Induction Heating	11
	Before first use	11
	Rice	11
	Grains and beans	13
	Claypot rice	13
	Porridge, Soup, Slow cook	14
	Steam	14
	Noodle	15
	Cake	16
	Reheat	17
	Adjusting the cooking time	17
	Preset time for delayed cooking	18
	Setting up My Favourite menu	18
4	Cleaning and Maintenance	20
	Inner lid and steam valve	20
	Interior	21
	Exterior	21
	Accessories and inner pot	21

5	Recycling	22
6	Guarantee and service	22
7	Specifications	22
8	Troubleshooting	23

1 Important

Please read this safety leaflet carefully before you use the Mini Rice Cooker with Induction Heating and save it for future reference.

Safety

Danger

- The appliance must not be immersed.

Warning

- This appliance shall not be used by children from 0 year to 8 years.
- This appliance can be used by children aged from 8 years and above if they are continuously supervised and they have been given supervision or instruction concerning use of the appliance in a safe way and understand the hazards involved.
- This appliance is not intended for use by persons (including children) with reduced physical, sensory or mental capabilities, or lack of experience and knowledge, unless they have been given

supervision or instruction concerning use of the appliance by a person responsible for their safety.

- Children should be supervised to ensure that they do not play with the appliance.
- Cleaning and user maintenance shall not be made by children unless they are older than 8 and supervised.
- Cooking appliances should be positioned in a stable situation with the handles (if any) positioned to avoid spillage of the hot liquids.
- This appliance is intended to be used in household and similar applications such as:
 - staff kitchen areas in shops, offices and other working environments;
 - farm houses;
 - by clients in hotels, motels and other residential type environments;
 - bed and breakfast type environments.

- If the power cord set is damaged, it must be replaced by a cord set available from the manufacturer.
- The appliance is not intended to be operated by means of an external timer or a separate remote-control system.
- Make sure to avoid spillage on the power connector to avoid a potential hazard.
- Always follow the instructions and use the appliance properly to avoid potential injury.
- Check if the voltage indicated on the appliance corresponds to the local power voltage before you connect it.
- According to the instructions prescribed in this user manual, use a soft damp cloth to clean the surfaces in contact with food and make sure to remove all the food residues stuck to the appliance.
- Do not let the power cord hang over the edge of the table or worktop on which the multi-cooker stands.
- Only connect the appliance to a grounded power outlet. Always make sure that the plug is inserted firmly into the power outlet.
- Do not use the appliance if the plug, the mains cord or the appliance itself is damaged.
- Make sure the heating element, the temperature sensor, and the outside of the inner pot are clean and dry before you put the plug in the power outlet.
- Do not plug in the appliance or press any of the buttons on the control panel with wet hands.
- Do not plug in the appliance or press any of the buttons on the control panel with wet hands.

Caution

- CAUTION: Surface of the heating element is subject to residual heat after use.
- Never use any accessories or parts from other manufacturers or that Philips does not

specifically recommend. If you use such accessories or parts, your guarantee becomes invalid.

- Do not expose the appliance to high temperatures, nor place it on a working or still hot stove or cooker.
- Do not expose the appliance to direct sunlight.
- Place the appliance on a stable, horizontal, and level surface.
- Always put the inner pot in the appliance before you put the plug in the power outlet and switch it on.
- Do not place the inner pot directly over an open fire to cook rice.
- Do not use the inner pot if it is deformed.
- The accessible surfaces may become hot when the appliance is operating. Take extra caution when touching the appliance.
- Beware of hot steam coming out of the steam vent during cooking or out of the appliance when you

open the lid. Keep hands and face away from the appliance to avoid the steam.

- Do not lift and move the appliance while it is operating.
- Do not exceed the maximum water level indicated in the inner pot to prevent overflow which might cause potential hazard.
- Do not place the cooking utensils inside the pot while cooking, keeping warm or reheating rice.
- Only use the cooking utensils provided. Avoid using sharp utensils.
- To avoid scratches, it is not recommended to cook ingredients with crustaceans and shellfish. Remove the hard shells before cooking.
- Do not insert metallic objects or alien substances into the steam vent.
- Do not place a magnetic substance on the lid. Do not use the appliance near a magnetic substance.

- Always let the appliance cool down before you clean or move it.
- Always clean the appliance after use. Do not clean the appliance in a dishwasher.
- Always unplug the appliance if not used for a longer period.
- If the appliance is used improperly or for professional or semiprofessional purposes, or if it is not used according to the instructions in this user manual, the guarantee becomes invalid and Philips refuses liability for any damage caused.

Power failure backup function

This appliance has a backup function that reserves the status before a power failure.

- If the power failure occurs during a cooking process, and the power supply is resumed within 30 minutes, the countdown of the cooking time continues where it is left off.
- If the power failure occurs when the appliance is at preset mode, and the power supply is resumed within 30 minutes, the countdown of the preset time continues where it is left off.
- If the power supply is not resumed within 30 minutes, the appliance might not continue with the previous working process, but stay in standby mode.

Electromagnetic fields (EMF)

This Philips appliance complies with all applicable standards and regulations regarding exposure to electromagnetic fields.

2 Your Mini Rice Cooker with Induction Heating

Congratulations on your purchase, and welcome to Philips! To fully benefit from the support that Philips offers, register your product at www.Philips.com.tw/welcome.

What's in the box

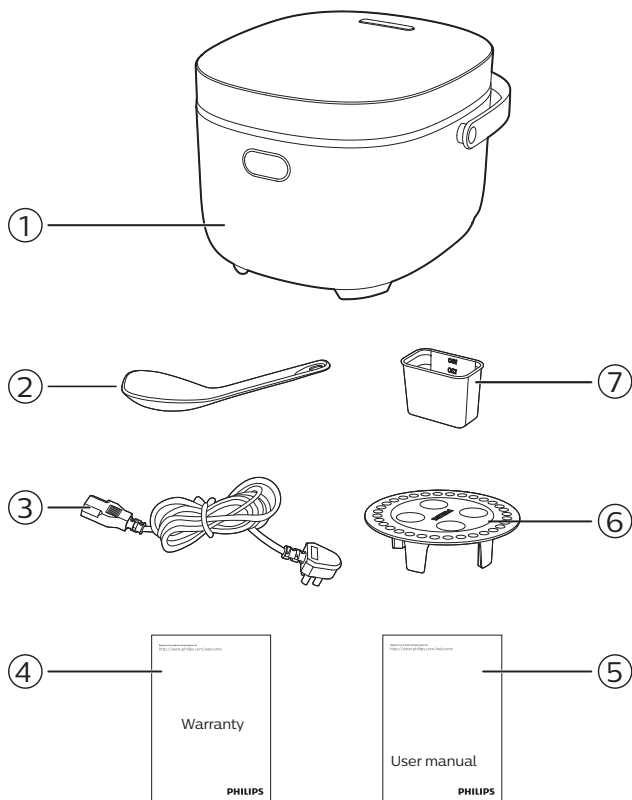

①	Main unit	⑤	User manual
②	Rice&Soup ladle	⑥	Steaming plate
③	Power cord	⑦	Measuring cup
④	Warranty card		

Product overview

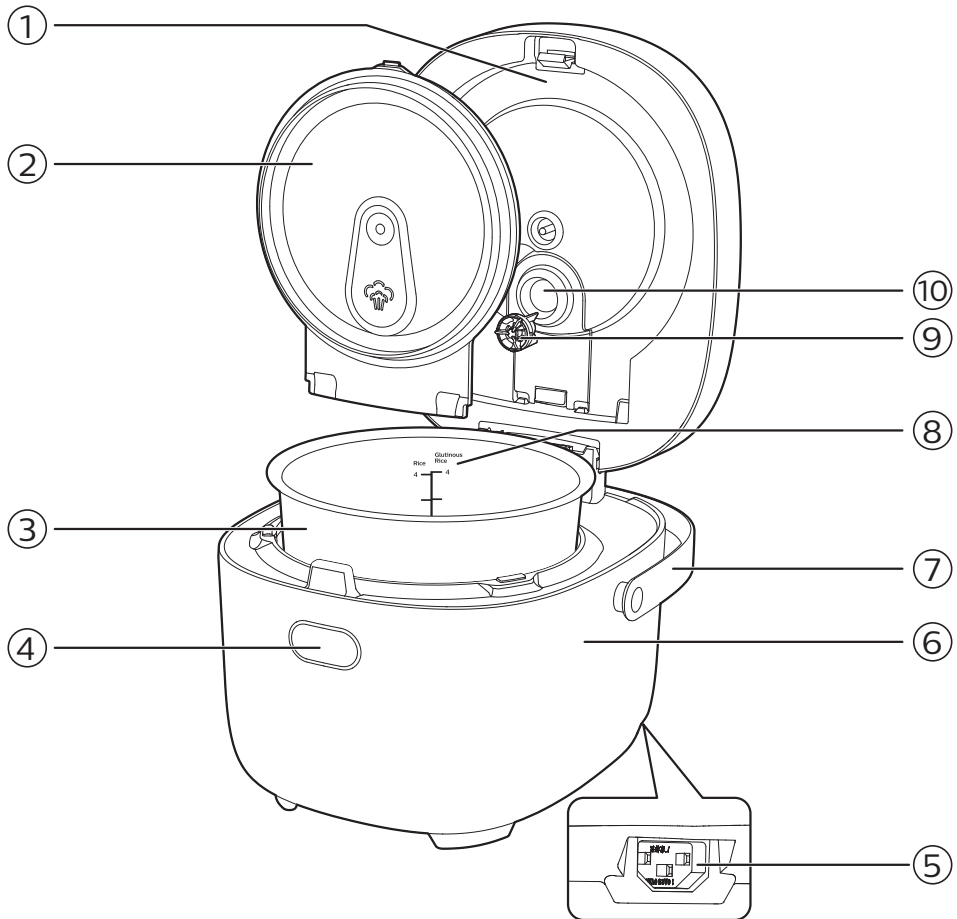

①	Top lid	⑥	Main unit
②	Detachable inner lid	⑦	Handle
③	Inner pot	⑧	Water level indication
④	Lid open button	⑨	Steam core
⑤	Power socket	⑩	Steam valve

Controls overview

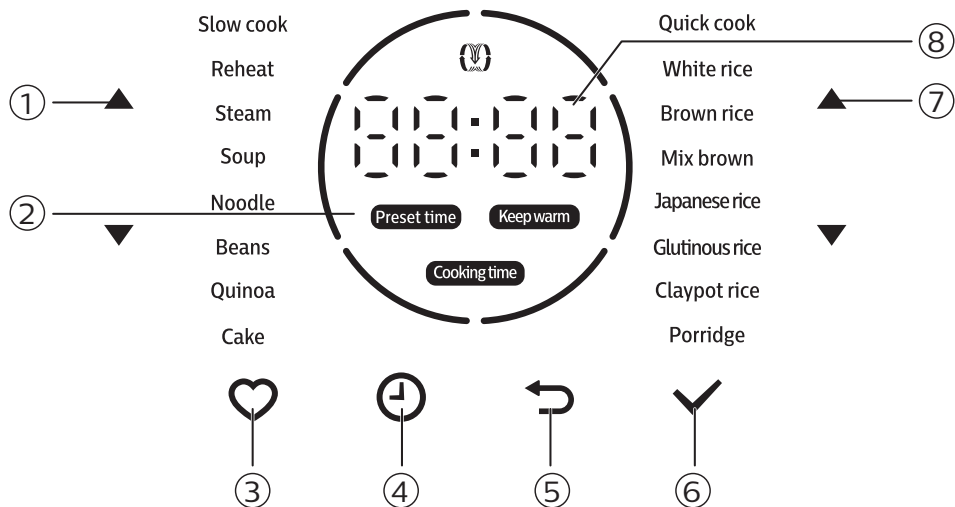

①	Menu/Time selection button	⑤	Cancel button
②	Control panel	⑥	Confirm/Start button
③	My favourite button	⑦	Menu/Time selection button
④	Cooking time/preset time button	⑧	Time display

3 Using your Mini Rice Cooker with Induction Heating



Tip

- After the cooking process is started, you can press  to terminate the current work, and the appliance goes to standby mode.



Note

- When opening the lid during cooking process (especially with large amount of water), wait for 1-2 minutes until the steam is released sufficiently.

Before first use

- 1 Take out all the accessories from the inner pot. Remove the packaging material of the inner pot.
- 2 Use boiled water to clean the appliance before first use.
- 3 Clean the parts of the rice cooker thoroughly before using the rice cooker for the first time (see chapter "Cleaning and Maintenance").



Note

- Make sure all parts are completely dry before you start using the rice cooker.

Rice

Menu	Default cooking time	Adjustable cooking time
Quick cook	25 mins	N/A
White rice	45 mins	N/A
Japanese rice	45 mins	N/A
Glutinous rice	45 mins	N/A

- 1 Measure the rice using the measuring cup provided.

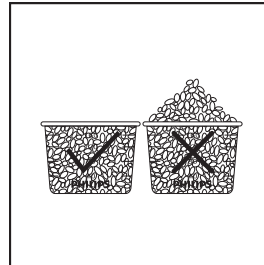

- 2 Wash the rice thoroughly, put the pre-washed rice in the inner pot.

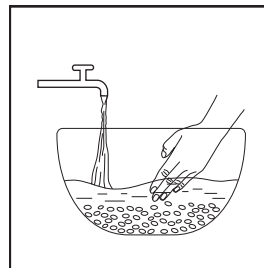

- 3 Add water to the level indicated on the scale inside the inner pot that corresponds to the number of cups of rice used. Then smooth the rice surface.

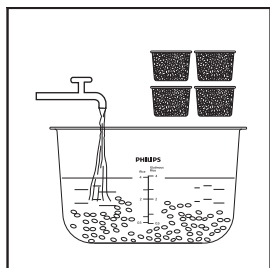

Note

- Do not exceed the volume indicated nor exceed the maximum water level indicated in the inner pot, as this may cause the rice cooker to overflow.
- The level marked inside the inner pot is just an indication. You can always adjust the water level for different types of rice and your own preference. If the voltage is unstable at the area you live, it is possible that the rice cooker overflows.

- 4 Wipe the outside of the inner pot dry, then put the inner pot in the rice cooker.

Note

- Make sure the outside of the inner pot is dry and clean, and that there is no foreign residue on the heating element.
- Make sure the inner pot is in proper contact with the heating element.

- 5 Close the lid, put the plug in the power socket.

- 6 Press ▲/▼ button to select the cooking menu you want.

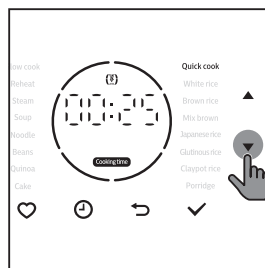

- 7 Press ✓ button to start the cooking process.

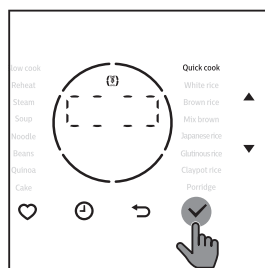

- 8 The appliance beeps after cooking is completed, and automatically switches to keep warm mode.
↔ button lights up.

Tip

- After the cooking process is finished, for better taste, loosen the rice as soon as possible.

Grains and beans

Menu	Default cooking time	Adjustable cooking time
Brown rice	50 mins	N/A
Mix brown	60 mins	N/A
Beans	90 mins	40-120mins
Quinoa	30 mins	N/A

- 1 Follow the steps 1-5 in "Rice".
- 2 Press ▲ / ▼ button to select the cooking menu you want.

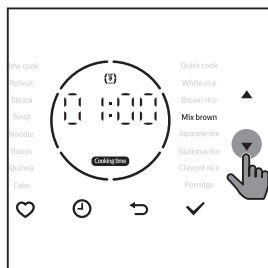

- 3 Press ✓ button to start the cooking process.

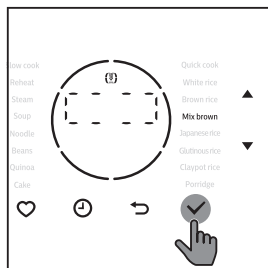

- 4 The appliance beeps after cooking is completed, and automatically switches to keep warm mode.
↪ ⏻ button lights up.

Claypot rice

Menu	Default cooking time	Adjustable cooking time
Claypot rice	60 mins	N/A

- 1 Follow the steps 1-5 in "Rice".
- 2 Press ▲ / ▼ button to select Claypot menu.

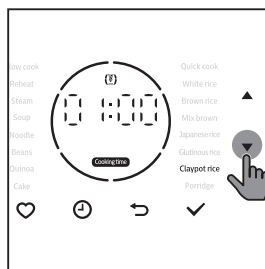

- 3 Press ✓ button to start the cooking process.

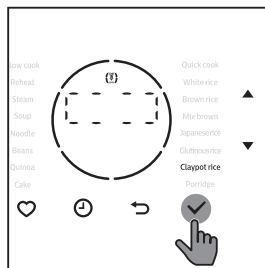

- 4 The appliance beeps after rice is finished cooking process.
- 5 Put ingredients into the pot, add oil over the pot edges, close the cover, the cooking process resumes.



- 6 The appliance beeps after cooking is completed, and automatically switches to keep warm mode.
 ↳ ⏪ button lights up.

Note

- It's normal that there is crispy rice under the bottom of the pot.

Porridge, Soup, Slow cook

Menu	Default cooking time	Adjustable cooking time
Slow cook	4 hrs	0.5-8 hrs
Soup	2 hrs	1-4 hrs
Porridge	1 hr	1-4 hrs

- 1 Put ingredients and water into the inner pot.
- 2 Wipe the outside of the inner pot dry, then put the inner pot in the rice cooker.
- 3 Close the lid, put the plug in the power socket.

- 4 Press ▲/▼ button to select **Slow cook**, **Soup** or **Porridge** function.

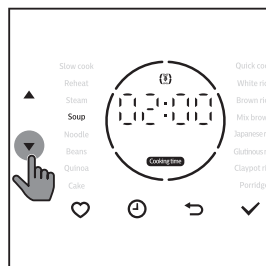

- 5 Press ✓ button to start the cooking process.

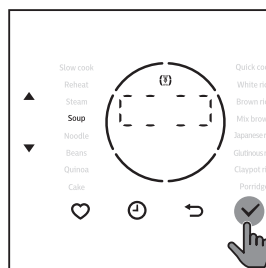

- 6 The appliance beeps after cooking is completed, and automatically switches to keep warm mode.
 ↳ ⏪ button lights up.

Steam

Menu	Default cooking time	Adjustable cooking time
Steam	25 mins	5-59 mins

- 1 Pour some water into the inner pot.
- 2 Put the steam basket into the inner pot.
- 3 Put the food on a plate or in the steam basket.
- 4 Close the lid, put the plug in the power socket.

- 5 Press ▲/▼ button to select **Steam** function.

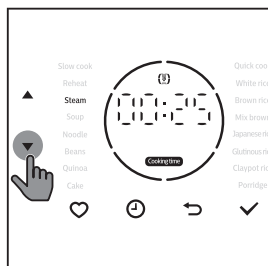

- 6 Press ✓ button to start the cooking process.

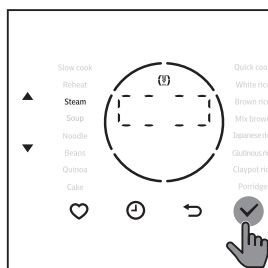

- 7 The appliance beeps after cooking is completed, and automatically switches to stand by mode.

Noodle

Menu	Default cooking time	Adjustable cooking time
Noodle	10 mins	5-20 mins

- 1 Pour some water to the inner pot.
- 2 Wipe outside of the inner pot dry, then put the inner pot in the Rice Cooker.
- 3 Close the lid of the Rice Cooker, put the plug in the power socket.

- 4 Press ▲/▼ button to select **Noodle** function.

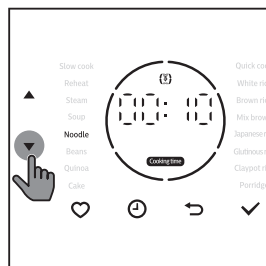

- 5 Press ✓ button to start the cooking process.

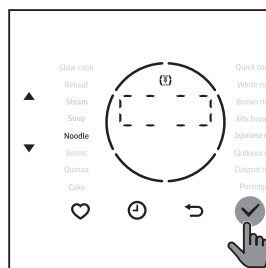

- 6 Countdown will be started after the water boils, the Rice Cooker beeps four times.
- 7 Open the lid, put the noodles into the inner pot. Keep the lid open until the cooking process is finished.

Note

- To avoid the water overflow or the noodles sticking together, always stir the noodles during cooking.
- The total amount of noodles and water cannot exceed the maximum water level indication on the inner pot, otherwise the Rice Cooker will have a slightly overflow.

- 8 When the cooking process is finished, the Rice Cooker beeps once and then switches to keep-warm mode automatically.

Cake

Menu	Default cooking time	Adjustable cooking time
Cake	45 mins	NA

- 1 Whisk the ingredients for cake well.
- 2 Coat the inner pot with some butter or cooking oil, and then pour the cake mixture into it.
- 3 Close the lid, put the plug in the power socket.
- 4 Press ▲ / ▼ button to select Cake function.

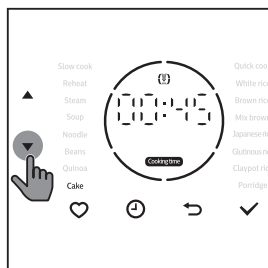

- 5 Press ✓ button to start the cooking process.

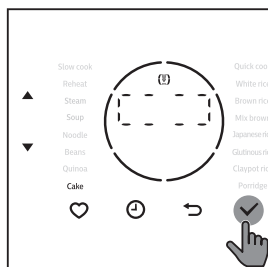

- 6 The appliance beeps after cooking is completed, and automatically switches to keep warm mode.
↔ button lights up.
- 7 Open the lid and carefully take out the inner pot to cool down.

- 8 After the inner pot has cooled down, put a plate on top of the pot, and then flip over to take the cake out.

Cake recipe

- 1 Ingredients:
 - Small amount
 - 3 medium eggs
 - 120g castor sugar (about 2/3 cup)
 - 100g cake mix flour (about 1 cup)
 - 50g butter (about 1/3 cup)
 - 18g milk (about 1/10 cup)
 - Large amount
 - 80g butter (about 2/3 cup)
 - 36g milk (about 2/5 cup)

Tip

- You can adjust the ratio of the ingredients according to personal taste.

- 2 Separate the egg white and egg yolk in two containers.
- 3 Add the castor sugar to the egg whites and beat till puffy and creamy, then add the egg yolks and stir.

Tip

- Use 40°C water to warm the egg if it's cold, so that the cake is soft and fluffy.
- The container and the egg beater must be clean and free from grease. Otherwise, the egg cannot be mixed. Do not stir in the inner pot to avoid damaging the non-sticky coating.

- 4 Add the cake mix flour and stir well.
- 5 Add milk and the melted butter (heat the butter until it melts), quickly stir the ingredients.

Reheat

Menu	Default cooking time	Adjustable cooking time
Reheat	25 mins	25-59 mins

- 1 Loosen the cooled rice and evenly distribute it in the inner pot.
- 2 Pour some water onto the rice to prevent it from becoming too dry. The quantity of the water depends on the amount of rice and your own preference.
- 3 Complete the steps 4-5 in "Rice".
- 4 Press **▲** / **▼** button to select **Reheat** function.

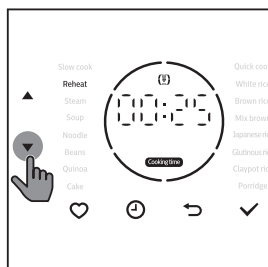

- 5 Press **✓** button to start the cooking process.

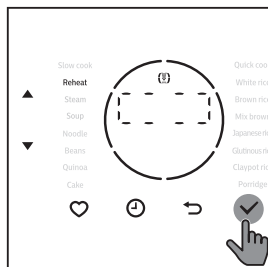

- 6 The appliance beeps after cooking is completed, and automatically switches to keep warm mode.
 ↳ **↶** button lights up.

Adjusting the cooking time

You can adjust the cooking time for **Porridge**, **Soup**, **Steam**, **Noodle**, **Slow cook**, **Reheat** and **Beans** functions.

- 1 Press **▲** / **▼** button to select the desired cooking function.
- 2 Press **⌚** button.
 ↳ Cooking time blinks on the screen.

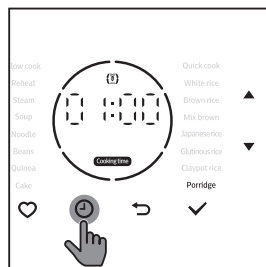

- 3 Press **▲** / **▼** button to choose the cooking time.

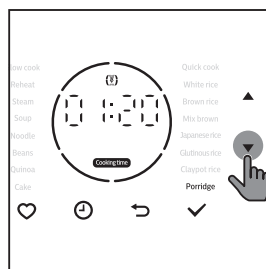

Tip

- Press **▲** / **▼** button on the left to adjust hour, press **▲** / **▼** button on the right to adjust minute.

- 4 Press  button to confirm the cooking time and start the cooking process.

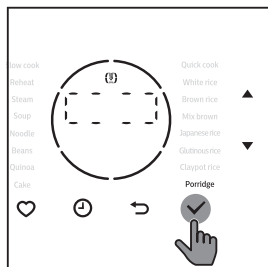

Preset time for delayed cooking

You can preset the delayed cooking time in different cooking modes except for **Steam**, **Noodle**, **Cake** and **Reheat** functions. The preset timer is available up to 24 hours.



Note

- For example. The current time is 20:00. If you want to enjoy your breakfast at 8:00 next morning, the preset time should be 12:00.
- If the preset time is shorter than cooking time, cook process starts immediately.

- 1 Choose a cooking function you need.
- 2 Press  button until **Preset time** lights up.

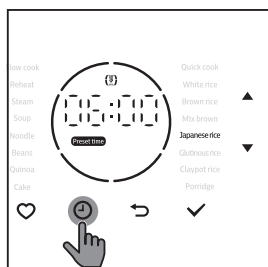

- 3 Press  /  button to choose the preset time.

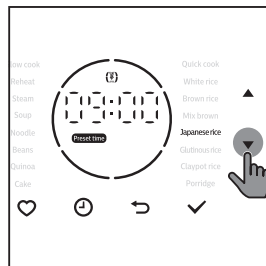

Tip

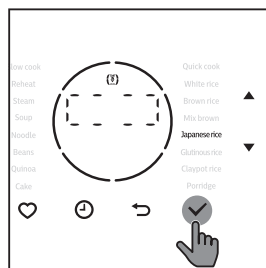

- Press  /  button on the left to adjust hour, press  /  button on the right to adjust minute.

- 4 Press  button to confirm. When preset time is elapsed, the Mini Rice Cooker with Induction Heating starts working in the selected cooking mode automatically.



Setting up My Favourite menu

You can set any three menus as "My Favourite". Before you make any changes to the setting, the default menus are **White Rice**, **Brown Rice** and **Porridge**.

- Tap  button one or more times, then press  button to access My favourite menus.

If you need to change the menu, follow the steps below:

- 1 Press ▲ / ▼ button to select the cooking function you want.

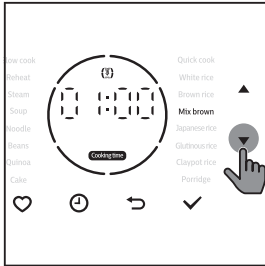

- 2 Press and hold ♥ button for 3 seconds.

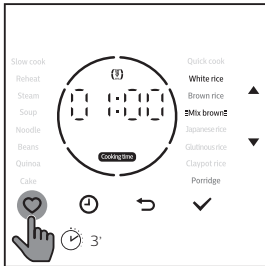

- 3 Press ♥ button to choose a menu you want to replace with.

↳ The menu lights up.

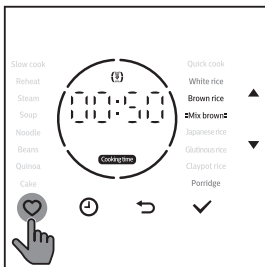

- 4 Press ✓ button, the current menu will be saved in My Favourite, the default menu is replace with this new one

↳ The newly saved menu is displayed on the screen.

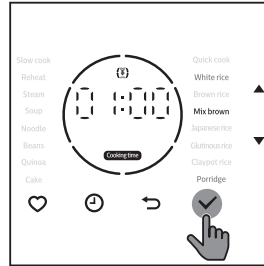

- 5 Follow the above steps, you can change other menus in My Favourite to the one you like.

Note

- If there are repeated menus in My Favourite, the repeated menu blinks twice when you press the ♥ button, but the cooking time will be different.

4 Cleaning and Maintenance

Note

- Unplug the Mini Rice Cooker with Induction Heating before starting to clean it.
- Wait until the Mini Rice Cooker with Induction Heating has cooled down sufficiently before cleaning it.
- Clean the inner lid regularly, or it will discolor and produce an unpleasant smell.
- Do not use steel wool or other hard objects to clean the inner pot and the lid.
- The sealing ring is undetachable.

Inner lid and steam valve

- Press the clip of the detachable inner lid (1) and remove it from the appliance (2).

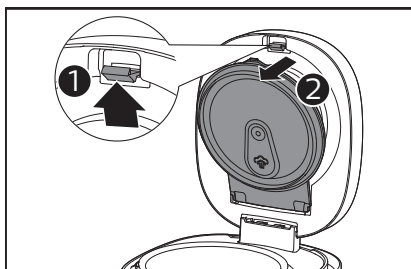

- Pull the steam value out from the appliance.

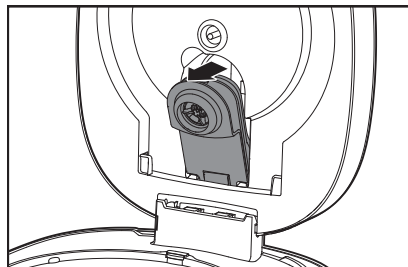

- Push downwards to remove the lock of the steam value and take the core out for clean.

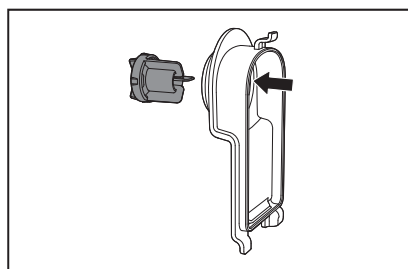
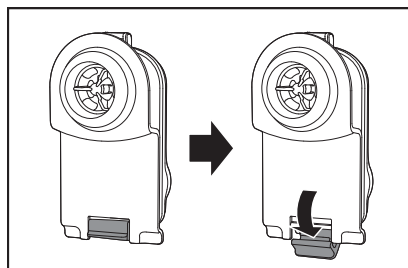

- To install the steam value, follow the illustration below.

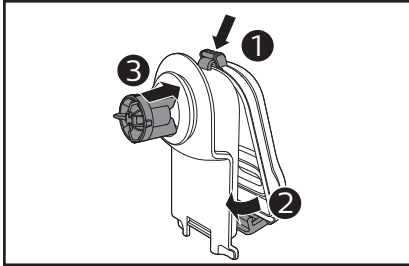

Note

- If the steam value is not properly installed, the appliance will leak. Always check the steam value before using.

Accessories and inner pot

Rice&Soup ladle, inner pot, steam plate and inner pot.

- Soak in hot water and clean with sponge.



Note

- Do not put the spoons, bowls or any other objects in the inner pot to prevent damage to the non-sticky coating.
- If condiments have been used in the inner pot, wash the pot immediately.

Interior

- Soak the detachable inner lid and steam valve in water, clean with sponge.
- Clean the interior of the appliance with damp cloth
- Make sure to remove all the food residues stuck to the rice cooker.

Exterior

- Wipe with a cloth dampened with soap water.
- Only use soft and dry cloth to wipe the control panel.
- Make sure to remove all the food residues around the control buttons.

5 Recycling

Do not throw away the product with the normal household waste at the end of its life, but hand it in at an official collection point for recycling. By doing this, you help to preserve the environment.

Follow your country's rules for the separate collection of electrical and electronic products. Correct disposal helps prevent negative consequences for the environment and human health.

6 Guarantee and service

If you need service or information, or if you have a problem, visit the Philips website at www.philips.com or contact the Philips Customer Care Center in your country. You can find its phone number in the worldwide guarantee leaflet. If there is no Customer Care Center in your country, go to your local Philips dealer.

7 Specifications

Model	HD3081
Rated power input	950 W
Rated capacity	2.0 L
Inner pot material (Metal or non-metal)	Metal

8 Troubleshooting

If you encounter problems when using this rice cooker, check the following points before requesting service. If you cannot solve the problem, contact the Philips Consumer Care Center in your country.

Problem	Solution
The rice is not cooked.	<ul style="list-style-type: none"> If the appliance is placed on an unstable or inclined surface, the cooked rice may taste too hard or too soft because the amount of water will be inconsistent.
	<ul style="list-style-type: none"> The taste of rice may vary depending on the brand, origin and storage time.
	<ul style="list-style-type: none"> The taste of rice may differ due to the room temperature and water temperature.
	<ul style="list-style-type: none"> Preset cooking function may soften the rice. This is normal.
	<ul style="list-style-type: none"> If you use the Quick cook function, it's normal that the rice is hard.
	<ul style="list-style-type: none"> Check if the inner pot is deformed.
	<ul style="list-style-type: none"> There is not enough water. Add water according to the scale on the inside of the inner pot.
The rice is scorched.	<ul style="list-style-type: none"> Make sure that there is no foreign residue on the heating element and the outside of the inner pot before switching the rice cooker on.
	<ul style="list-style-type: none"> Make sure that there is no foreign residue on the inside and outside of the inner pot. Clean the food residue.
	<ul style="list-style-type: none"> You have not rinsed the rice properly. Rinse the rice until water runs clear.
	<ul style="list-style-type: none"> Check if the inner pot is deformed.

Problem	Solution
Water spills out of the rice cooker during cooking.	<ul style="list-style-type: none"> • Cut off the power immediately. Make sure that you add water to the level indicated on the scale inside the inner pot that corresponds to the number of cups of rice used. <hr/> <ul style="list-style-type: none"> • Make sure the water does not exceed the next level on the scale, as this may cause the appliance to overflow during cooking. <hr/> <ul style="list-style-type: none"> • Make sure the ratio of foods/rice and water matches the cooking function.
I cannot find the cooking function I need.	<ul style="list-style-type: none"> • Press ▲ / ▼ to choose the function you need. <hr/> <ul style="list-style-type: none"> • Check if the keep warm indicator lights up or not. Cancel the keep warm function and re-try. <hr/> <ul style="list-style-type: none"> • Check if the power cord is connected to the appliance, and the power plug is well plugged to the power socket.
Rice smells bad after cooking.	<ul style="list-style-type: none"> • Clean the inner pot with some washing detergent and warm water.
The display panel is not working.	<ul style="list-style-type: none"> • The Rice Cooker is not connected to the power. If there is no power, the display panel will not work.
There is air leakage.	<ul style="list-style-type: none"> • Check if the steam valve is well assembled. If it's not properly installed, there will be air leakage.
No response after pressing ▲ / ▼ button or other buttons.	<ul style="list-style-type: none"> • Check if there is power supply of your power grid, and connections amongs the power cord, power plug and the power socket. <hr/> <ul style="list-style-type: none"> • Use the rice cooker correctly according to the user manual. <hr/> <ul style="list-style-type: none"> • If you cannot handle it yourself, do not disassemble the appliance, take the appliance to your Philips dealer or a service center authorized by Philips.

Problem	Solution
The appliance does not switch to keep warm mode automatically.	<ul style="list-style-type: none"> You don't choose the right cooking mode. For example, you choose the rice function when you want to cook porridge.
	<ul style="list-style-type: none"> Some of the menus don't have keep warm function, when cooking process is completed, the appliance goes to standby mode.
	<ul style="list-style-type: none"> The temperature control is defective. Take the appliance to your Philips dealer or a service center authorized by Philips.
Error message (E5 or E6) displays on the screen.	<ul style="list-style-type: none"> Please check with a professional whether the product is working under the normal voltage range.
	<ul style="list-style-type: none"> Check if too many appliances are using the power socket at the same time or the extension cable is too long.
	<ul style="list-style-type: none"> If you cannot handle it yourself, do not disassemble the appliance, take the appliance to your Philips dealer or a service center authorized by Philips.
Error message (E7) displays on the screen.	<ul style="list-style-type: none"> Check if there are foreign objects on the bottom air inlet.
	<ul style="list-style-type: none"> Check if ambient temperature is too high.
	<ul style="list-style-type: none"> After the error code displays on the screen, the appliance will automatically shut down. If it can work normally after cooling down for a while. It means the appliance displays the error code to protect itself from overheating.
	<ul style="list-style-type: none"> If you cannot handle it yourself, do not disassemble the appliance, take the appliance to your Philips dealer or a service center authorized by Philips.

Problem	Solution
Error message (E14) displays on the screen.	<ul style="list-style-type: none"> • Check if there is no water or less water in the inner pot.
	<ul style="list-style-type: none"> • Check if the inner pot is overheated.
	<ul style="list-style-type: none"> • Shut down the appliance, take the inner pot out for cooling down for a while. The appliance will resume normal.
	<ul style="list-style-type: none"> • If you cannot handle it yourself, do not disassemble the appliance, take the appliance to your Philips dealer or a service center authorized by Philips.
The appliance stops heating during use and other error code displays.	<ul style="list-style-type: none"> • Power malfunction during use. Take the appliance to your Philips dealer or a service center authorized by Philips.

目录

1 重要事项	28
安全	28
电源故障备份功能	30
电磁场 (EMF)	30
2 IH电磁加热迷你电饭煲	31
包装盒内物品	31
产品概述	32
控件概述	33
3 使用IH电磁加热迷你电饭煲	34
首次使用之前	34
米饭	34
谷物和豆类	35
煲仔饭	36
粥、煲汤、慢炖	36
蒸煮	37
面条	37
蛋糕	38
再加热	39
调整烹饪时间	39
延长烹饪的预设时间	40
设置“我的最爱”菜单	41
4 清洁与保养	42
内盖和蒸汽阀	42
内部	43
外部	43
附件和内锅	43

5 回收	43
6 保修与服务	43
7 规格	43
8 故障排除	44

1 重要事项

在使用IH电磁加热迷你电饭煲之前，请仔细阅读本安全手册，并妥善保管以备日后参考。

安全

危险

- 不得将产品浸入水中。

警告

- 0 至 8 岁的儿童不得使用本产品。
- 本产品适合由 8 岁及以上年龄的儿童使用，但前提是有人对其进行持续照看，并对其使用本产品进行监督或指导，以确保他们安全使用，并且让他们明白相关的危害。
- 本产品不适合由肢体不健全、感觉或精神上有障碍或缺乏相关经验和知识的人（包括儿童）使用，除非有负责其安全的人对他们使用本产品进行监督或指导。
- 应照看好儿童，确保他们不玩耍本产品。
- 不要让儿童进行清洁和保养，除非儿童已年满 8 周岁且在有人监督的情况下操作。
- 应用手柄（如有）将烹饪产品稳固放置，以避免高温液体溢漏。

- 本产品仅打算用于家用及类似用途，如：
 - 商店、办公场所及其它工作环境的厨房；
 - 农庄；
 - 由旅店、旅馆及其它住宿型环境中的客人使用；
 - 提供住宿和早餐的场所。
- 如果电源线组损坏，必须使用制造商提供的电源线组进行更换。
- 本产品不能利用外部定时器或独立的遥控器系统操作。
- 确保防止液体溢漏到电源连接器上，以免造成潜在危险。
- 务必遵循说明并正确使用产品，以避免潜在的人身伤害。
- 在产品通电之前，请先检查本产品上所标的电压与当地的供电电压是否相符。
- 根据本用户手册中的说明，使用柔软湿布清洁与食物接触的表面，并确保清除粘在产品上的所有食物残渣。
- 请勿将电源线悬挂在放置多功能电饭煲支架的桌子或工作台的边缘。
- 本产品只能使用带接地线的插座。务必确保插头牢固插到电源插座上。
- 如果插头、电源线或产品本身受损，请勿使用本产品。

- 将插头接入电源插座之前，应确保加热元件、温度传感器和内锅外侧是洁净、干燥的。
- 请勿用浸湿的手插接产品插头或按控制面板上的任何按键。
- 请勿用浸湿的手插接产品插头或按控制面板上的任何按键。
- 小心煮饭期间从蒸汽孔排出的热蒸汽或在打开盖子时从产品中冒出的热蒸汽。双手和脸不要靠近本产品，以免蒸汽烫伤。
- 运行期间，切勿提起及移动本产品。
- 请勿超出内锅中标注的最高水位标示，以免溢水，这可能造成潜在危险。
- 切勿在煮饭、保温或重新热饭时将烹饪器具放入锅中。
- 仅使用随附的烹饪器具。不要使用尖利的器具。
- 为免刮擦，建议您不要烹饪含虾蟹和贝类的食材。烹饪前去掉坚壳。
- 切勿将金属物体或异物插入蒸汽孔。
- 不要将磁性物质放在盖上。不要在靠近磁性物质的地方使用本产品。
- 一定要先让产品冷却，才能进行清洁或移动。
- 每次使用后应清洁产品。请勿用洗碗机清洗产品。
- 如果长时间不用，务必拔掉产品插头。
- 对本产品使用不当，或者将其用于专业、半专业用途，或者没有根据本用户手册中的说明进行使用，此类情况下保修将失效，飞利浦对此类损坏概不负责。

警告

- 警告：使用后，加热元件表面仍有余热。
- 切勿使用由其他制造商生产或未经飞利浦特别推荐的任何附件或部件。如果使用此类附件或部件，您的保修将失效。
- 切勿将产品暴露在高温之下，也不要将电饭煲放在正在工作或仍然发热的炉具或炊具上。
- 切勿将产品直接曝晒于阳光下。
- 将本产品放在稳固、水平且平坦的表面。
- 在将插头插入电源插座并打开产品之前，请务必先将内锅放入产品中。
- 不要将内锅直接放在火上煮饭。
- 如果内锅已变形，请勿使用。
- 产品在使用时，表面会变得很热。接触产品时，请注意。

电源故障备份功能

本产品具有备份功能，可保留发生电源故障之前的状态。

- 如果在烹饪过程中发生电源故障，并且在 30 分钟内恢复供电，则烹饪时间倒计时将从中断处继续。
- 如果在产品处于预设模式时发生电源故障，并且在 30 分钟内恢复供电，则预设时间倒计时将从中断处继续。
- 如果在 30 分钟内未恢复供电，则产品不会继续执行之前的工作过程，而是保持待机模式。

电磁场 (EMF)

本飞利浦产品符合所有有关暴露于电磁场的适用标准和法规。

2 IH电磁加热迷你电饭煲

感谢您的惠顾，欢迎光临飞利浦！为了您能充分享受飞利浦提供的支持，请在以下网站注册您的产品：www.Philips.com.tw/welcome。

包装盒内物品

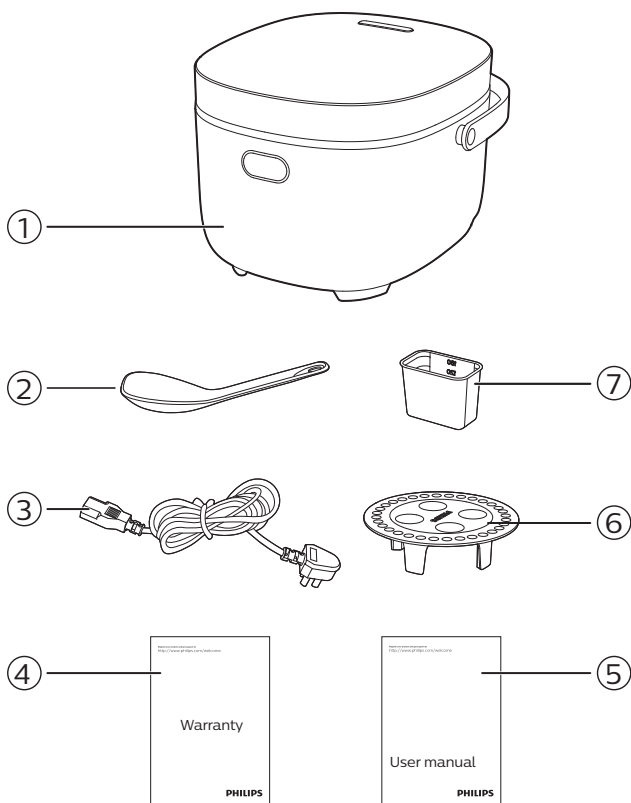

①	主体	⑤	用户手册
②	二合一饭汤勺	⑥	蒸架
③	电源线	⑦	量杯
④	保修卡		

产品概述

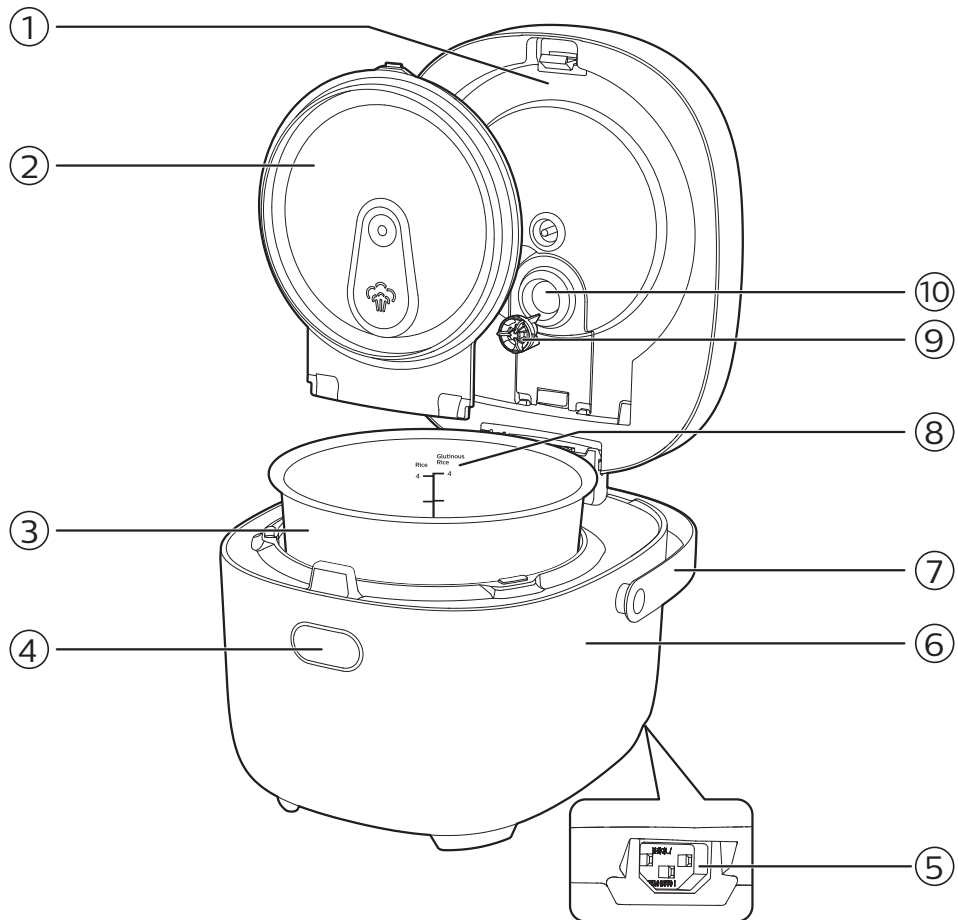

①	上盖	⑥	主体
②	可拆除内盖	⑦	提手
③	内胆	⑧	水位指示线
④	开盖键	⑨	蒸汽阀阀芯
⑤	电源插孔	⑩	蒸汽阀

控件概述

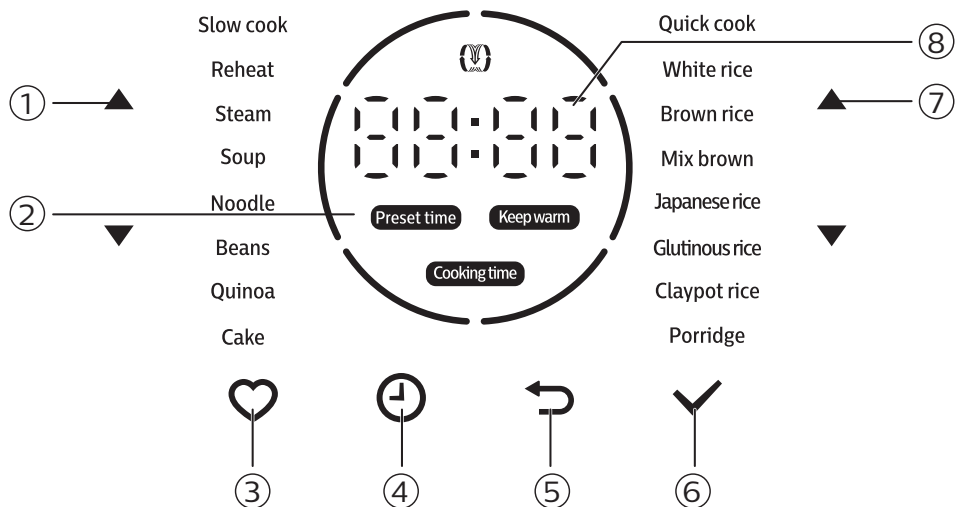

①	菜单/时间选择键	⑤	取消键
②	控制面板	⑥	确认/开始键
③	我的最爱键	⑦	菜单/时间选择键
④	烹饪时间/预设时间键	⑧	时间显示屏

3 使用IH电磁加热 迷你电饭煲

✱ 提示

- 烹饪过程开始后，您可以轻触  终止当前工作，产品会进入待机模式。

≡ 注意

- 在烹饪过程中开盖时（尤其是盛装有大量水时），请等待 1 - 2 分钟，直至蒸汽充分释放。

首次使用之前

- 1 从内锅中取出所有附件。拆除内锅的包装材料。
- 2 首次使用前，请煮沸水彻底清洗产品。
- 3 首次使用前，请彻底清洁电饭煲的部件（请参阅“清洁与保养”一章）。

≡ 注意

- 开始使用之前，确保所有电饭煲部件均已完全干燥。

米饭

菜单	默认烹饪时间	可调节的烹饪时间
快煮	25 分钟	不适用
白米饭	45 分钟	不适用
寿司米	45 分钟	不适用
糯米	45 分钟	不适用

- 1 使用附带的量杯量米。

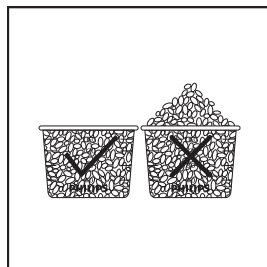

- 2 将米洗净，将淘好的米倒入内锅。

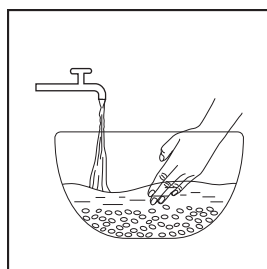

- 3 根据所倒入米的杯数，依照内锅上标明的相应水位标记加入适量的水。然后将米抚平。

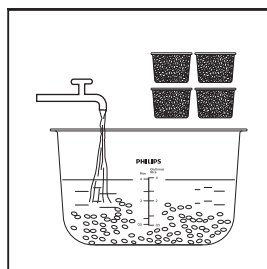

≡ 注意

- 请勿超过内锅中标注的量，也不要超过最高水位标示，否则可能导致电饭煲溢出。
- 内锅的水位标记只是一个参考。您始终可以根据米的品种及个人喜好调整水位。如果您居住的区域电压不稳定，电饭煲可能溢出。

- 4 擦干内锅外侧，然后将内锅放入电饭煲。

注意

- 请确保内胆的外表面洁净且干燥，并且没有其他杂物黏附在加热元件上。
- 确保内锅已正确接触加热元件。

- 5 合上电饭煲的盖子，将插头插入插座。
- 6 轻触 ▲ / ▼ 键可选择所需的烹饪菜单。

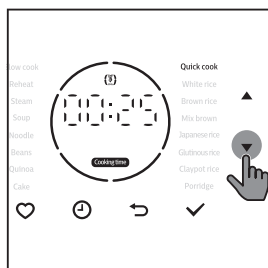

- 7 轻触 ✓ 键可开始烹饪过程。

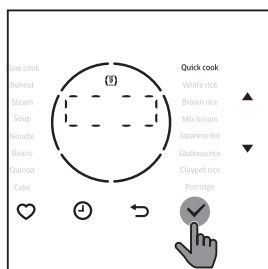

- 8 烹饪完成后，产品会发出蜂鸣音，并自动切换至保温模式。

↔ 键亮起。

提示

- 烹饪过程结束后，为了获得更佳口感，请尽快将米饭打散。

谷物和豆类

菜单	默认烹饪时间	可调节的烹饪时间
糙米	50 分钟	不适用
半糙米饭	60 分钟	不适用
豆类	90 分钟	40 - 120 分钟
藜麦	30 分钟	不适用

- 1 按照“煮饭”中的步骤 1 - 5 进行操作。

- 2 轻触 ▲ / ▼ 键可选择所需的烹饪菜单。

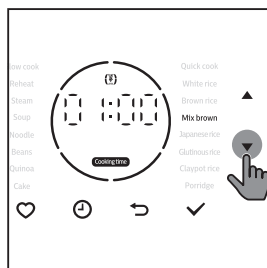

- 3 轻触 ✓ 键可开始烹饪过程。

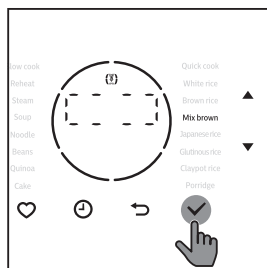

- 4 烹饪完成后，产品会发出蜂鸣音，并自动切换至保温模式。

↔ 键亮起。

煲仔饭

菜单	默认烹饪时间	可调节的烹饪时间
煲仔饭	60 分钟	不适用

- 1 按照“煮饭”中的步骤 1 - 5 进行操作。
- 2 轻触 ▲ / ▼ 键选择“煲仔饭”菜单。

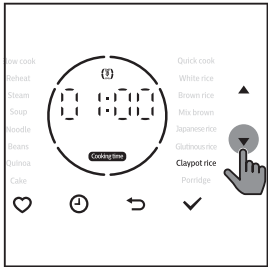

- 3 轻触 ✓ 键可开始烹饪过程。

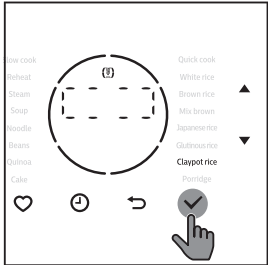

- 4 米饭煮好后，产品会发出蜂鸣音。
- 5 将原料放入锅中，在锅边加油，盖上盖子，烹饪过程会继续进行。



- 6 烹饪完成后，产品会发出蜂鸣音，并自动切换至保温模式。
- ↶ ↷ 键亮起。

注意

- 锅底下有锅巴是正常现象。

粥、煲汤、慢炖

菜单	默认烹饪时间	可调节的烹饪时间
慢炖	4 小时	0.5 - 8 小时
煲汤	2 小时	1-4 小时
粥	1 小时	1-4 小时

- 1 将原料和水放入内锅。
- 2 擦干内锅外侧，然后将内锅放入电饭煲。
- 3 合上电饭煲的盖子，将插头插入插座。
- 4 轻触 ▲ / ▼ 键可选择慢炖、煲汤或粥功能。

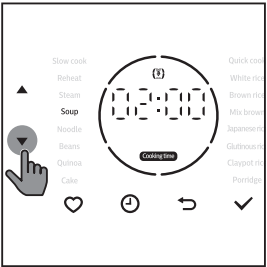

- 5 轻触 ✓ 键可开始烹饪过程。

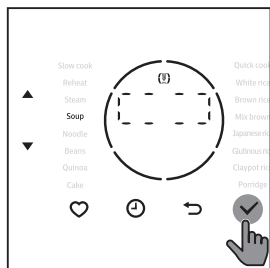

- 6 轻触 ✓ 键可开始烹饪过程。

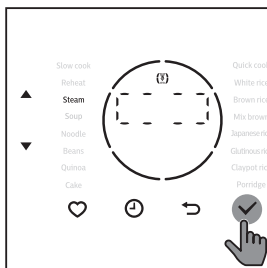

- 6 烹饪完成后，产品会发出蜂鸣音，并自动切换至保温模式。
↪ ⏻ 键亮起。

- 7 烹饪完成后，产品会发出蜂鸣音，并自动切换至待机模式。

蒸煮

菜单	默认烹饪时间	可调节的烹饪时间
蒸煮	25 分钟	5 - 59 分钟

- 1 将一些水倒入内锅。
- 2 将蒸篮放入内锅。
- 3 将食物放在蒸架上或蒸篮中。
- 4 合上电饭煲的盖子，将插头插入插座。
- 5 轻触 ▲ / ▼ 键可选择蒸煮功能。

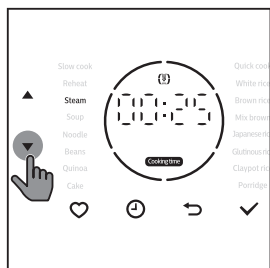

面条

菜单	默认烹饪时间	可调节的烹饪时间
面条	10 分钟	5 - 20 分钟

- 1 将一些水倒入内锅。
- 2 擦干内锅外侧，然后将内锅放入电饭煲。
- 3 合上电饭煲的盖子，将插头插入插座。
- 4 轻触 ▲ / ▼ 键可选择面条功能。

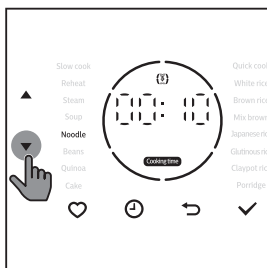

5 轻触 ✓ 键可开始烹饪过程。

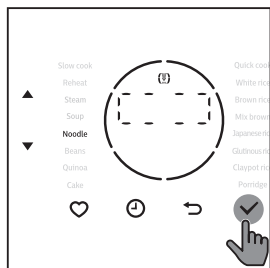

6 水开后将开始倒计时，电饭煲会发出四声蜂鸣音。

7 打开锅盖，将面条放入内锅。让锅盖一直开着，直至烹饪过程完成。

注意

- 为避免水溢出或面条粘在一起，请在烹饪过程中始终搅拌面条。
- 面条和水的总量不能超过内锅上的最高水位标示，否则电饭煲会出现轻微溢出。

8 烹饪过程完成后，电饭煲会发出一声蜂鸣音，然后自动切换至保温模式。

蛋糕

菜单	默认烹饪时间	可调节的烹饪时间
蛋糕	45 分钟	不适用

- 1 搅拌好蛋糕原料。
- 2 用少许黄油涂抹内锅，然后将蛋糕预拌粉倒入其中。
- 3 合上电饭煲的盖子，将插头插入插座。

4 轻触 ▲ / ▼ 键可选择蛋糕功能。

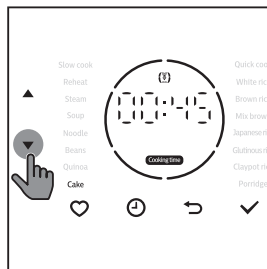

5 轻触 ✓ 键可开始烹饪过程。

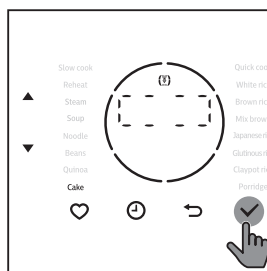

6 烹饪完成后，产品会发出蜂鸣音，并自动切换至保温模式。

↔ 键亮起。

7 打开锅盖，小心地取出内锅以进行冷却。

8 待内锅冷却后，将盘子放在锅上，然后翻转过来即可取出蛋糕。

蛋糕食谱

1 原料：

- 少量
 - 3 枚中等大小的鸡蛋
 - 120 克细白砂糖（约 2/3 杯）
 - 100 克蛋糕预拌粉（约 1 杯）
 - 50 克黄油（约 1/3 杯）
 - 18 克牛奶（约 1/10 杯）
- 大量
 - 80 克黄油（约 2/3 杯）
 - 36 克牛奶（约 2/5 杯）

提示

- 您可以根据个人口味调整原料的比例。

- 将蛋清和蛋黄分别放入两个容器。
- 将细白砂糖加入蛋清中，打至松软细腻，然后加入蛋黄并搅拌。

提示

- 如果鸡蛋很凉，请使用 40°C 水进行加热，这样做出的蛋糕柔软又蓬松。
- 容器和打蛋器必须清洁且无油脂。否则，鸡蛋便无法打成乳状。请勿在内锅中搅拌，以免损坏不粘涂层。

- 添加蛋糕预拌粉，搅拌均匀。
- 加入牛奶和融化的黄油（将黄油加热至融化状态），快速搅拌原料。

再加热

菜单	默认烹饪时间	可调节的烹饪时间
再加热	25 分钟	25 - 59 分钟

- 翻松冷饭并将其均匀地分布在锅内。
- 在饭中倒入一些水以避免饭太干。水量取决于米饭量 and 您自己的喜好。
- 完成“煮饭”中的步骤 4 - 5。

- 轻触 ▲ / ▼ 键可选择再加热功能。

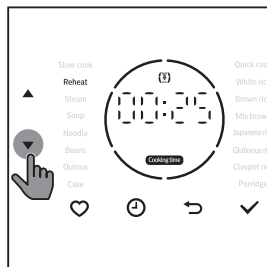

- 轻触 ✓ 键可开始烹饪过程。

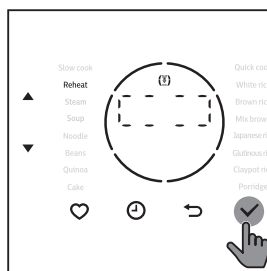

- 烹饪完成后，产品会发出蜂鸣音，并自动切换至保温模式。
↔ 键亮起。

调整烹饪时间

您可以调整粥、煲汤、蒸煮、面条、慢炖、再加热和豆类功能的烹饪时间。

- 轻触 ▲ / ▼ 键可选择所需的烹饪功能。
- 轻触 ⌚ 键。
↔ 烹饪时间会在屏幕上闪烁。

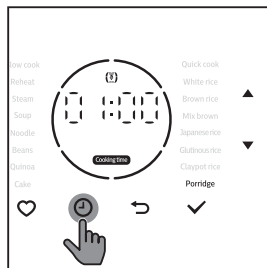

3 轻触 ▲/▼ 键可选择烹饪时间。

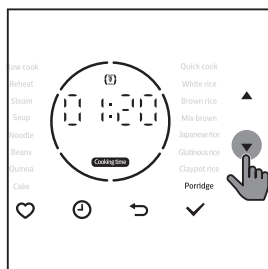

* 提示

- 轻触左侧的 ▲/▼ 键可调整小时，轻触右侧的 ▲/▼ 键可调整分钟。

4 轻触 ✓ 键可确认烹饪时间并开始烹饪过程。

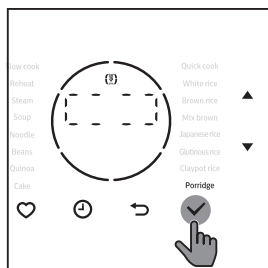

延长烹饪的预设时间

您可以在除蒸煮、面条、蛋糕和再加热功能以外的不同烹饪模式下预设延迟烹饪时间。预设计时器最长可达 24 小时。

≡ 注意

- 例如，当前时间为 20:00。如果您想在第二天早上 8:00 享用早餐，则预设时间应为 12:00。
- 如果预设时间比烹饪时间短，则烹饪过程会立即开始。

1 选择所需烹饪功能。

2 轻触 ⌚ 键，直至预设时间亮起。

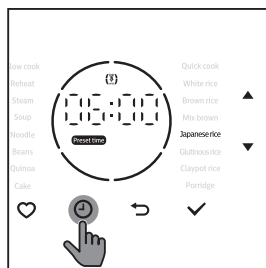

3 轻触 ▲/▼ 键可选择预设时间。

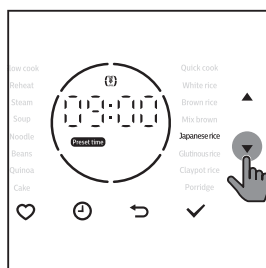

* 提示

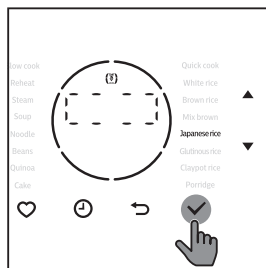

- 轻触左侧的 ▲/▼ 键可调整小时，轻触右侧的 ▲/▼ 键可调整分钟。

4 轻触 ✓ 键确认。当预设时间结束后，IH电磁加热迷你电饭煲将自动在选定的烹饪模式下开始工作。



设置“我的最爱”菜单

您可以将任意三个菜单设置为“我的最爱”。在对设置进行任何更改之前，默认菜单为**白米饭**、**糙米饭**和**粥**。

- 一次或多次轻触  键，然后轻触  键可访问“我的最爱”菜单。

如需更改菜单，请执行以下步骤：

- 轻触  /  键可选择所需的烹饪功能。

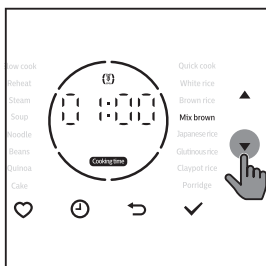

- 轻触  键 3 秒。

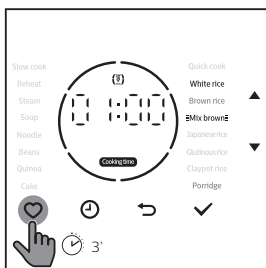

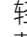
- 轻触  键可选择要用于替换的菜单。

→ 该菜单将亮起。

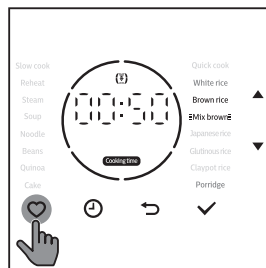

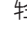
- 轻触  键，当前菜单将保存在“我的最爱”中，默认菜单将被替换为此新菜单

→ 新保存的菜单将显示在屏幕上。

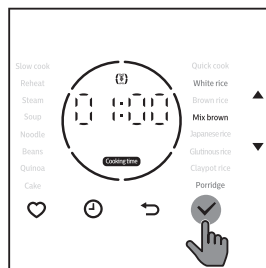

- 按照上述步骤操作，您可以将“我的最爱”中的其他菜单更改为您喜欢的菜单。

注意

- 如果“我的最爱”中有重复的菜单，则当您轻触  键时，重复的菜单会闪烁两次，但烹饪时间会有所不同。

4 清洁与保养

注意

- 开始清洁前，请拔下IH电磁加热迷你电饭煲的插头。
- 清洁前，请等到IH电磁加热迷你电饭煲充分冷却。
- 定期清洁内盖，否则其会变色并产生难闻气味。
- 请勿使用钢丝球或其他硬物清洁内锅和内盖。
- 密封圈不可拆卸。

内盖和蒸汽阀

- 按可拆卸内盖的固定夹 (1)，然后将其从产品中取出 (2)。

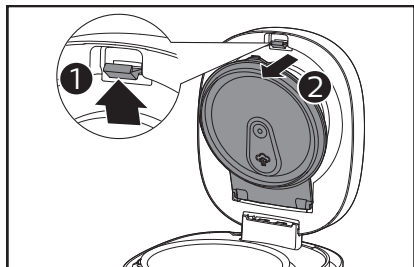

- 将蒸汽阀从产品中拉出。

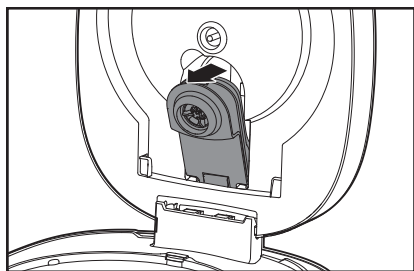

- 向下推以解除蒸汽阀的锁定，然后取出阀芯进行清洁。

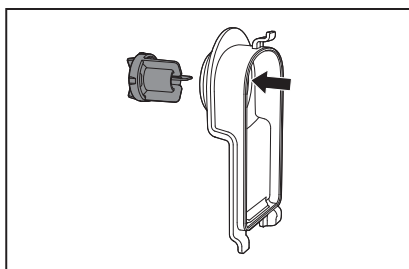
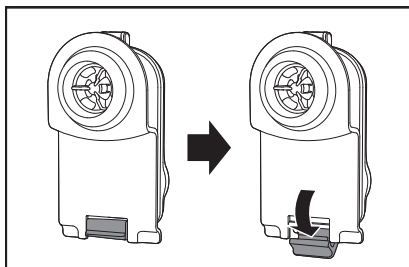

- 要安装蒸汽阀，请按照下图进行操作。

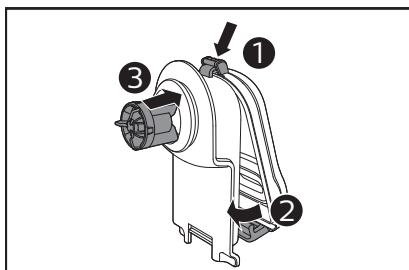

注意

- 如果蒸汽阀未装好，则产品会发生泄漏。使用之前，请务必检查蒸汽阀。

内部

- 将可拆卸内盖和蒸汽阀浸泡在水中，并用海绵进行清洁。
- 用湿布清洁产品内部。
- 确保清理掉黏在电饭煲上的所有食物残渣。

外部

- 用蘸有肥皂水的布进行擦拭。
- 只能使用柔软的干布擦拭控制面板。
- 确保清理掉控制按键周围的所有食物残渣。

附件和内锅

- 二合一饭汤勺、内锅、蒸架。
- 浸泡到热水中并用海绵清洁。

注意

- 请勿将汤匙、碗或任何其他物体放入内锅中，以免损坏不沾涂层。
- 如果在内锅中使用过调味品，请立即清洗。

5 回收

弃置产品时，请不要将它与一般生活垃圾一同丢弃，应将其交给官方指定的回收中心。这样做有利于环保。

请遵循您所在国家/地区的电器及电子产品分类回收规定。正确弃置本产品有助于避免对环境和人类健康造成负面影响。

6 保修与服务

如果需要服务或信息，或有任何疑问，请访问飞利浦网站：

www.philips.com，或联系您所在国家/地区的飞利浦客户服务中心。可在全球保修卡中找到其电话号码。如果您所在的国家/地区没有飞利浦客户服务中心，请向当地的飞利浦经销商求助。

7 规格

型号	HD3081
额定输入功率	950 瓦
额定容量	2.0 升
内锅材质 (金属或者非金属)	金属

8 故障排除

如果在使用本电饭煲时遇到问题，请在申请服务之前检查以下事项。如果无法解决问题，请联系您所在国家/地区的飞利浦服务中心。

问题	解决方法
饭没煮好。	<ul style="list-style-type: none">如果将产品置于不稳固或倾斜的表面，则煮熟的米饭口感可能会因水量不一致而过硬或过软。
	<ul style="list-style-type: none">米饭口感可能会因米的品牌、产地和储存时间而异。
	<ul style="list-style-type: none">米饭口感可能会因室温和水温而异。
	<ul style="list-style-type: none">预设烹饪功能可能会软化米饭。这是正常的。
	<ul style="list-style-type: none">如果您使用快煮功能，则米饭很硬是正常现象。
	<ul style="list-style-type: none">检查内锅是否已变形。
	<ul style="list-style-type: none">水量不足。将水加到内锅的相应水位标示。
饭煮糊了。	<ul style="list-style-type: none">确保加热元件以及内锅外部没有杂物黏附，再打开电饭煲。
	<ul style="list-style-type: none">确保内锅内侧和外侧无杂物黏附。清除食物残渣。
	<ul style="list-style-type: none">大米未洗干净。将米洗干净。
烹饪期间，电饭煲中有水溢出。	<ul style="list-style-type: none">检查内锅是否已变形。
	<ul style="list-style-type: none">立即切断电源。确保根据所倒入白米的杯数和类型，依照刻在内锅上的相应水位标记加入适量的水。
	<ul style="list-style-type: none">确保水不超过水位标示上的另一个水位，否则可能导致产品在烹饪期间溢出。
我找不到所需的烹饪功能。	<ul style="list-style-type: none">确保食物/米饭和水的比例与烹饪功能相匹配。
	<ul style="list-style-type: none">轻触 ▲ / ▼ 可选择所需功能。
	<ul style="list-style-type: none">检查保温指示灯是否亮起。取消保温功能并重试。
	<ul style="list-style-type: none">检查电源线是否已连接至产品，以及电源插头是否已完全插入电源插座。

问题	解决方法
米饭在煮好后味道不好闻。	<ul style="list-style-type: none"> • 请用一些清洁剂和温水清洗内锅。
显示面板不工作。	<ul style="list-style-type: none"> • 电饭煲未连接至电源。如果未接通电源，则显示面板将无法工作。
出现漏气。	<ul style="list-style-type: none"> • 检查蒸汽阀是否装好。如果未装好，则会漏气。
轻触 ▲ / ▼ 键或其他按键后无响应。	<ul style="list-style-type: none"> • 检查电力公司的供电，并检查电源线、电源插头和电源插座之间的连接。 • 根据用户手册正确使用电饭煲。 • 如果您无法自行处理，请勿拆卸产品，请将产品送至飞利浦经销商或飞利浦授权的服务中心。
产品未自动切换至保温模式。	<ul style="list-style-type: none"> • 您未选择正确的烹饪模式。例如，想煮粥却选择了煮饭功能。 • 有些菜单没有保温功能，烹饪过程完成后，产品会进入待机模式。 • 温度控制有故障。请将本产品送往当地的飞利浦经销商，或经飞利浦授权的客户服务中心。
屏幕上显示错误消息（E5 或 E6）。	<ul style="list-style-type: none"> • 请与专业人员确认产品是否在正常电压范围内工作。 • 检查是否有太多电器在同时使用电源插座或延长线过长。 • 如果您无法自行处理，请勿拆卸产品，请将产品送至飞利浦经销商或飞利浦授权的服务中心。

问题	解决方法
屏幕上显示错误消息 (E7)。	<ul style="list-style-type: none"> • 检查底部进气口是否有异物。
	<ul style="list-style-type: none"> • 检查环境温度是否过高。
	<ul style="list-style-type: none"> • 屏幕上显示错误代码后，产品将自动关闭。如果冷却一段时间后其可以正常工作；这表示产品显示该错误代码是防止自身过热。
	<ul style="list-style-type: none"> • 如果您无法自行处理，请勿拆卸产品，请将产品送至飞利浦经销商或飞利浦授权的服务中心。
屏幕上显示错误消息 (E14)。	<ul style="list-style-type: none"> • 检查内锅中是否无水或水量过少。
	<ul style="list-style-type: none"> • 检查内锅是否过热。
	<ul style="list-style-type: none"> • 关闭产品，将内锅取出来冷却一段时间。产品将恢复正常工作。
产品在使用过程中停止加热，并显示其他错误代码。	<ul style="list-style-type: none"> • 如果您无法自行处理，请勿拆卸产品，请将产品送至飞利浦经销商或飞利浦授权的服务中心。
	<ul style="list-style-type: none"> • 使用过程中发生电源故障。请将本产品送往当地的飞利浦经销商，或经飞利浦授权的客户服务中心。





© 2021 Philips Domestic Appliances Holding B.V.
All rights reserved
6608 000 07877

