

PHILIPS

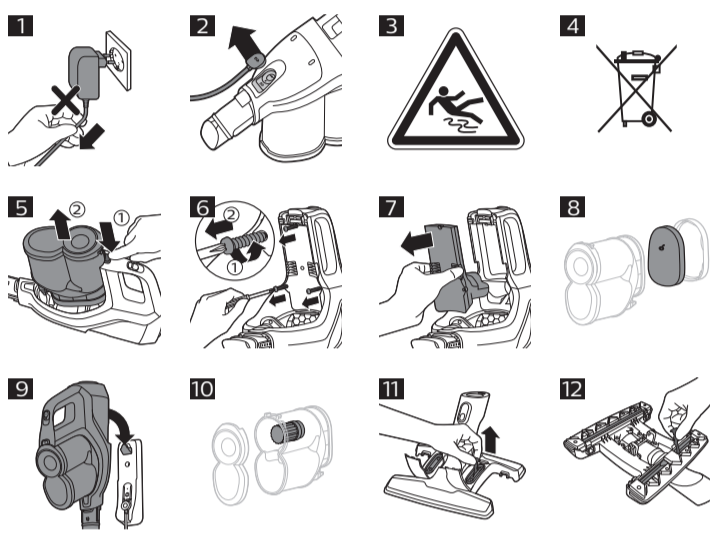

© 2022 Philips Domestic Appliances Holding B.V.
All rights reserved
保留所有权利
3000.084.4829.1 (01/2022)
> 75% 循环再造纸
保留备用

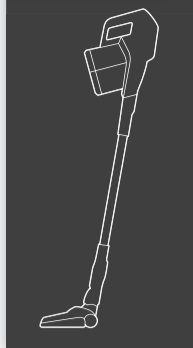

>75 % recycled paper
>75 % papier recyclé

English

Important safety information

Read this important information carefully before you use the appliance and its accessories and save it for future reference. The accessories supplied may vary for different products.

Danger

- Never vacuum up water or any other liquid. Never vacuum up flammable substances and do not vacuum up ashes until they are cold.
- Never immerse the appliance or the adapter in water or any other liquid, nor rinse it under the tap.

Warning

- Check if the voltage indicated on the adapter corresponds to the local mains voltage before you connect the appliance.
- Always check the appliance before you use it. Do not use the appliance or the adapter if it is damaged. Always replace a damaged part with one of the original type.
- The adapter contains a transformer. Do not cut off the adapter to replace it with another plug, as this causes a hazardous situation.
- This appliance is not intended for use by persons (including children) with reduced physical, sensory or mental capabilities, or lack of experience and knowledge, unless they have been given supervision or instruction concerning use of the appliance by a person responsible for their safety.
- Children should be supervised to ensure that they do not play with the appliance.
- Always keep the magnetic charging disc away from very small children.
- The plug must be removed from the socket-outlet before cleaning or maintaining the appliance.
- Unplug the adapter if you are not going to use the appliance for some time.
- When storing the appliance for more than a month (without usage or charging), make sure that the battery is charged to at least 50%. Storing the appliance with an empty battery may lead to irreversible damage to the battery.
- Do not let the motorized brush move over the mains cords of other appliances or other cables as this may cause a hazard.
- Keep loose clothing, hair and body parts away from the motorized brushes.
- Do not cover or block the ventilation openings when the appliance is operating.
- This vacuum cleaner is designed for household use only. Do not use this vacuum cleaner to vacuum up building waste, cement dust, ashes, fine sand, lime and similar substances. Never use the vacuum cleaner without any of the filters. This could damage the motor and shorten the life of the vacuum cleaner. Always clean all parts of the vacuum cleaner as shown in the user manual. Do not clean any parts with water and/or cleaning agents if this is not specifically shown in the user manual.
- Only charge the appliance with the adapter supplied. Only use 30V adapter ZD12D300050. The corresponding adapter number can be found on the adapter.
- Do not open, modify, pierce, damage or dismantle the product or battery to prevent batteries are damaged or leaking, avoid contact with the skin or eyes. Do not short-circuit, overcharge or reverse charge batteries.
- Keep product and batteries away from fire and do not expose them to direct sunlight or high temperatures.
- If the product becomes abnormally hot or smelly, changes color or if charging takes longer than usual, stop using and charging the product and contact Philips.
- Do not place products and their batteries in microwave ovens or on induction cookers.
- If batteries are damaged or leaking, avoid contact with the skin or eyes. If this occurs, immediately rinse well with water and seek medical care.
- This product contains a rechargeable battery. The battery may only be replaced by a qualified service engineer.
- Take the appliance to an authorized Philips service center when you can no longer recharge it or when it runs out of power quickly.

Caution

- During charging, the adapter becomes warm to the touch. This is normal.
- Do not plug in, unplug or operate the appliance with wet hands.
- Do not remove the adapter from the wall socket by pulling at the cord (Fig. 1). When you do not use the charging station for charging, always unplug the appliance by first detaching the magnetic charging disc from the underside of the appliance (Fig. 2).
- Always switch off the appliance after use and before you charge it.
- Never block the exhaust air openings at the back of the appliance during vacuuming.
- Do not clean the dust container and the dust container lid in the dishwasher. They are not dishwasher-proof.
- Always use the vacuum cleaner with the filter assembled.
- When you clean the washable sponge filter with water, make sure it is completely dry before you put it back into the filter holder and dust container. Do not dry the sponge filter in direct sunlight, on the radiator or in the tumble dryer. Do not clean the filter holder with water. This part is not washable.
- Replace the filter if it can no longer be cleaned properly or if it is damaged (see 'Ordering accessories').

- Never use any accessories or parts from other manufacturers or that Philips does not specifically recommend. If you use such accessories or parts, your warranty becomes invalid.
- Make sure that the appliance is installed with the charging station attached to the wall according to the instructions in the user manual.
- Be careful when you drill holes in the wall to attach the charging station, to avoid the risk of electric shock.
- As this appliance uses water to clean, the floor may remain wet and slippery for a while (Fig. 3).
- Do not lift or tilt the nozzle when the water tank is assembled and full, as water may spray out of the water tank.
- To prevent damage, never put wax, oil, floor maintenance products or liquid floor cleaners that are not water-dilutable in the water tank.
- To prevent damage, never put ethereal oils or similar substances in the water tank or let the appliance pick them up.
- Do not mix different types of liquid floor cleaner. When you have used one liquid floor cleaner, first empty and rinse the water tank before you add another liquid floor cleaner to the water in the water tank.
- Never exceed the maximum quantities mentioned on the bottle when you use a liquid floor cleaner. Do not add more than a few drops to the water in the water tank, as this tank has a capacity of 380 ml.
- Do not clean the metal wetting strip with a sharp object, as this may damage the strip. Only clean the wetting strip by rinsing it under the tap. Replace the wetting strip when you can no longer clean it.
- To guarantee good cleaning results and proper functioning of the appliance and water tank, always use original Philips cleaning pads.
- Clean the water tank according to the instructions. The water tank is not dishwasher-proof.
- After mopping the floors, do not store the appliance with the water tank attached on the charging station. If you do this, the wet mopping pad will touch the wall and this may damage the wall. Always remove the water tank before you store the appliance.

Electromagnetic fields (EMF)

This Philips appliance complies with all applicable standards and regulations regarding exposure to electromagnetic fields.

Using the appliance

Usage restrictions

- Only use the water tank on hard floors with a water-resistant top coat (such as linoleum, enameled tiles and varnished parquet) and stone floors (such as marble). If your floor has not been treated to make it water-resistant, check with the manufacturer if you can use water to clean it. Do not use the water tank on hard floors of which the water-resistant top coat is damaged.
- Only use the water tank on linoleum floors that are properly affixed to prevent linoleum from being drawn into the mopping nozzle.
- Do not use the water tank to clean carpets.
- Do not move the appliance with water tank assembled sideways, as this leaves water traces. Only move forwards and backwards.

Note: The operating time depends on the power level used during cleaning.

Mopping pad and wetting strip

The appliance comes with one wetting strip and two microfiber mopping pads. With the water tank, wetting strip and microfiber mopping pad attached to the standard floor nozzle, you can clean hard floors.

Using liquid floor cleaner in the water tank

If you want to add a liquid floor cleaner to the water in the water tank, make sure that you use a low-foaming or non-foaming liquid floor cleaner that can be diluted in water. As the water tank has a capacity of 380ml, you only have to add a few drops of liquid floor cleaner to the water.

Cleaning the water tank

To clean the water tank, mix one part vinegar with three parts water. Pour this mixture into the water tank and close the cap. Shake the water tank and put the water tank on a water-resistant surface. Leave the water-vinegar mixture in the water tank overnight. Then empty the water tank, rinse it thoroughly with fresh water, and use it normally again.

Caution: Water will leak from the water tank during cleaning, with and without the wetting strip attached to the nozzle.

To empty the water tank, hold the water tank over a sink, remove the cap and tilt the water tank to the side of the filling hole. Then turn the water tank over to let the water flow into the sink. To remove the remaining water from the water tank, turn the water tank on its long side with the filling hole pointing towards the sink. Then tilt the water tank forwards to let the remaining water flow out of the water tank.

Note: Always store the water tank with the cap removed from the filling hole.

Ordering accessories

To buy accessories or spare parts, visit www.philips.com/parts-and-accessories or go to your Philips dealer. You can also contact the Philips Consumer Care Center in your country (see the international warranty leaflet for contact details).

Warranty and support

If you need information or support, please visit www.philips.com/support or read the international warranty leaflet.

Recycling

- This symbol means that electrical products and batteries shall not be disposed of with normal household waste (Fig. 4).
- Follow your country's rules for the separate collection of electrical products and batteries.

Removal of built-in rechargeable battery

The built-in rechargeable battery must only be removed by a qualified professional when the appliance is discarded. Before removing the battery, make sure that the appliance is disconnected from the wall socket and that the battery is completely empty.

Take any necessary safety precautions when you handle tools to open the appliance and when you dispose of the rechargeable battery.

When you handle batteries, make sure that your hands, the product and the batteries are dry.

To avoid accidental short-circuiting of batteries after removal, do not let battery terminals come into contact with metal objects (e.g. coins, hairpins, rings). Do not wrap batteries in aluminum foil. Tape battery terminals or put batteries in a plastic bag before you discard them.

To remove the rechargeable battery, follow the instructions below.



- 1 Disconnect the appliance from the wall socket and let it run until the motor stops.
- 2 Remove the dust container from the appliance (Fig. 5).
- 3 Undo the three screws that fix the battery holder to the housing of the appliance (Fig. 6).
- 4 Pull the battery holder out of the appliance (Fig. 7).

User interface signals and their meaning

Signal	Description of signal	Meaning of signal
	The signal '00' and the battery icon flash on the display.	The battery is empty.
	A number between '00' and '90' flashes on the display.	The appliance is charging.
	The number '100' lights up on the display.	After a full charging cycle, this signal appears to show that the rechargeable battery is fully charged.
	The battery symbol lights up on the display.	The appliance is in standby mode with a fully charged battery.
	A number between '00' and '10' together with the battery icon flash on the display.	The rechargeable battery of the appliance is low.
	The display shows a flashing square and the orange filter cleaning icon also flashes.	It indicates the recommended time to check and clean the filter (Fig. 8) to ensure the best performance of the appliance.
	Error code 'E1' lights up on the display. Note: When the appliance is charging on the charging station, the E1 error code may look like the number 13.	This indicates that the appliance has been stored or charged at a temperature below 5 °C. Move the appliance to a warmer room. Do not store or charge the appliance at a temperature below 5 °C or above 40 °C.
	Error code 'E4' lights up on the display. Note: When the appliance is charging on the charging station, the E4 error code may look like the designation h3	The roller brush in the 360 ° Turbo nozzle has become blocked and cannot turn freely. Switch off the appliance and check the roller brush for obstructions or entangled hairs.
	Error code 'E6' lights up on the display. Note: When the appliance is charging on the charging station, the E6 error code may look like the number 93.	The adapter or battery may be defective. Please contact the Consumer Care Center or take the appliance to an authorized Philips service center.
	Error code 'E7' lights up on the display. Note: When the appliance is charging on the charging station, the E7 error code may look like the designation L3	The adapter may be defective. Please contact the Consumer Care Center or take the appliance to an authorized Philips service center.
	Error code 'SE' lights up on the display. Note: When the appliance is charging on the charging station, the SE error code may look like the number 35.	SE stands for service. Please take the appliance to an authorized Philips service center.

Troubleshooting

This chapter summarizes the most common problems you could encounter with the appliance. If you are unable to solve the problem with the information below, visit www.philips.com/support for a list of frequently asked questions or contact the Consumer Care Center in your country.

Problem	Possible cause	Solution
The appliance does not work when I push the slider.	When the battery is empty, the following icon flashes on the display: 	To charge the battery, connect the appliance to the charging station or attach the handheld vacuum cleaner directly to the magnet on the charging station (Fig. 9).
	You have to push the slider forward to switch on the appliance.	Push the slider forward to setting 1 to switch on the appliance. Increase the suction power further by pushing the slider to setting 2 or select the Turbo setting to clean very dirty patches at the highest suction power.
The appliance suddenly stops working.	When there is a problem, the buttons will not respond and the screen will remain blank.	Connect the appliance to the charging station or attach the handheld vacuum cleaner directly to the magnet on the charging station (Fig. 9). Check the display. Once the appliance starts charging, you may continue to use the appliance as usual. If an error code appears, you can find its meaning in this booklet (see 'User interface signals and their meaning').
The appliance has a lower suction power than usual.	The filter and the cyclone are dirty.	Empty the dust bucket. Clean the filter (Fig. 8) and the cyclone (Fig. 10). The filter light lights up after several hours of use to indicate that you have to wash the sponge filter. Make sure that you wash the sponge filter at least once a month if you use the appliance regularly. Make sure that you remove any hair and dirt that is stuck in the cyclone.
	You have not attached the dust container lid properly to the dust container or you have not attached the dust container properly to the appliance. In both cases, there will be a loss of suction power.	Make sure that you attach the dust container lid to the dust container and the dust container to the appliance properly.
Dust escapes from the appliance.	The filter is dirty.	Clean the filter (Fig. 8). See also the user manual.
	Something is blocking the cyclone.	Check the cyclone (Fig. 10) for objects stuck in it and remove any object that is blocking the cyclone. Make sure that you remove any hair and dirt that is stuck in the cyclone.
	If dust falls out of the dust container, the dust container lid is probably not attached properly to the dust container.	Empty the dust container and attach the dust container lid correctly.
This icon flashes on the display: 	The filter may be dirty.	We advise you to clean the filter (Fig. 8). If you cleaned the filter recently, you can disregard this icon. To continue vacuuming, switch the appliance off and then on again.
The appliance does not move smoothly across the floor when I am cleaning a carpet.	You selected a too high suction power.	Reduce the suction power by choosing setting 1.
The brush does not turn anymore.	The brush is clogged with hair or dirt.	Clean the brush with a pair of scissors or by hand.
	The brush may stop turning when it encounters too much resistance from high-pile carpet.	Switch off the appliance and then switch it back on again.
	You have not assembled the roller brush into the nozzle properly after cleaning.	Follow the instructions in the cleaning chapter to slide the roller brush into the nozzle properly. Secure the roller brush inside the nozzle by snapping the locking lever in place.
The LEDs in the nozzle do not come on.	You have not attached the nozzle to the tube or appliance properly.	Attach the nozzle to the appliance or handheld properly.
The appliance is not charging.	The magnetic connector is not connected properly to the charging disk or the adapter is not inserted into the wall socket properly.	Make sure that the magnetic connector is connected properly to the charging disk and that the adapter is inserted into the wall socket properly.
	You have not connected the adapter supplied.	Make sure that you use the adapter supplied.
	The Vacuum & Wipe nozzle is attached while charging the appliance on the wall-mounted charging station.	Make sure that you attach the 360° suction nozzle when you charge the appliance on the charging station.
		If you have checked the above and the appliance still does not charge, take it to a Philips service center or contact the Consumer Care Center.
The mini Turbo brush does not function properly.	The roller brush is blocked.	Remove hairs from the brush with a pair of scissors (see user manual).
	The roller brush is blocked by fabric or surfaces during cleaning.	Keep the mini Turbo brush aligned with the surface and do not push the Turbo brush into soft surfaces.
	The roller brush is not properly inserted into the mini Turbo brush.	Make sure that roller brush and the mini Turbo brush are properly connected and that there is no gap between the parts (see user manual).
When I use my vacuum cleaner I sometimes feel static electricity shocks.	Your vacuum cleaner builds up static electricity. The lower the air humidity, the more static electricity the appliance builds up.	Discharge the appliance by frequently holding the tube against other metal objects in the room (for example the legs of a table or chair, etc.). You can also raise the air humidity level in the room.
	You vacuumed up dust and static. This also causes static electricity.	Empty the dust container and clean the filter (Fig. 8) according to the instructions in the user manual.

Using the water tank

Problem	Possible cause	Solution
The water flow from the water tank is reduced.	The wetting strip is blocked by dirt.	Remove the wetting strip and clean it.
	The microfiber mopping pad is not placed correctly and blocks the wetting strip as a result. This prevents water from flowing out of the wetting strip.	Make sure that you place the mopping pad correctly. Check the user manual for proper placement.
	The water tank is empty or nearly empty.	Refill the water tank.
	You are using a microfiber mopping pad that is not supplied by Philips.	Only use an original Philips microfiber mopping pad. You can buy these mopping pads in the online Philips shop at www.shop.philips.com/service or at your Philips dealer.
The appliance has a lower suction power than usual.	The air channels on the Vacuum & Wipe nozzle are blocked.	Open the lids of the air channels on both sides of the tube on the Vacuum & Wipe nozzle. Clean the channels (Fig. 11). Close the lids and turn the nozzle upside down. Clean the air channels from the bottom (Fig. 12).

Problem	Possible cause	Solution
Too much water flows out of the water tank at a too high speed.	If too much water flows out of the water tank at a too high speed, the cap of the tank is probably not closed properly.	Check the cap and make sure it is fully and properly closed.
	The strip is not placed properly in the bottom of the water tank.	Check the strip and make sure that it is fitted properly in the bottom plate of the water tank.
The floor dries with stripes when I use the water tank.	You added too much liquid cleaner to the water.	Use only a few drops of liquid cleaner or use a cleaner that foams less.
	The microfiber mopping pad is not placed correctly and creates stripes.	Make sure that you place the mopping pad correctly. Check the user manual for proper placement.

简体中文

重要安全信息

使用本产品及其附件之前，请仔细阅读本重要信息，并妥善保管以供日后参考。随附的附件可能因产品而异。

危险

- 切勿吸入水或其他任何液体。切勿吸入易燃物质，也不要吸入未冷却的灰烬。
- 切勿将本产品或适配器浸入水或其他任何液体中，也不要将它们放在水龙头下冲洗。

警告

- 在将本产品连接电源前，务必检查当地的电压是否与电源适配器所标电压一致。
- 使用前，请务必检查产品。如果产品或适配器受损，请停止使用。请务必用原装型号更换损坏的部件。
- 适配器中包含一个变压器。请勿剪下适配器更换其他插头，否则将导致严重后果。
- 产品不建议由有肢体、感官或精神能力缺陷或缺少使用经验和知识的人（包括儿童）使用，除非有负责他们安全的人对他们进行与产品使用有关的监督或指导。
- 请照顾好儿童，本产品不能用于玩耍。
- 务必将磁性充电圆盘放置到儿童接触不到的地方。
- 清洁或维护产品之前，必须先从插座拔掉插头。
- 如果在一段时期内不使用本产品，请拔下适配器插头。
- 将产品存放超过一个月（不使用或不充电）时，请确保电池至少有 50% 的电量。如果在电池电量耗尽的情况下存放产品，可能会对电池造成不可逆的损坏。
- 切勿让电动刷在其它产品的电源线或其它线缆上移动，否则可能会引发危险。
- 确保宽松的衣服、毛发和身体部位远离电动刷。
- 产品运行时，切勿覆盖或堵塞通风口。
- 根据设计，本吸尘器仅限于家用。切勿使用本吸尘器清理建筑垃圾、水泥灰、灰尘、细沙、石灰和类似的物质。切勿在没有任何滤网的情况下使用本吸尘器。这会损坏马达并缩短吸尘器的使用寿命。务必按照用户手册中的说明清洁吸尘器的所有部件。请勿使用水和/或清洁剂清洁任何部件（如果用户手册中未特别说明）。
- 只能用随附的适配器为本产品充电。只能使用 30V 适配器 ZD12D300050。可以在适配器上找到相应的适配器编号。
- 为防止电池发热或释放有毒有害物质，切勿打开、改装、刺穿、损坏或拆卸产品或电池。切勿使电池短路、过度充电或反向充电。
- 请将产品和电池远离火源，切勿将其暴露于阳光直射处或高温下。
- 如果产品异常发热或发出异味、变色或充电时间比平时长，请停止使用并停止为其充电，并联系飞利浦。
- 切勿将产品及其电池放置在微波炉中或电磁炉上。
- 如果电池损坏或出现泄漏，请避免与皮肤或眼睛接触。如果不慎接触，请立即用清水冲洗并就医。
- 本产品包含充电电池。只有具备资格的服务工程师才能更换电池。
- 当充电电池无法继续充电或耗电很快时，请将产品送至授权的飞利浦服务中心。

注意

- 充电期间，适配器会有微热。这是正常现象。
- 切勿用湿手插入、拔下或操作产品。
- 切勿以拉拔电源线 (图 1) 的方式将适配器从电源插座上拔下。如果没有使用充电座充电，在断开产品的电源连接时，务必先从产品的底部取下磁性充电圆盘 (图 2)。
- 使用后和充电前，请务必关闭产品。
- 吸尘时切勿堵塞产品背后的排气口。
- 切勿在洗碗机中清洗集尘盒及集尘盒盖。这些部件不可在洗碗机中清洗。
- 使用吸尘器时，请确保装上过滤网。
- 当用水清洁可水洗海绵滤网时，确保其完全干燥后再放回过滤网架和集尘盒中。切勿在直射的阳光下、散热器上或滚筒式烘干机中干燥海绵滤网。切勿用水清洁过滤网架。该部件不可水洗。
- 如果无法再洗净过滤网或其已损坏 (请参见 '订购配件')，请予以更换。
- 切勿使用其他制造商生产的或未经飞利浦特别推荐的任何配件或部件。如果您使用了此类配件或部件，本产品的保修将会失效。
- 在安装本产品时，确保按照用户手册中的说明将充电座安装到墙上。
- 在墙上钻孔安装充电座时应多加小心，以防发生触电危险。
- 因本产品使用水来清洁，清洁后的一段时间内 (图 3) 地板上会有些湿和打滑。
- 组装水箱及水箱已满时，请勿提起或倾斜吸嘴，否则水可能会从水箱中喷出。
- 为防止受损，切勿将蜡、油、地板维护产品或非水稀释性液体地板清洁剂倒入水箱中。
- 为防止受损，切勿将香精油或类似物质放入水箱中，也不要用水清洁它们。
- 切勿混合不同类型的液体地板清洁剂。使用一种地板清洁剂后，需要先倒空并冲洗水箱，然后才能在水箱的水中加入另一种液体地板清洁剂。
- 使用液体地板清洁剂时，切勿超过瓶子上标示的最大量。由于水箱的容量为 380 毫升，只需向水箱的水中少量加入几滴清洁剂即可。
- 请勿用尖锐物体清洁湿的金属条，否则可能造成损坏。只能在自来水下清洁湿的金属条。无法再清洁干净时，请更换湿的金属条。
- 为保证良好的清洁效果及产品和水箱的正常运作，请务必使用原装飞利浦清洁布。
- 根据说明清洁水箱。水箱不可用洗碗机清洗。
- 清洁完地板后，请不要将装有水箱的本产品存放在充电座上。否则，湿清洁布将接触墙壁并可能对墙体造成损坏。存放本产品之前请务必先卸下水箱。

电磁场 (EMF)

本 Philips 产品符合所有有关暴露于电磁场的适用标准和法规。

使用本产品

使用限制

- 仅在具有防水表面涂层的硬地板（例如油毡地板、瓷板和刷漆木地板）和石材地板（例如大理石）上使用水箱。如果您的地板未经过处理，且不具有防水作用，请咨询制造商，了解是否可以用水清洁。请勿在防水表面涂层损坏的硬地板上使用水箱。
- 仅在正确贴合的油毡地板上使用水箱，以防止油毡吸入拖地吸嘴中。
- 请勿使用水箱清洁地毯。
- 请勿侧向移动装有水箱的产品，这样会留下水痕。只能前后移动。

注意：运行时间取决于清洁期间所使用的功率大小。

清洁布和湿的金属条

本产品随附一个湿的金属条和两块微纤维清洁布。安装好水箱后，您可以将湿的金属条和微纤维清洁布可安装到标准地板吸嘴，以便用于清洁硬地板。

在水箱中使用液体地板清洁剂

如果您要在水箱的水中加入液体地板清洁剂，请确保使用可在水中稀释的低泡沫或无泡沫液体地板清洁剂。由于水箱容量为 380 毫升，只需在水中加入几滴液体地板清洁剂即可。

清洁水箱

如需清洁水箱，请将一份醋与三份水混合。将混合液倒入水箱中，盖上盖子。摇晃水箱，然后将水箱放在防水表面上。将水醋混合液在水箱中存放一夜。然后，倒空水箱，用清水彻底冲洗后再正常使用。

警告：在清洁过程中，不论吸嘴上是否安装湿的金属条，水都会从水箱中漏出。

要倒空水箱，请将水箱拿到水槽上方，取下水箱盖，并向注水孔一侧倾斜水箱。然后将水箱翻转过来，以便让水流入水槽。要将剩余的水从水箱中倒出，请沿水箱的长边翻转，并将注水孔朝向水槽。然后向前倾斜水箱，以便让剩余的水从水箱中流出。

注意：存储水箱时，务必从注水孔上取下盖子。

订购配件

如需购买附件或备件，请访问

www.philips.com/parts-and-accessories 或联系您的飞利浦经销商。您还可以联系所在国家/地区的飞利浦客户服务中心（请参阅保修卡了解详细联系信息）。

保修和支持

如需信息或支持，请访问 www.philips.com/support 或阅读保修卡。

回收

- 此符号表示电器产品和电池不能与一般的生活垃圾一同弃置(图 4)。
- 请遵守您所在国家/地区有关分类回收电器产品和电池的规定。

取出内置充电电池

丢弃产品时，必须仅由有资质的专业人员取出内置充电电池。取出电池之前，请确保产品与电源插座断开连接并且电池电量已完全耗尽。

当您使用工具打开产品时以及在您弃置充电电池时，请采取必要的安全保护措施。

处理电池时，请确保您的双手、产品和电池都是干燥的。

为避免电池拆卸后发生意外短路，切勿让电池端子接触金属物体（例如硬币、发夹、戒指）。切勿用铝箔包裹电池。在丢弃之前，请用胶带将电池端子粘住或将电池放在塑料袋中。

按照以下步骤拆下充电电池。

- 1 断开本产品的电源连接并让其继续运行，直至电机停止转动。
- 2 从产品(图 5)上卸下集尘盒。
- 3 卸掉产品(图 6)外壳上用于固定电池舱的三个螺丝。
- 4 将电池舱从产品(图 7)中拉出。



用户界面信号及其含义

信号	信号描述	信号含义
	显示屏上闪烁显示信号“00”和电池图标。	电池已耗尽。
	显示屏上闪烁显示“00”和“90”之间的数字。	产品正在充电。
	显示屏上亮起数字“100”。	充满电后将显示此信号，指示充电电池已充满电。
	显示屏上亮起电池符号。	产品处于待机模式，且电池已充满电。
	显示屏上同时闪烁显示“00”和“10”之间的数字以及电池图标。	产品充电电池的电量过低。
	显示屏上显示一个闪烁的方块，同时橙色过滤网清洁图标也在闪烁。	这表示该检查和清洁过滤网了，以确保产品实现最佳性能(图 8)。
	显示屏上亮起错误代码“E1”。 注意：当将产品放在充电座上充电时，E1 错误代码可能看起来像数字 13。	这表明产品存放在低于 5 ° C 的环境中，或在该环境中充电。将产品移至较暖和的房间。切勿将本产品存放在低于 5 ° C 或高于 40 ° C 的环境中，或在该环境中充电。
	显示屏上亮起错误代码“E4”。 注意：当将产品放在充电座上充电时，E4 错误代码可能看起来像符号 h3	360 ° 吸嘴或迷你 Turbo 刷嘴中的滚刷被阻塞，无法自由转动。关闭产品并检查滚刷是否被阻塞或缠绕毛发。
	显示屏上亮起错误代码“E6”。 注意：当将产品放在充电座上充电时，E6 错误代码可能看起来像数字 93。	适配器或电池可能有故障。请联系客户服务中心，或将产品送至授权的飞利浦维修中心。
	显示屏上亮起错误代码“E7”。 注意：当将产品放在充电座上充电时，E7 错误代码可能看起来像符号 L3	适配器可能损坏。请联系客户服务中心，或将产品送至授权的飞利浦维修中心。
	显示屏上亮起错误代码“SE”。 注意：当将产品放在充电座上充电时，SE 错误代码可能看起来像数字 35。	SE 代表维修。请将产品送至授权的飞利浦维修中心。

故障处理方法

本章归纳了使用本产品时最常见的一些问题。如果您无法根据以下信息解决问题，请访问

www.philips.com/support 查阅常见问题列表，或联系您所在国家/地区的客户服务中心。

问题	可能的原因	解决方法
推动滑钮时，产品不工作。	电池电量耗尽，在此情况下显示屏上将闪烁显示以下图标： 	电池充电的方法是将产品连接到充电座上，或将手持式真空吸尘器直接连接到充电座的磁体上(图 9)。
	必须向前推动滑钮才能打开产品。	将滑钮向前推动至设置 1 可以打开产品。将滑钮推至设置 2 可以进一步增加吸力，或者选择 Turbo 设置在最大吸力下清洁非常脏的区域。
产品突然停止工作。	出现问题时，按钮无反应且屏幕不显示内容。	您可将产品连接到充电座上，或将手持式真空吸尘器直接连接到充电座的磁体上(图 9)。检查显示屏。产品开始充电后，您便可继续正常使用。如果出现错误代码，您可以在手册中查找代码的含义(请参见'用户界面信号及其含义')。
本产品的吸力比往常要小。	过滤网和旋风滤网不干净。	倒空集尘桶。清洁过滤网和(图 8)旋风滤网(图 10)。在使用数小时后，滤网指示灯将亮起，表示您必须清洗海绵滤网。如果您经常使用本产品，请确保每月至少清洗一次海绵滤网。确保清除卡在旋风滤网中的任何毛发和污垢。
	未将集尘盒盖正确安装到集尘盒上，或者未将集尘盒正确安装到产品上。在这两种情况下，吸力将降低。	请确保您将集尘盒盖正确安装到了集尘盒上，并将集尘盒正确安装到了产品上。
灰尘从产品中溢出。	过滤网变脏。	清洁过滤网(图 8)。另请参阅用户手册。
	旋风滤网被异物阻塞。	检查旋风滤网是否被异物卡住，并清除堵塞旋风滤网的任何异物(图 10)。确保清除卡在旋风滤网中的任何毛发和污垢。
	如果灰尘从集尘盒中掉出，则集尘盒盖可能未正确安装到集尘盒上。	倒空集尘盒，并正确安装集尘盒盖。
显示屏上闪烁显示以下图标： 	过滤网可能脏了。	我们建议您清洁过滤网(图 8)。如果您最近清洁过过滤网，请忽略此图标。如需继续进行吸尘，请先关闭产品，然后再将其打开。
在清洁地毯时，产品无法在地板上顺畅移动。	您选择的吸力太大。	通过选择设置 1 来降低吸力。
滚刷不再旋转。	滚刷被头发或污垢堵塞。	用剪刀或用手清洁滚刷。
	滚刷在长毛绒地毯上遇到太大阻力时，可能会停止转动。	关闭产品，然后将其重新打开。
	清洗滚刷后未正确将其安装到吸嘴上。	请按照“清洁”一章中的说明，将滚刷正确滑入吸嘴，并将锁定杆扣合到位，以便将滚刷固定到吸嘴内。
吸嘴中的 LED 指示灯不亮。	未将吸嘴正确安装到吸管或产品上。	将吸嘴正确安装到产品上，或采用正确的手持方式。
产品未充电。	磁性连接器未正确连接到充电圆盘，或适配器未正确插入电源插座。	请确保磁性连接器正确连接到充电圆盘，且适配器正确插入电源插座。
	您尚未连接随附的适配器。	请确保使用随附的适配器。
	使用壁挂式充电座为产品充电时连接了 Vacuum & Wipe 吸嘴。	使用充电座为产品充电时，请确保连接 360° 吸嘴。
		如果已执行上述检查但产品依然无法充电，请将其送往飞利浦维修中心，或联系客服服务中心。
迷你 Turbo 刷无法正常工作。	滚刷被阻塞。	用剪刀清除刷子上的毛发(请参见用户手册)。
	清洁过程中，滚刷被织物或表面阻塞。	保持迷你 Turbo 刷与表面对齐，切勿将 Turbo 刷推入软质表面。
	滚刷未正确插入迷你 Turbo 刷。	确保迷你 Turbo 刷和滚刷正确连接，且两部分之间没有间隙(请参见用户手册)。
有时，在使用吸尘器时会有触静电的感觉。	吸尘器会积聚静电。空气湿度越低，产品积聚的静电就越多。	经常握住硬管使其与房间中的其它金属物体接触(例如，桌椅脚等)，对产品进行放电。您也可以增加房间的空气湿度。
	使用吸尘器清理灰尘和污垢，这也会引发静电。	清空集尘盒，并按照用户手册中的说明清洁过滤网(图 8)。

使用水箱时所遇故障的处理方法

问题	可能的原因	解决方法
水箱的水流量减少。	湿的金属条被污垢阻塞。	卸下湿金属条，并进行清洁。

问题	可能的原因	解决方法
	微纤维清洁布未正确放置，因此阻塞了湿金属条。这样可以防止水从湿金属条流出。	请确保您正确放置了清洁布。有关如何正确放置的方法，请参阅本用户手册。
	水箱为空或几乎无水。	为水箱加水。
	使用非飞利浦提供的微纤维清洁布。	仅限于使用原装飞利浦微纤维清洁布。您可以在飞利浦网上商城 www.shop.philips.com/service 或飞利浦经销商处购买这些清洁布。
本产品的吸力比往常要小。	吸擦吸嘴的气道堵塞。	打开吸擦吸嘴上管道两侧的气道盖。清洁气道 (图 11)。关闭盖子并将吸嘴倒置。从底部清洁气道 (图 12)。
水箱出水量过多且出水速度过快。	如果水箱出水量过多且出水速度过快，则可能是水箱盖没盖好。	检查水箱盖并确保其已完全闭合盖好。
	金属条未正确置于水箱底部。	检查金属条并确保其已正确安装在水箱底板上。
当使用水箱时，地板干后出现水痕。	向水中加入了过多液体清洁剂。	只需添加几滴液体清洁剂或使用起泡较少的清洁剂。
	微纤维清洁布未放好导致出现水痕。	请确保您正确放置了清洁布。有关如何正确放置的方法，请参阅本用户手册。

PHILIPS

产品：飞利浦手持无线真空吸尘器
 型号：XC8349
 额定电压：220V~
 额定频率：50Hz
 额定输入电流：0.5 A
 生产日期：请见产品本体
 产地：中国江苏苏州



飞利浦家电（中国）投资有限公司
 上海市静安区灵石路728弄20号201室
 全国顾客服务热线：4008 800 008

本产品根据国标 GB4706.1-2005,
 GB4706.7-2014, GB4343.1-2018
 及GB17625.1-2012制造

保留备用

发行日期: 12/1/2022