

Always here to help you / 始终如一地为您提供帮助

Register your product and get support at / 请登录以下网址并得到相应的帮助
www.philips.com/welcome



EasySpeed
GC1029-GC1017 series

EasySpeed
GC1029-GC1017 系列



User manual / 用户手册

PHILIPS

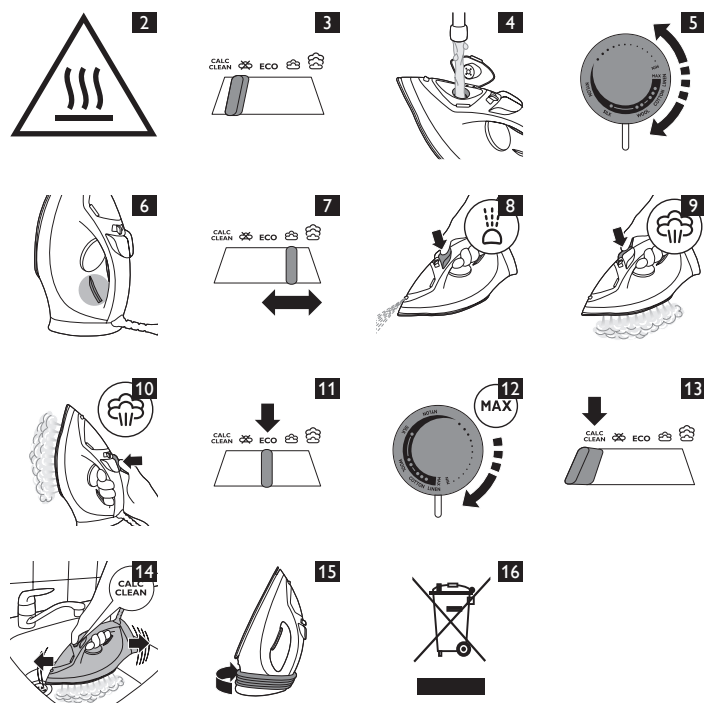
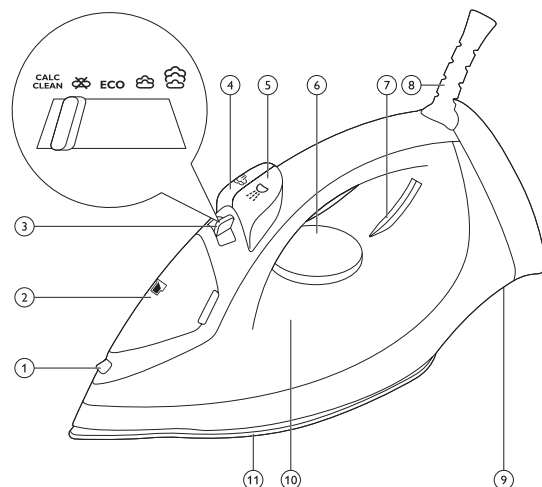

www.philips.com



4239.000.8663.3

Introduction

Congratulations on your purchase and welcome to Philips!
To fully benefit from the support that Philips offers, register your product at www.philips.com/welcome.

General description (Fig. 1)

- 1 Spray nozzle
- 2 Cap of filling opening
- 3 Steam control
- **CALC CLEAN** = Calc-Clean function
- ☒ = dry ironing
- **ECO** = optimal steam
- ☁ = maximum steam
- ☄ = turbo steam
- 4 Steam boost button (specific types only)
- 5 Spray button
- 6 Temperature dial
- 7 Temperature light
- 8 Mains cord
- 9 Type plate
- 10 Water tank with MAX water level indication
- 11 Soleplate

Important

Read this user manual carefully before you use the appliance and save it for future reference.

Danger

- Never immerse the iron in water.

Warning

- Check if the voltage indicated on the appliance corresponds to the local mains voltage before you connect the appliance.
- Do not use the appliance if the plug, the mains cord or the appliance itself shows visible damage, or if the appliance has been dropped or leaks.
- If the mains cord is damaged, you must have it replaced by Philips, a service centre authorised by Philips or similarly qualified persons in order to avoid a hazard.
- Never leave the appliance unattended when it is connected to the mains.
- Always unplug the appliance from the socket outlet before you fill the water tank with water.
- This appliance is not intended for use by persons (including children) with reduced physical, sensory or mental capabilities, or lack of experience and knowledge, unless they have been given supervision or instruction concerning use of the appliance by a person responsible for their safety.
- Children should be supervised to ensure that they do not play with the appliance.
- Keep the appliance and its mains cord out of reach of children.
- Always place and use the iron on a stable, level and horizontal surface.
- Do not let the mains cord come into contact with the hot soleplate of the iron.

CAUTION: Hot surface (Fig. 2)

Surfaces are liable to get hot during use (for irons with 'hot' symbol marked on the appliance).

Caution

- Only connect the appliance to an earthed wall socket.
- Check the mains cord regularly for possible damage.
- Fully unwind the mains cord before you plug it in the wall socket.
- The soleplate of the iron can become extremely hot and may cause burns if touched.
- Descale the iron regularly according to the instructions in chapter 'Cleaning and maintenance' in the user manual.
- When you have finished ironing, when you clean the appliance, when you fill or empty the water tank and also when you leave the iron even for a short while: set the steam control to the 'dry ironing' position, put the iron on its heel and remove the mains plug from the wall socket.
- Do not put perfume, vinegar, starch, descaling agents, ironing aids or other chemicals in the water tank.
- This appliance is intended for household use only.

Electromagnetic fields (EMF)

This Philips appliance complies with all standards regarding electromagnetic fields (EMF). If handled properly and according to the instructions in this user manual, the appliance is safe to use based on scientific evidence available today.

Using the appliance

Filling the water tank

Note: Your appliance has been designed to be used with tap water. If you live in an area with very hard water, fast scale build-up may occur. In this case, it is recommended to mix 50% distilled water and 50% tap water to prolong the lifetime of your appliance.

Note: Do not put perfume, vinegar, starch, descaling agents, ironing aids, chemically descaled water or other chemicals in the water tank.

- 1 Set the steam control to position ☒ (dry ironing). (Fig. 3)
- 2 Fill the water tank up to the MAX indication (Fig. 4).
- 3 Close the cap of the filling opening.

Selecting temperature and steam setting

Table 1

Fabric type	Temperature setting	Steam setting	Steam boost	Spray
Linen	MAX	☁, ☄	Yes	Yes
Cotton	●●●	☁, ☄	Yes	Yes
Wool	●●	ECO	No	Yes
Silk	●	☒	No	No
Synthetic fabrics (e.g. acrylic, nylon, polyamide, polyester).	●	☒	No	No

Note: As indicated in the table above, do not use steam or steam boost at a low temperature, otherwise hot water may leak from the iron.

- 1 Consult table 1 to set the temperature dial to the appropriate setting for your garment (Fig. 5).
- 2 Put the iron on its heel and plug it in. The temperature light goes on to indicate that the iron is heating up (Fig. 6).
- 3 When the temperature light goes out, the iron has reached the correct temperature.
- 4 Consult table 1 to select a steam setting that corresponds to the temperature you have set (Fig. 7).

Note: To use turbo steam ☄, keep the steam control pressed to the turbo steam position ☄ continuously.

Features

Spray function

- Press the spray button to moisten the article to be ironed. This helps remove stubborn creases (Fig. 8).

Steam boost function (specific types only)

- Press and release the steam boost button for a powerful boost of steam to remove stubborn creases (Fig. 9).

Vertical steam (specific types only)

- You can use the steam boost function when you hold the iron in vertical position for removing creases from hanging clothes, curtains etc (Fig. 10).

ECO steam setting

- Select the **ECO** steam setting instead of the maximum steam setting ☁ to save energy, yet to achieve satisfactory ironing results. (Fig. 11)

Dry ironing

- Set the steam control to ☒ (dry ironing) to iron without steam. (Fig. 3)

Cleaning and maintenance

Cleaning

- 1 Set the steam control to ☒ (dry ironing), unplug the iron and let it cool down. (Fig. 3)
- 2 Pour any remaining water out of the water tank.

- 3 Wipe flakes and any other deposits off the soleplate with a damp cloth and a non-abrasive (liquid) cleaning agent.

Caution: To keep the soleplate smooth, avoid hard contact with metal objects. Never use a scouring pad, vinegar or other chemicals to clean the soleplate.

Note: Regularly rinse the water tank with tap water. Empty the water tank after rinsing it.

Calc-Clean function

IMPORTANT: To prolong the lifetime of your appliance and to maintain good steaming performance, use the Calc-Clean function once every two weeks. If the water in your area is very hard (i.e. when flakes come out of the soleplate during ironing), use the Calc-Clean function more frequently.

- 1 Make sure the appliance is unplugged and the steam control is set to ☼ (dry ironing). (Fig. 3)
- 2 Fill the water tank to the MAX indication (Fig. 4).

Do not pour vinegar or other descaling agents into the water tank.

- 3 Plug in the iron and set the temperature dial to MAX (Fig. 12).
- 4 Unplug the iron when the temperature light goes out.
- 5 Hold the iron over the sink. Push the steam control to the Calc-Clean position and hold it (Fig. 13).
- 6 Gently shake the iron until all water in the water tank has been used up (Fig. 14).

Caution: While scale is flushed out, steam and boiling water also come out of the soleplate.

- 7 Set the steam control back to ☼ (dry ironing). (Fig. 3)

Note: Repeat the Calc-Clean process if the water that comes out of the iron still contains scale particles.

After the Calc-Clean process

- 1 Plug in the iron. Let the iron heat up to let the soleplate dry.
- 2 Unplug the iron when the temperature light goes out.
- 3 Move the iron gently over a piece of cloth to remove any water stains on the soleplate.
- 4 Let the iron cool down before you store it.

Storage

- 1 Unplug the iron and set the steam control to ☼ (dry ironing). (Fig. 3)
- 2 Wind the mains cord round the cord storage facility and store the iron on its heel (Fig. 15).

Environment

- Do not throw away the appliance with the normal household waste at the end of its life, but hand it in at an official collection point for recycling. By doing this, you help to preserve the environment (Fig. 16).

Guarantee and support

If you need information or support, please visit www.philips.com/support or read the separate worldwide guarantee leaflet.

Troubleshooting



This chapter summarises the most common problems you could encounter with the appliance. If you are unable to solve the problem with the information below, visit www.philips.com/support for a list of frequently asked questions or contact the Consumer Care Centre in your country (see the worldwide guarantee leaflet for contact details).

Problem	Possible cause	Solution
Water drips from the soleplate or wet spots appear on the garment during ironing.	The set temperature is too low for steam ironing.	Set an ironing temperature that is suitable for steam ironing. See table 1.
	You have put an additive in the water tank.	Rinse the water tank and do not put any additive in the water tank.
The steam boost function does not work properly (water leaks out of the soleplate).	You have used the steam boost function too often within a very short period.	Wait a while before you use the steam boost function again.
	You have used the steam boost function at a too low temperature.	Set an ironing temperature at which the steam boost function can be used (●●● to MAX).
Flakes and impurities come out of the soleplate during ironing.	Hard water forms flakes inside the soleplate.	Use the Calc-Clean function (see chapter 'Cleaning and maintenance', section 'Calc-Clean function').
Water drips from the soleplate after the iron has cooled down or has been stored.	You have put the iron in horizontal position while there was still water in the water tank.	Empty the water tank and set the steam control to position 'dry' after use. Store the iron on its heel.
Water leaks from the cap of the filling opening.	You have overfilled the water tank.	Do not fill the water tank beyond the MAX indication. Pour excess water out of the water tank.
When I push the steam control to the turbo steam position, the steam control jumps back.	You did not keep the steam control in the turbo steam position.	If you want to use turbo steam, you have to keep the steam control in the turbo steam position continuously. For other steam settings, this is not necessary.

简介

感谢您的惠顾，欢迎光临飞利浦！为了您能充分享受飞利浦提供的支持，请在 www.philips.com/welcome 上注册您的产品。

基本说明 (图 1)

- 1 喷雾嘴
- 2 注水口盖
- 3 蒸汽控制
- **CALC CLEAN** = 自动除垢功能
-  = 干熨
- **ECO** = 低能耗
-  = 最大蒸汽量
-  = 增压蒸汽
- 4 蒸汽喷射按钮 (仅限于特定型号)
- 5 喷雾按钮
- 6 温度旋钮
- 7 温度指示灯
- 8 电源线
- 9 型号铭牌
- 10 水箱，带最大 (MAX) 水位标示
- 11 底板

注意事项

使用本产品之前，请仔细阅读本使用说明书，并妥善保管以备日后参考。

危险

- 切勿将熨斗浸泡到水里。

警告

- 在将产品连接电源之前，请先检查产品所标电压与当地的供电电压是否相符。
- 如果插头、电源线或产品本身已经明显损坏，或产品曾坠落或出现渗漏，请勿再使用产品。
- 如果电源软线损坏，为避免危险，必须由制造厂或其维修部或类似的专职人员来更换。
- 电源接通期间，使用者不得离开。
- 在向水箱注水之前，务必从电源插座上拔下产品的电源插头。
- 器具不打算由有肢体、感官或精神能力缺陷或缺乏使用经验和知识的人（包括儿童）使用，除非有负责他们安全的人对他们进行与器具使用有关的监督或指导。
- 请照顾好儿童，本产品不能用于玩耍。
- 将产品和电源线放在儿童接触不到的地方。
- 务必在稳固、平整且水平的表面上放置和使用熨斗。
- 切勿让电源线触及高温电熨斗底板。

注意：表面很烫 (图 2)

表面在使用中容易变得很烫（对于在产品上标有“烫”符号的电熨斗）。

注意

- 产品只能使用带接地线的插座。
- 定期检查电线，防范潜在的危害。
- 将产品插入电源插座之前，请将电源线完全解开。

- 使用时熨斗的底板会非常烫，触碰底板会导致烫伤。
- 根据用户手册“清洁和保养”一章中的说明定期为熨斗除垢。
- 当完成熨烫、清洁产品、注水或倒空水箱以及即使短时间离开熨斗时：将蒸汽控制旋钮调至“干熨”位置，熨斗竖放，并且从电源插座中拔下电源插头。
- 切勿将香水、醋、淀粉、除垢剂、烫衣剂或其它化学品注入水箱内。
- 本产品仅限于家用。

电磁场 (EMF)

这款飞利浦产品符合关于电磁场 (EMF) 的相关标准。据目前的科学证明，如果正确使用并按照本用户手册中的说明进行操作，本产品是安全的。

使用本产品

给水箱注水

注意：根据设计，您的产品适合使用自来水。如果您所居住的区域水质非常硬，水垢积聚会非常快。在此情况下，建议将 50% 的蒸馏水和 50% 的自来水混合，以延长产品的使用寿命。

注意：不要将香水、醋、淀粉、除垢剂、烫衣剂或其他化学品放入水箱。







1 将蒸汽控制旋钮调至  位置（干熨）。(图 3)

2 将水注入水箱，至最高水位 (MAX)。 (图 4)

3 将注水口盖关闭。

选择温度和蒸汽设定

表 1

面料类型	温度设定	蒸汽设定	蒸汽喷射	喷雾装置
麻	最大	 , 	是	是
棉	●●●	 , 	是	是
羊毛	●●	ECO	否	是
丝绸	●		否	否
合成纤维 (如聚丙烯、尼龙、聚酰胺、聚脂)。	●		否	否



注意：如上表所示，请勿在低温时使用蒸汽或蒸汽束喷射，否则，熨斗可能泄漏热水。

1 参阅表 1，将温度旋钮调至适合衣物的适当设置。(图 5)

2 将熨斗竖放并插入电源插座。温度指示灯亮起，表示熨斗正在加热。(图 6)

3 温度指示灯熄灭时，熨斗即已达到适当的温度。

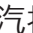
4 参阅表 1，选择与设定温度对应的蒸汽设定。(图 7)

注意：要使用增压蒸汽 ，请按住蒸汽控制旋钮，持续保持在增压蒸汽位置 。

功能

喷水功能

- 按喷水按钮可湿润要熨烫的衣物。这有助于去除顽固褶皱。(图 8)

蒸汽喷射功能 (仅限于特定型号)

- 按下然后释放蒸汽喷射按钮可获得强劲的蒸汽喷射，轻松去除顽固皱褶。(图 9)

垂直蒸汽 (仅限于特定型号)

- 您可以在竖握握住熨斗时使用蒸汽喷射功能，用于去除悬挂衣物、窗帘上的褶皱。(图 10)

低能耗 蒸汽设定

- 选择 **低能耗** 蒸汽设定而不是最大蒸汽设定 ☁，节能的同时又能获得满意的熨烫结果。(图 11)

干熨

- 将蒸汽控制旋钮调至 ☒ (干熨) 可进行无蒸汽熨烫。(图 3)

清洁和保养

清洁

- 1 将蒸汽控制旋钮调至 ☒ (干熨)，拔下熨斗插头，使其冷却。(图 3)

- 2 将水箱中的水全部倒出。

- 3 用湿布和非腐蚀性 (液体) 清洁剂抹去底板上的水垢和其它沉积物。

注意： 为了保持底板光滑，应避免底板与金属物体碰撞。切勿使用磨砂布、醋或其他化学品清洁底板。

注意： 定期用自来水冲洗水箱。冲洗后倒空水箱。

除水垢功能

注意事项： 要延长产品的使用寿命并保持良好的蒸汽性能，应每两周使用一次自动除垢功能。如果您当地的水硬度很高 (即熨烫过程中底板中出现薄片)，则需更经常地使用自动除垢功能。

- 1 确保产品的插头已经拔掉，且蒸汽控制旋钮已调至 ☒ (干熨)。(图 3)

- 2 向水箱注水，直至最高水位 (MAX)。(图 4) 请勿将醋或其它除垢剂注入水箱。

- 3 将熨斗插头插入插座，将温度旋钮调至最 MAX (最高)。(图 12)

- 4 当温度指示灯熄灭时，拔下熨斗的电源插头。

- 5 在水池上方手持熨斗。将蒸汽控制旋钮调至自动除垢位置并按住。(图 13)

- 6 轻轻摇动熨斗，直至水箱中的水全部用光。(图 14)

注意： 水垢冲出时，蒸汽和沸水也会从底板中冲出。

- 7 将蒸汽控制旋钮调回 ☒ (干熨)。(图 3)

注意： 如果从熨斗中冲出的水仍有水垢颗粒，则应再次使用除水垢功能。

完成除水垢过程后

- 1 将熨斗插头插入插座。让熨斗加热，使底板干燥。

- 2 当温度指示灯熄灭时，拔下熨斗的电源插头。

- 3 将熨斗在一块布上轻轻移动，去除底板上残留的水渍。

- 4 让熨斗冷却，然后存放好。

存储

- 1 拔掉熨斗的插头，将蒸汽控制旋钮调至 ☒ (干熨)。(图 3)

- 2 将电源线绕在电源线存储装置上，将熨斗竖立存放。(图 15)

环保

- 弃置产品时，请不要将其与一般生活垃圾扔在一起，应将其交给指定的回收中心，这样做有利于环保。(图 16)

保修和支持

如果您需要信息或支持，请访问 www.philips.com/support 或阅读单独的全球保修卡。

故障种类和处理方法

本章归纳了使用本产品时最常见的一些问题。如果您无法根据以下信息解决问题，请访问 www.philips.com/support 查阅常见问题列表，或联系您所在国家/地区的客户服务中心 (联系详情，请参阅全球保修卡)。

问题	可能的原因	解决方法
熨烫过程中，底板漏水或衣物上出现湿点。	设定温度太低，无法进行蒸汽熨烫。	设定适合蒸汽熨烫的温度。参阅表 1。
	您在水箱中放入了添加剂。	漂洗水箱并且不要往水箱内注入任何添加剂。
蒸汽束喷射功能无法正常工作 (底板漏水)。	您在很短的时间内过于频繁地使用了蒸汽喷射功能。	稍等片刻后再使用蒸汽束喷射功能。
	您在过低的温度下使用了蒸汽喷射功能。	将熨烫温度设为可以使用蒸汽喷射功能的温度 (●●● 至最大 (MAX))。
在熨烫过程中底板内冒出水垢和杂质。	硬水会在底板内形成水垢。	使用自动除垢功能 (请参阅“清洁和保养”一章中的“自动除垢功能”一节)。
熨斗冷却后，或存放期间，有水从底板漏出。	水箱中还有水，熨斗被水平放置。	使用后，倒空水箱并将蒸汽控制旋钮调至“干熨”位置。熨斗应竖立存放。

问题	可能的原因	解决方法
注水口盖漏水。	水箱装得过多。	切勿让水位超过水箱的最大 (MAX) 水位标示。倒掉水箱中多余的水。
将蒸汽控制旋钮按到增压蒸汽位置时，蒸汽控制旋钮会跳回。	您未将蒸汽控制旋钮保持在增压蒸汽位置。	如果要使用增压蒸汽，必须将蒸汽控制旋钮持续保持在增压蒸汽位置。对于其他蒸汽设置，则不必这样做。

PHILIPS

产品：飞利浦蒸汽电熨斗
型号：GC1026
额定电压：220V~
额定频率：50Hz
额定输入功率：1800 W
生产日期：请见产品本体
产地：中国浙江慈溪

飞利浦（中国）投资有限公司
上海市天目西路218号1602-1605
全国顾客服务热线: 4008 800 008

本产品根据国标 GB4706.1-2005, GB4706.2-2007, GB4343.1-2009及**GC17625.1-2012** 制造

PHILIPS

产品：飞利浦蒸汽电熨斗
型号：GC1021
额定电压：220V~
额定频率：50Hz
额定输入功率：1600 W
生产日期：请见产品本体
产地：中国浙江慈溪

飞利浦（中国）投资有限公司
上海市天目西路218号1602-1605
全国顾客服务热线: 4008 800 008

本产品根据国标 GB4706.1-2005, GB4706.2-2007, GB4343.1-2009及**GC17625.1-2012** 制造

PHILIPS

产品：飞利浦蒸汽电熨斗
型号：GC1020,GC1018
额定电压：220V~
额定频率：50Hz
额定输入功率：1400 W
生产日期：请见产品本体
产地：中国浙江慈溪

飞利浦（中国）投资有限公司
上海市天目西路218号1602-1605
全国顾客服务热线: 4008 800 008

本产品根据国标 GB4706.1-2005, GB4706.2-2007, GB4343.1-2009及**GC17625.1-2012** 制造

PHILIPS

产品：飞利浦蒸汽电熨斗
型号：GC1017
额定电压：220V~
额定频率：50Hz
额定输入功率：1200W
生产日期：请见产品本体
产地：中国浙江慈溪

飞利浦（中国）投资有限公司
上海市天目西路218号1602-1605
全国顾客服务热线: 4008 800 008

本产品根据国标 GB4706.1-2005, GB4706.2-2007, GB4343.1-2009及**GC17625.1-2012** 制造

保留备用
发行日期：140902