

www.philips.com/welcome

HLI 646/00



EN Mixer Grinder

Please read the guidelines provided in this DFU on Important Instructions, Appliance Usage & Warranty before using the product.

PHILIPS

Contents

Introduction	2
General description and technical specifications	2
Important instructions	3-4
Using the product	4-5
How to fit the blades	
How to fit jar to base unit	
Operation	5
Before the first use	
Preparation for use	
Cleaning and maintenance	6
Overload protection	6
Maximum jar capacities	6
Trouble shooting	7-8
Warranty and service	9
Warranty card	9
Recommended blades	10

1.0 Introduction

Philips brings to you a range of mixer grinder with high quality steel jars.
Please note accessories for your model. HLI 646/00 - wet, dry and chutney jar.

2.0 General description

1. **Base unit:** the motor, speed switch, mains cord and overload protector switch.
2. **Speed selector knob:** for different speed adjustment.
3. **Overload Protection switch:** *
4. **Anti slip rubber feet**
5. **1.5 litre Wet grinding jar:** for liquidizing and blending.
6. **1.0 litre Dry grinding jar:** for dry grinding.
7. **Chutney grinding jar:** for small quantity grinding such as chutney, pepper, dry masala.
8. **Wet grinding blade :** detachable.
9. **Dry grinding blade :** detachable.
10. **Chutney grinding blade:** fixed.
11. **Blender Blade:** detachable.
12. **Whipper Blade:** detachable.
13. **Spatula:** to clean sides of jars from inside and use as a spanner for blades.

Technical specifications

Model No. : HLI 646/00

Voltage: 230 V ~ 50Hz

Wattage: 600W max.

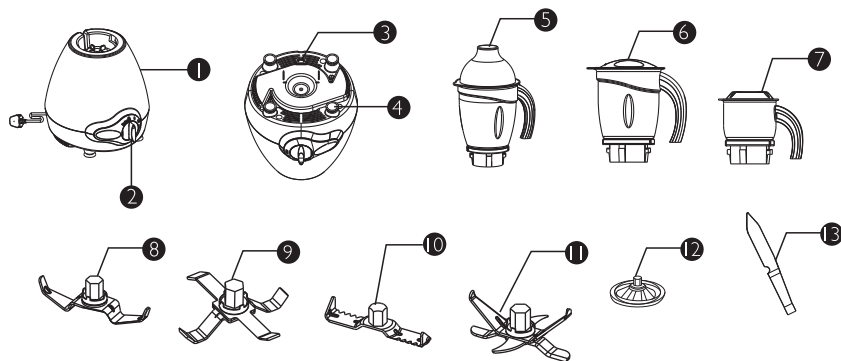

* red coloured switch located below the base of the unit

3.0 Important instructions

We recommend that you read the following instructions carefully, before using the appliance.

1. Check if the voltage indicated on the base of the appliance, corresponds to the local electrical mains voltage before connecting the appliance.

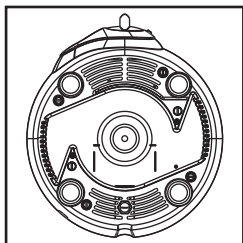

2. Do not use the appliance when the mains cord, the plug or other components are damaged. Only the company or a service centre authorized by Philips must replace it.

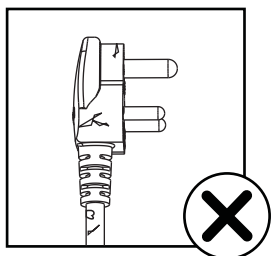

3. Always unplug the appliance after use.

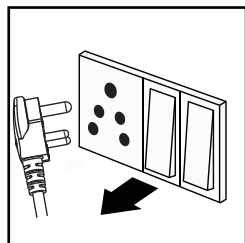

4. Never immerse the motor unit in water.

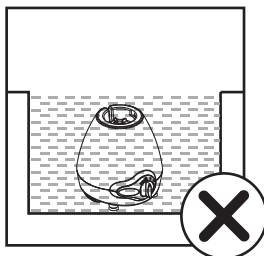

5. Always unplug the appliance before reaching into the jar with your fingers or an object e.g. spatula.

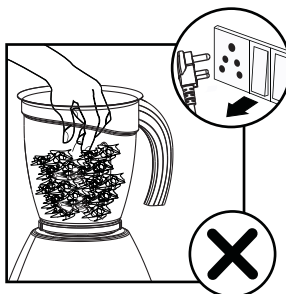

6. The appliance is not intended for use by persons (including children) with reduced physical, sensory or mental capabilities or lack of experience and knowledge, unless they have been given supervision or instruction concerning use of the appliance by a person responsible for their safety. Children should be supervised to ensure that they do not play with the appliance.

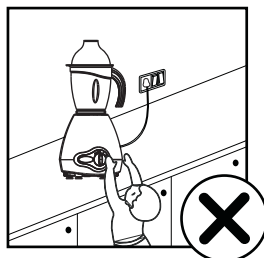

7. Always ensure that speed selector knob is at '0' position before fixing accessories.

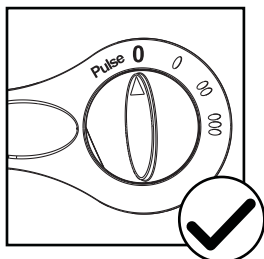

8. Do not operate the mixer without the lid in place or with an empty jar.

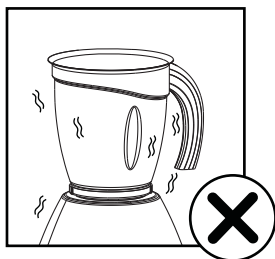

9. Handle the blades carefully. Wash them under running water and do not rub by hand.

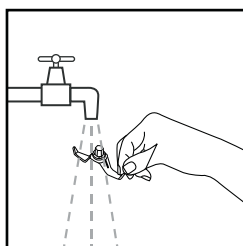

10. Do not use mixer on wet surface.

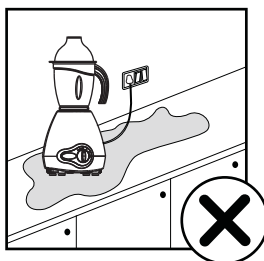

11. Keep mixer away from hot gas burner, electric hot plate or similar appliances.

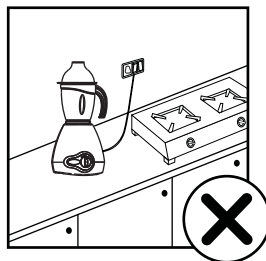

12. This appliance is strictly for household use.

13. Do not drop the main unit or jars.

14. Never use accessories or parts not recommended by Philips or those made by other manufacturers, else the warranty will become invalid.

15. Do not use the jars as storage containers.

16. Do not leave unit unattended while in operation.

17. It is not advisable to run the mixer continuously for more than 30 minutes.

4.0 Using the product

1. How to fit the blades

Hold the coupler on the underside of the jar and with the spanner; tighten by rotating in anti-clockwise direction till the blade is securely locked. Repeat procedure for the other jars.

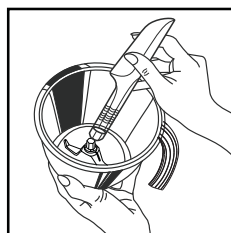

2. How to fit jar to base unit

After fitting the blades, carefully insert the jar on top of the base unit. Ensure that lock of the jar fits the slot of the base unit. Rotate the jar clockwise until it locks.

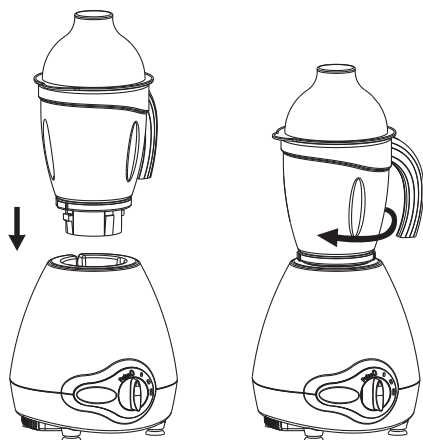

5.0 Operation

1. Before the first use

Thoroughly clean parts that come in contact with food.

2. Preparation for use

Cool the hot ingredients before putting in jar.

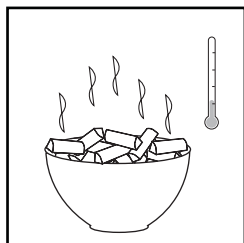

Cut large ingredients into small pieces of approx 2cm before processing.

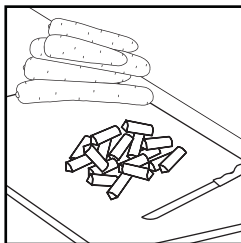

Check speed selector knob is at '0'
Connect mains plug to wall socket after fixing jar. Switch on main supply. Turn speed selector to required position and speed. After operation, turn selector knob to '0' and check. Repeat till desired results are obtained.

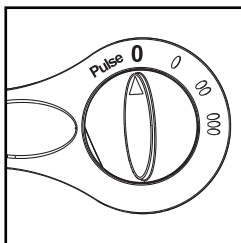

For blending/liquidizing/pureeing, use 'pulse' on speed knob. This will activate the whipping till you release the button.

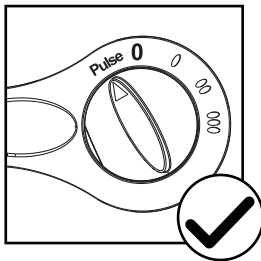

6.0 Cleaning and maintenance

1. Remove main plug from wall socket.
Do not immerse base unit in water.
2. Wipe base unit with a damp cloth and non-abrasive liquid cleaner.
3. Disassemble other parts after use.
Wash them in soapy water; rinse with clean water and dry thoroughly. Do not wash in a dishwasher. Cleaning is easiest done immediately after use.
4. Take soapy water in jar and assemble it on base unit. Pulse 5-6 times and wash the jar.
5. Store mixer grinder standing on its heel in a safe and dry place.

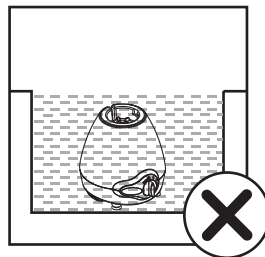

7.0 Overload protection

Mixer is fitted with an automatic power shut off mechanism to avoid motor burning due to overloading. If mixer stops due to overloading, the red knob at the bottom will come out. Switch off the mixer. Remove excess load from jar. Wait for 2-3 minutes. Press red button and start mixer again.

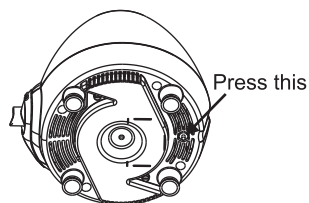

8.0 Maximum jar capacities

No.	Type of jar	Capacity	Wet capacity (rated) Max.	Dry capacity (rated) Max.
1	Wet grinding jar	1.5L	0.5L	0.6L
2	Dry grinding jar	1.0L	0.4L	0.4L
3	Chutney grinding jar	0.4L	NA	0.2L

9.0 Trouble shooting

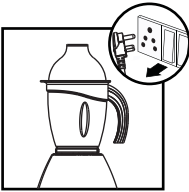
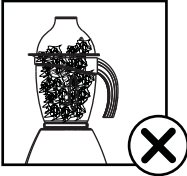
No.	Problem	Cause	Solution
1	Appliance does not work.	No electricity supply. 	Ensure that the plug is plugged in well.
2	Appliance suddenly stops working while in use.	The appliance is equipped with an 'Over Load Protector' (OLP) switch. If appliance overheats, it automatically cuts off power supply.	Unplug appliance and let it cool for 2-3 minutes. Remove jar from base unit. At the bottom of base unit there is a red coloured switch (OLP). Reset OLP by pressing it. Put plug back into wall socket and switch on appliance again (see heading 'Overload Protection').
3	Blade unit is blocked. 	The quantity being processed is probably too large.	Switch off appliance. Remove ingredients that are blocking the blade unit. Refer table on page 6 for the maximum capacity of jars.
4	Base unit gives an unpleasant smell during first few times of use.	This is normal for the first few times.	If appliance continues to smell after using a few times: <ul style="list-style-type: none"> • Ensure that jars are clean and there are no ingredients stuck inside it. • Ensure that appliance has been assembled correctly.

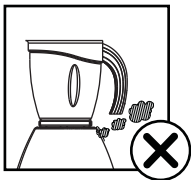
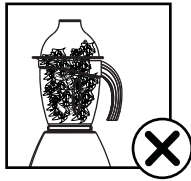
No.	Problem	Cause	Solution
5	Appliance makes a lot of noise.	Jar lid has not been properly placed.	Make sure lid has been properly and tightly locked.
		Jars have not been properly locked.	Make sure jar has been properly and tightly locked.
		Blade is loose.	Remove ingredients from jar and tighten the blade in anti-clockwise direction with spatula
6	There are fumes from the appliance. 	Appliance may have been used for too long.	Switch off appliance and let it cool for 60 minutes.
7	Unsatisfactory grinding/ blending/ mixing performance. 	Incorrect jar selection.	Use correct jar as per the application.
		Ingredients overloading in jar.	Refer table on page 6 for the maximum capacity of jars.
		Large size of ingredients.	Cut ingredients into appropriate size.
		Chutney not grinding well	Inch 5-7 times to powder ingredients. Add water as required and grind on speed 3
8	Leakage from jar lid.	Gasket has not been fit properly.	Unplug appliance. Remove jar from base unit. Remove lid to check if gasket has been assembled correctly.

In case these measures do not work, contact the nearest PHILIPS service center or call at customer care numbers.
1800 102 2929 (Toll free) or 1860 180 1111 "standard call rates apply"

10.0 Warranty and service

For any information or problem, contact your local Philips dealer or authorized service center. For a list of authorized Philips service centers visit: www.philips.com or contact our consumer care at 1800 102 2929 (Toll free) or 1860 180 1111 (standard call rates apply)

11.0 Warranty card

This apparatus is covered under warranty against any defect due to defective material or workmanship for TWO YEARS from the date of purchase. Should a defect develop during the period of warranty, PHILIPS ELECTRONICS INDIA LTD. undertakes to repair the apparatus FREE OF CHARGE through the dealer from whom it has been purchased or at any of the Philips authorized Service Centres.

The warranty is not valid in case:

1. Apparatus is not used according to user manual.
2. Defects caused by improper or reckless use.
3. Repairs done by persons other than Philips Authorized service centre.
4. Modifications of any nature made in the apparatus.
5. Tampered serial number.
6. Incomplete warranty card after purchase.
7. Product if used for commercial purpose (i.e. other than domestic use).
8. Usage of parts not recommended by Philips or those made by other manufacturers.

All consumables and parts susceptible to normal wear and tear are not covered under warranty.

Week/S.No.

Date of purchase _____

Dealer's name: _____



Dealer's stamp: _____

Customer's name and address: _____

Model No.: _____

Dealer's signature: _____

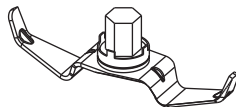
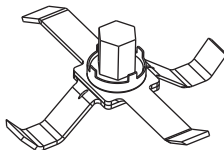
12.0 Recommended blades

<p>Stainless steel wet grinding blade</p>	<p>Stainless steel dry grinding blade</p>	<p>Stainless steel chutney grinding blade (non-removable)</p>
		
<p>Best for wet grinding applications likes:</p> <ul style="list-style-type: none">- Tomato onion paste- Vegetable/ fruit puree- Rice and dal batter	<p>Best for dry grinding applications likes:</p> <ul style="list-style-type: none">- Dry masalas- Rice and dal powder	<p>Best for making:</p> <ul style="list-style-type: none">- Chutneys and- Pastes in small quantities- Lesser quantities of masalas

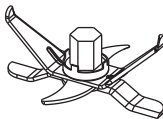
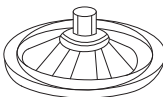
<p>Stainless steel Blender blade</p>	<p>Plastic Whipper blade</p>
	
<ul style="list-style-type: none">- Milk Shakes- Pureeing tomatoes- Mixing Soups	<ul style="list-style-type: none">- Egg whipping- Lassi- Butter churning

For maximum jar capacity turn to page 6



www.philips.com



100% recycled paper

421530030221