

1

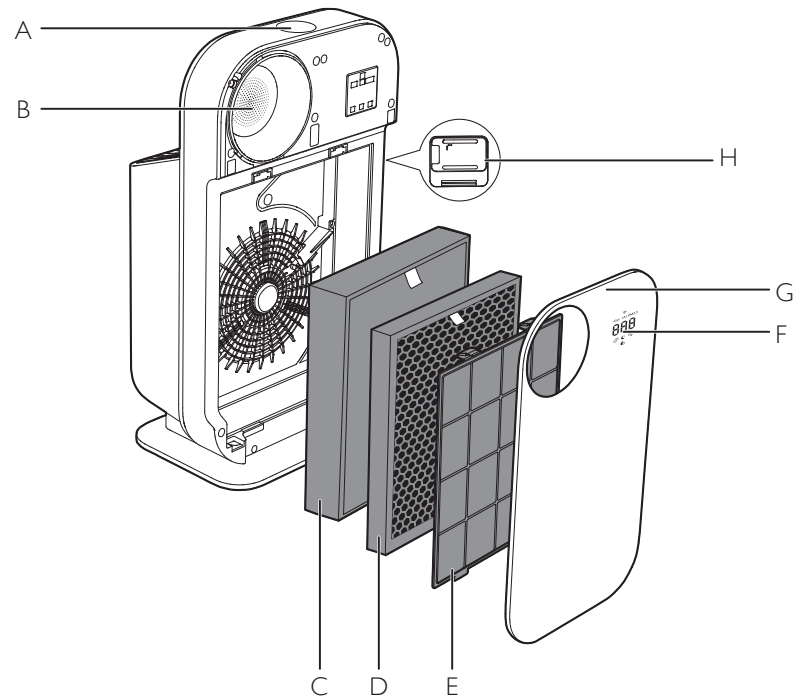

2

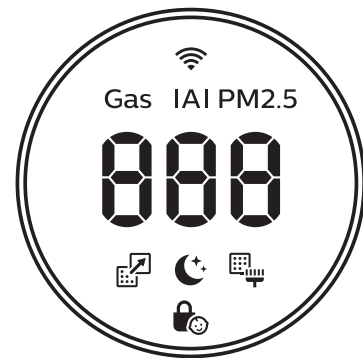

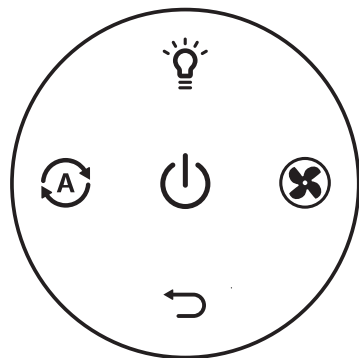
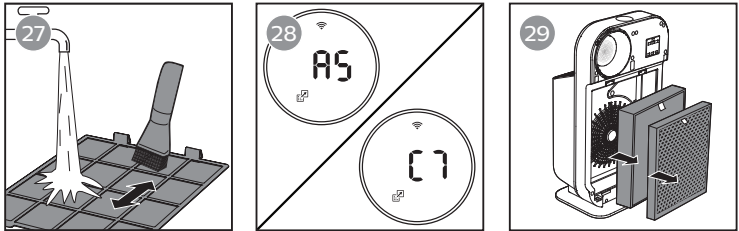
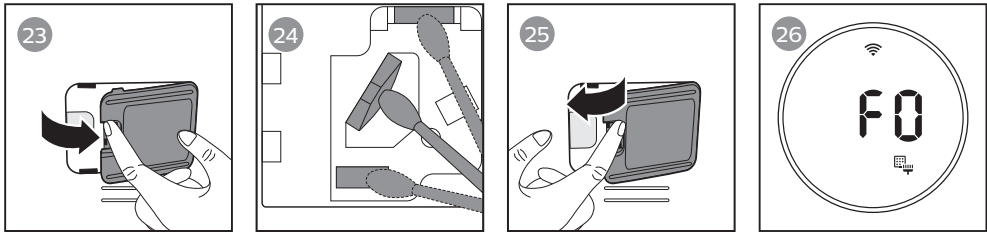
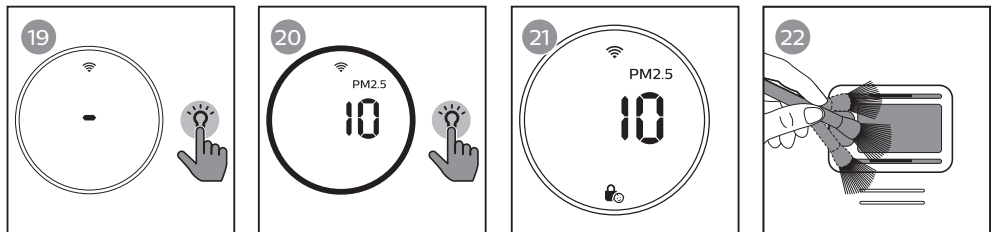
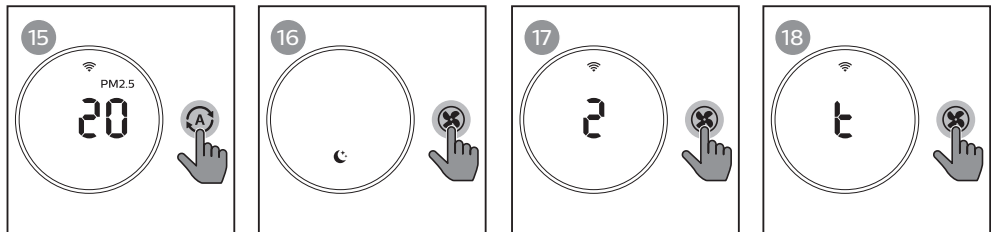
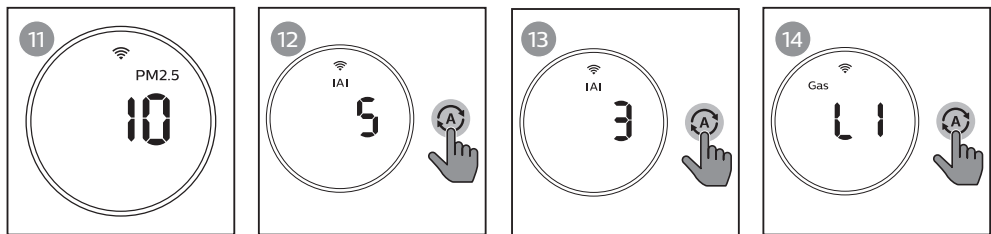
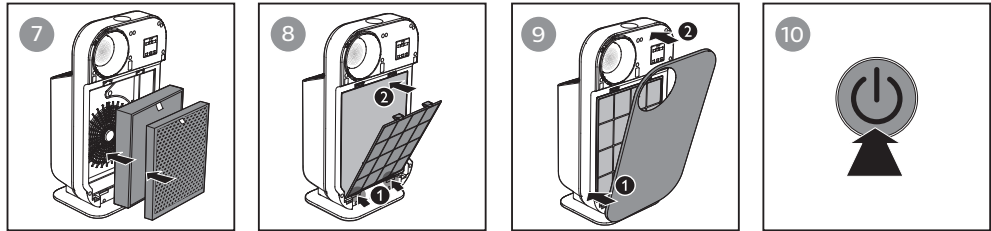
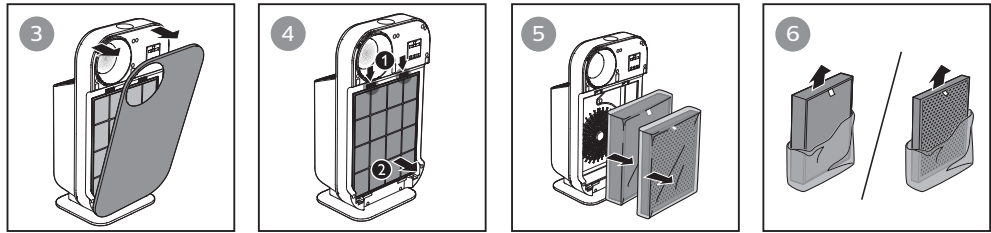

Contents

1 Important	2	7 Storage	15
Safety	2		
2 Your air purifier	5	8 Troubleshooting	16
Product Overview (fig. ①)	5		
Controls overview (fig. ②)	5	9 Guarantee and service	19
		Order parts or accessories	19
3 Getting started	6	10 Notices	19
Installing filters	6	Electromagnetic fields (EMF)	19
Wi-Fi connection	6	Recycling	20
		Notice	20
4 Using the appliance	8		
Understanding the air quality light	8		
Turning on and off	9		
Changing the Auto mode setting	10		
Changing the fan speed	10		
Using the light on/off function	11		
Setting the child lock	11		
5 Cleaning	12		
Cleaning schedule	12		
Cleaning the body of the appliance	12		
Cleaning the air quality sensor	12		
Cleaning the pre-filter	13		
6 Replacing the air purification filters	14		
Understanding the healthy air protect lock	14		
Replacing the filters	14		

1 Important

Safety

Read this user manual carefully before you use the appliance, and save it for future reference.

Danger

- Do not let water or any other liquid or flammable detergent enter the appliance to avoid electric shock and/or a fire hazard.
- Do not clean the appliance with water, any other liquid, or a (flammable) detergent to avoid electric shock and/or a fire hazard.
- Do not spray any flammable materials such as insecticides or fragrance around the appliance.

Warning

- Check if the voltage indicated on the appliance corresponds to the local power voltage before you connect the appliance.

- If the power cord is damaged, you must have it replaced by Philips, a service center authorized by Philips, or similarly qualified persons in order to avoid a hazard.
- Do not use the appliance if the plug, the power cord, or the appliance itself is damaged.
- This appliance can be used by children aged from 8 years and above and persons with reduced physical, sensory or mental capabilities or lack of experience and knowledge if they have been given supervision or instruction concerning use of the appliance in a safe way and understand the hazards involved. Child shall not play with the appliance. Cleaning and maintenance shall not be made by children without supervision.
- Do not block the air inlet and outlet, e.g. by placing items on the air outlet or in front of the air inlet.

- Make sure that foreign objects do not fall into the appliance through the air outlet.
- Standard WiFi interface based on 802.11b/g/n at 2.4 GHz with a maximum output power of 31.62 mW EIRP.

Caution

- This appliance is not a substitute for proper ventilation, regular vacuum cleaning, or use of an extractor hood or fan while cooking.
- If the power socket used to power the appliance has poor connections, the plug of the appliance becomes hot. Make sure that you plug the appliance into a properly connected power socket.
- Always place and use the appliance on a dry, stable, level, and horizontal surface.
- Leave at least 20cm free space behind and on both sides of the appliance and leave at least 30cm free space above the appliance.
- Do not place anything on top of the appliance.
- Do not sit or stand on the appliance. Sitting or standing on the appliance may lead to potential injury.
- Do not place the appliance directly below an air conditioner to prevent condensation from dripping onto the appliance.
- Make sure all filters are properly installed before you switch on the appliance.
- Only use the original Philips filters specially intended for this appliance. Do not use any other filters.
- Combustion of the filter may cause irreversible human hazard and/or jeopardize other lives. Do not use the filter as fuel or for similar purpose.
- Avoid knocking against the appliance (the air inlet and outlet in particular) with hard objects.

- Always lift or move the appliance by the handle on back side of the appliance.
- Do not insert your fingers or objects into the air outlet or the air inlet to prevent physical injury or malfunctioning of the appliance.
- Do not use this appliance when you have used indoor smoke-type insect repellents or in places with oily residues, burning incense, or chemical fumes.
- Do not use the appliance near gas appliances, heating devices or fireplaces.
- Always unplug the appliance after use and before cleaning, or carrying out other maintenance or replacing the filters.
- Do not use the appliance in a room with major temperature changes, as this may cause condensation inside the appliance.
- To prevent interference, place the appliance at least 2 meters away from electrical appliances that use airborne radio waves such as TVs, radios, and radio-controlled clocks.
- The appliance is only intended for household use under normal operating conditions.
- Do not use the appliance in wet surroundings or in surroundings with high ambient temperatures, such as the bathroom, toilet, or kitchen.
- The appliance does not remove carbon monoxide (CO) or radon (Rn). It cannot be used as a safety device in case of accidents with combustion processes and hazardous chemicals.
- If you need to move the appliance, disconnect the appliance from the power supply first.
- Do not move the appliance by pulling its power cord.
- Always cleanse your hands after changing the filters.

2 Your air purifier

Congratulations on your purchase, and welcome to Philips!

To fully benefit from the support that Philips offers, register your product at www.philips.com/welcome.

This appliance works with an air filtration system. Read this user manual carefully before you use the appliance, and save it for future reference.





Product Overview (fig. ①)

- A Display panel
- B Air quality light
- C NanoProtect filter HEPA Series 3* (FY3433)
- D NanoProtect filter Active Carbon* (FY3432)
- E Pre-filter
- F Control buttons
- G Front cover
- H Air quality sensor





*Hereinafter referred to as "air purification filter".

Controls overview (fig. ②)

Control buttons

-  Power on/off button
-  Light on/off button
-  Auto mode button
-  Fan speed button
-  Reset button

Display panel:

-  Wi-Fi indicator
- Gas** Gas display
- PM2.5** PM2.5 display
- IAI** Indoor Allergen Index
-  Filter replacement alert
-  Sleep mode
-  Pre-filter cleaning alert
-  Child lock indicator**

You can enable the child lock function through the **Air Matters App.

3 Getting started

Installing filters

Remove all packaging of the filters before using the appliance. Unpack them and place them into the appliance described as follows:



Note

- Make sure that you place the air purification filter in the appliance first and then the pre-filter.
- Make sure that the side with the tag is pointing towards you when installing the filter.

- 1 Pull the top part of the front cover to remove it from the appliance (fig. ③).
- 2 Press the two clips down and pull the pre-filter towards you (fig. ④).
- 3 Remove all filters (fig. ⑤).
- 4 Remove all packaging materials of the air purification filter (fig. ⑥).
- 5 Put the unpacked air purification filter into the appliance (fig. ⑦).
- 6 Put the pre-filter back into the appliance (fig. ⑧).



Note

- Make sure that all hooks of the pre-filter are properly attached to the purifier.

- 7 To reattach the front cover, mount the cover onto the bottom of the appliance first (1). Then, gently push the top of the cover against the body of the appliance (2) (fig. ⑨).

Wi-Fi connection

Setting up the Wi-Fi connection for the first time

- 1 Download and install the **"Air Matters"** app from the **App Store** or **Google play**.



- 2 Put the plug of the air purifier in the power socket and touch  to turn on the air purifier.
↳ The Wi-Fi indicator  blinks orange for the first time.
- 3 Make sure that your smartphone or tablet is successfully connected to your Wi-Fi network.
- 4 Launch the **"Air Matters"** app and click on "Connect an Air Purifier or Monitor" on the top of the screen. Follow the onscreen instructions to connect the air purifier to your network.
- 5 After the successful pairing and connection, the Wi-Fi indicator  will light up white. If pairing is not successful, consult the troubleshooting section, or the help section in the **"Air Matters"** App for extensive and up-to-date troubleshooting tips.



Note





- This instruction is only valid when the air purifier is being set up for the first time. If the network has changed or the setup needs to be performed again, consult section "Reset the Wi-Fi connection" on page 7.
- If you want to connect more than one air purifier to your smartphone or tablet, you have to do this one by one. Complete the set up of one air purifier before you turn on the other air purifier.
- Make sure that the distance between your smartphone or tablet and the air purifier is less than 10 m without any obstructions.
- This App supports the latest versions of Android and iOS. Please check www.philips.com/purifier-compatibility for the latest update of supported operating systems and devices.

Reset the Wi-Fi connection



Note

- This applies when the default network to which your purifier is connected has changed.
- Reset the Wi-Fi connection when your default network has changed.

- 1 Put the plug of the air purifier in the power socket and touch  to turn on the air purifier.
- 2 Touch  and  simultaneously for 3 seconds until you hear a beep.
 - ↳ The air purifier goes to pairing mode.
 - ↳ The Wi-Fi indicator  blinks orange.
- 3 Follow the steps 4-5 in "**Setting up the Wi-Fi connection for the first time**" section.

4 Using the appliance

Understanding the air quality light

Air quality light color	Air quality level
Blue	Good
Blue-purple	Fair
Purple-red	Poor
Red	Very poor

The air quality light automatically goes on when the air purifier is switched on, and lights up all colors in sequence. After approximately 30 seconds, the air quality sensors select the color that corresponds to the surrounding air quality of airborne particles.

The color of the air quality light is determined by the highest level among IAI, Gas and PM2.5 readings.

IAI

The professional-grade **AeraSense** sensor detects the level of indoor air allergen and with numerical feedback from 1 to 12 the potential risk level of indoor air allergens can be displayed. 1 indicates best air quality.

IAI level	Air quality light color
1-3	Blue
4-6	Blue-purple
7-9	Purple-red
10-12	Red

GAS

With an advanced gas sensor, a display ranging from L1 to L4 shows the level change of potential harmful gases (incl. VOC, odor, etc.) detected. L1 indicates best air quality.

Gas level	Air quality light color
L1	Blue
L2	Blue-purple
L3	Purple-red
L4	Red

PM2.5

AeraSense sensing technology accurately detects and quickly responds to even the slightest particle change in the air. It provides you with reassurance with real-time PM2.5 feedback.

Most of the indoor air pollutants fall under PM2.5 – which refers to airborne particle pollutants smaller than 2.5 micrometers. Common indoor sources of fine particles are tobacco smoke, cooking, burning candles. Some airborne bacteria and the smallest mold spores, pet allergen and dust mite allergen particles also fall under PM2.5.



PM2.5 level	Air quality light color
≤12	Blue
13-35	Blue-purple
36-55	Purple-red
>55	Red

Turning on and off



Note

- Always place the air purifier on a stable, horizontal, and level surface with the front of the unit facing away from walls or furniture.
- For optimum purification performance, close doors and windows.
- Keep curtains away from the air inlet or air outlet.
- Do not block the inlet or air outlet with clothing.

- 1 Put the plug of the air purifier in the wall outlet.
 - ↳ The air purifier beeps.
 - ↳ All lights go on once and then go out again.
- 2 Touch the  button to switch on the appliance (fig. ⑩).
 - ↳ The air purifier operates under the general mode by default.
 - ↳ When the air purifier is warming up, "----" displays on the screen.
 - ↳ After 30 seconds, the air purifier shows the highest level among IAI/Gas/PM2.5 on the screen. The air quality sensor automatically selects the appropriate air quality light color (fig. ⑪).
- 3 Touch and hold the  button for 3 seconds to switch off the air purifier.



Note



- If the air purifier stays connected to the electrical outlet after turning OFF, the air purifier will operate under the previous settings when turned ON again.

Changing the Auto mode setting

You can choose 4 auto modes: the general mode, the Allergen mode, the Gas mode or the Pollution mode.

Auto general mode

The Auto general mode is designed to fast respond to even the slightest change in the air that automatically adjust fan speed to ensure optimal performance.

- Touch the Auto mode button  to select Auto general mode (fig. 12).
 - ↳ Auto () displays on the screen for 3 seconds.
 - ↳ Then the screen shows the highest level among PM2.5/ Gas/IAI.

Auto allergen mode

The extra-sensitive Auto allergen mode is designed to react to even a small change in allergen levels in the surrounding air (fig. 13).

- Touch the Auto mode button  to select the Auto allergen mode.
 - ↳ The IAI level displays on the screen.

Auto Gas mode

The specially designed Auto Gas mode is designed to quickly remove indoor harmful gases such as formaldehyde (normally found in plywood), toluene (normally found in painting), carpet, natural gas, burning, cooking, air refresher, perfume and hair spray, cleaning agents, smoking, pesticide etc. and maintain it at safe level (fig. 14).

- Touch the Auto mode button  to select the Auto Gas mode.
 - ↳ The Gas level displays on the screen.

Auto pollution mode

The specially designed auto pollution mode responds to real time particle level and effectively remove airborne pollutants such as PM2.5 (fig. 15).

- Touch the Auto mode button  to select the Auto pollution mode.
 - ↳ Then the PM2.5 level displays on the screen..

Changing the fan speed

There are several fan speeds available.

When using the manual fan speed settings, the purifier will still monitor the air quality, but it will not automatically adjust the fan speed if it detects changes in the air quality.

Sleep mode (☾)

In sleep mode, the air purifier operates quietly at a very low speed.

- Touch the fan speed button (⊗) to select the sleep mode (fig. ⑮).
 - ↳ The "SL" displays on the screen for 3 seconds and then disappears.
 - ↳ The sleep mode indicator (☾) goes on.
 - ↳ After 3 seconds, all the icons are off, only the sleep mode indicator (☾) goes on.

Manual

- Touch the fan speed button (⊗) repeatedly to select the fan speed you need (speed 1 or speed 2) (fig. ⑰):
 - ↳ After 3 seconds, the display shows the previous mode.

Tip

- If the air quality light lights up blue, it indicates that the air quality is good, and you can select a lower fan speed. On the other hand, if the air quality light lights up red-purple or red, it indicates that the air quality is unhealthy, and you can select a higher fan speed to purify the air more quickly.

Turbo(t)

In Turbo mode, the air purifier operates on the highest speed.

- Touch the fan speed button (⊗) to select the Turbo mode (t) (fig. ⑱).
 - ↳ The "t" displays on the screen.
 - ↳ After 3 seconds, the display shows the previous mode.

Using the light on/off function

With the light on/off button, you can switch on or off the air quality light, the display screen and the function indicator if desired.

- 1 Touch the light on/off button (☼) once, the air quality light and all buttons will go off and the screen be dimmed (fig. ⑲).
- 2 Touch the light on/off button (☼) again, all lights will be on again (fig. ⑳).

Setting the child lock

You can use this function through the **Air Matters App**. When the function is enabled, the child lock indicator (🔒) displays on the screen, all the other buttons are not responsive. (fig. ㉑).

5 Cleaning

Note

- Always unplug the appliance before you clean it.
- Never immerse the appliance in water or any other liquid.
- Never use abrasive, aggressive, or flammable cleaning agents such as bleach or alcohol to clean any part of the appliance.
- Only the pre-filter is washable. The air purifier filter is not washable nor vacuum cleanable.

Cleaning schedule

Frequency	Cleaning method
When necessary	Wipe the surface of the appliance with a soft dry cloth
	Clean the air outlet cover
Every two months	Clean the air quality sensor with a dry cotton swab
When the pre-filter cleaning indicator  lights up and F0 displays on the screen	Clean the pre-filter

Cleaning the body of the appliance

Regularly clean the inside and outside of the appliance to prevent dusts from collecting.

- 1 Wipe away dust with a soft dry cloth from the body of the appliance.

Cleaning the air quality sensor

Clean the air quality sensor every two months for optimal functioning of the appliance. Clean it more frequently if you use the appliance in a dusty environment.

Note

- If the air purifier is used in a dusty environment, it may need to be cleaned more often.
- If the humidity level in the room is very high, condensation may develop on the air quality sensor and the air quality light may indicate a more poor air quality even though the air quality is actually good. If this occurs, clean the air quality sensor or use the air purifier on a manual speed setting.

- 1 Clean the inlet and outlet of the air quality sensor with a soft brush (fig. 22).
- 2 Remove the air quality sensor cover (fig. 23).

- 3 Clean the air quality sensor, the dust inlet and the dust outlet with a damp cotton swab (fig. ②④).
 - 4 Dry all parts thoroughly with a dry cotton swab.
 - 5 Reattach the air quality sensor cover (fig. ②⑤).
-
- 7 To reattach the front cover, mount the cover onto the bottom of the appliance first (1). Then, gently push the top of the cover against the body of the appliance (2) (fig. ⑨).
 - 8 Put the plug of the air purifier in the wall outlet.
 - 9 Touch the  button to switch on the appliance.
 - 10 Touch and hold the reset button  for 3 seconds to reset the pre-filter cleaning time.
 - 11 Wash your hands thoroughly after installing filters.

Cleaning the pre-filter

Clean the pre-filter when  lights up and F0 is displayed on the screen (fig. ②⑥).

- 1 Switch off the air purifier and unplug from the wall outlet.
- 2 Pull the top part of front cover to remove it from the appliance (fig. ③).
- 3 Press the two clips down and pull the pre-filter towards you (fig. ④).
- 4 If the pre-filter is very dirty, use a soft brush to brush away the dust. Then wash the pre-filter under running tap water (fig. ②⑦).
- 5 Allow the pre-filter to air dry thoroughly before placing back in the air purifier.
- 6 Put the pre-filter back into the appliance (fig. ⑧).



Note

- Make sure that the pre-filters are completely dry before you put them back in the appliance. If they are still wet, bacteria may multiply in them and shorten the lifetime of the pre-filters.

6 Replacing the air purification filters

Understanding the healthy air protect lock

This air purifier is equipped with a filter replacement indicator to make sure that the air purification filter is in optimal condition when the air purifier is operating. When the filters need to be replaced, the filter code displays on the screen and the filter replacement alert () lights up red. If the filters are not replaced in time, the air purifier will stop operating and automatically lock to protect the air quality in the room. Replace the filters as soon as possible according to the filter code.



Replacing the filters



Note

- The air purification filters are not washable or reusable.
- Always turn off the air purifier and unplug from the electrical outlet before replacing the filters.
- Do not clean the filters with a vacuum.
- If the pre-filter is damaged, worn or broken, do not use. Visit www.philips.com/support or contact the Consumer Care Center in your country.



Filter alert chart (fig. )

Filter alert light status	Action
A5 displays on the screen and the filter replacement alert  goes on.	Replace the NanoProtect filter HEPA Series 3 (FY3433)
C7 displays on the screen and the filter replacement alert  goes on.	Replace the NanoProtect filter Active Carbon (FY3432)
A5 and C7 display on the screen alternately and the filter replacement alert  goes on.	Replace both filters

- 1 Turn off the air purifier and unplug from the power socket.
- 2 Take out the used air filter according to the filter alert light status displayed on the screen. Discard used filters (fig. 29).

Note

- Do not touch the pleated filter surface, or smell the filter as it has collected pollutants from the air.

- 3 Remove all packaging material of the new filters (fig. 6).
- 4 Put the unpacked air purification filters back into the appliance (fig. 7).
- 5 Put the plug of the air purifier in the power socket.
- 6 Touch the  button to switch on the appliance.
- 7 Touch and hold the reset button  for 3 seconds to reset the filter lifetime counter.

Note

- Wash your hands after changing filters.

7 Storage

- 1 Turn off the air purifier and unplug from the wall outlet.
- 2 Clean the air purifier, air quality sensor and pre-filter (see chapter 'Cleaning').
- 3 Let all parts air dry thoroughly before storing.
- 4 Wrap the filters and pre-filter separately in air tight plastic bags.
- 5 Store the air purifier, filters and pre-filters in a cool, dry location.
- 6 Always thoroughly wash hands after handling filters.

8 Troubleshooting

This chapter summarizes the most common problems you could encounter with the appliance. If you are unable to solve the problem with the information below, contact the Consumer Care Center in your country.

Problem	Possible solution
The appliance does not work even though it is plugged in.	<ul style="list-style-type: none">• Check if the top cover is properly installed.• The filter replacement light has been on continuously but you have not replaced the corresponding filter. As a result, the appliance is now locked. In this case, replace the filter and reset the filter lifetime counter.
The airflow that comes out of the air outlet is significantly weaker than before.	<ul style="list-style-type: none">• The pre-filter is dirty. Clean the pre-filter (see the chapter "Cleaning").
The air quality does not improve, even though the appliance has been operating for a long time.	<ul style="list-style-type: none">• Check if the packing material is removed from the filters.• One of the filters has not been placed in the appliance. Make sure that all filters are properly installed in the following order, starting with the innermost filter:<ol style="list-style-type: none">1) NanoProtect filter HEPA Series 3 (FY3433);2) NanoProtect filter Active Carbon (FY3432);3) pre-filter.• The air quality sensor is wet. The humidity level in your room is high and causes condensation. Make sure that the air quality sensor is clean and dry (see the chapter "Cleaning").
The color of the air quality light always stays the same.	<ul style="list-style-type: none">• The air quality sensor is dirty. Clean the air quality sensor (see the chapter "Cleaning").

Problem	Possible solution
The appliance produces a strange smell.	<ul style="list-style-type: none"> The first few times you use the appliance, it may produce a plastic smell. This is normal. However, if the appliance produces a burnt smell even if removing filters, contact your Philips dealer or an authorized Philips service center. The filter may produce smell after being used for a while because of the absorption of indoor gases. It's recommended that you reactivate the filter by putting it in direct sunlight for repeated use. If odor still exists, replace the filter.
The appliance is extra loud.	<ul style="list-style-type: none"> If the appliance is too loud, you can change the fan speed to a lower fan speed level. When using the appliance in a bedroom at night, choose the silent speed.
The appliance still indicates that I need to replace a filter, but I already did.	<ul style="list-style-type: none"> Perhaps you did not reset the filter lifetime counter. Switch on the appliance. Then touch and hold the reset button (↶) for 3 seconds.
Error code "E1" displays on the screen.	<ul style="list-style-type: none"> The motor has malfunctions. Contact the Consumer Care Center in your country.
Error codes "E2", "E3", "E4" or "E5" displays on the screen.	<ul style="list-style-type: none"> The sensor has malfunctions. Contact the Consumer Care Center in your country.

Problem	Possible solution
The Wi-Fi setup is not successful.	<ul style="list-style-type: none"> • If the router your purifier is connected to is dual – band and currently it is not connecting to a 2.4GHz network, please switch to another band of the same router (2.4GHz) and try to pair your purifier again. 5GHz networks are not supported. • Web authentication networks are not supported. • Check if the purifier is within range of the Wi-Fi router. You can try to locate the air purifier closer to the Wi-Fi router. • Check if the network name is correct. The network name is case-sensitive. • Check if the Wi-Fi password is correct. The password is case-sensitive. • Retry the setup with the instructions in section ‘Set up the Wi-Fi connection when the network has changed’. • The Wi-Fi connectivity can be interrupted by electromagnetic or other interferences. Keep the appliance away from other electronic devices that may cause interferences. • Check if the mobile device is in airplane mode. Make sure to have the airplane mode deactivated when connecting to the Wi-Fi network. • Consult the help section in the App for extensive and up-to-date troubleshooting tips.

9 Guarantee and service

If you need information or if you have a problem, please visit the Philips website at www.philips.com or contact the Philips Consumer Care Center in your country (you can find its phone number in the worldwide guarantee leaflet). If there is no Consumer Care Center in your country, go to your local Philips dealer.

Order parts or accessories

If you have to replace a part or want to purchase an additional part, go to your Philips dealer or visit www.philips.com/support.

If you have problems obtaining the parts, please contact the Philips Consumer Care Center in your country (you can find its phone number in the worldwide guarantee leaflet).

10 Notices

Electromagnetic fields (EMF)

This Philips appliance complies with all applicable standards and regulations regarding exposure to electromagnetic fields.

Compliance with EMF

Koninklijke Philips N.V. manufactures and sells many products targeted at consumers, which, like any electronic apparatus, in general have the ability to emit and receive electromagnetic signals.

One of Philips' leading Business Principles is to take all necessary health and safety measures for our products, to comply with all applicable legal requirements and to stay well within the EMF standards applicable at the time of producing the products.

Philips is committed to develop, produce and market products that cause no adverse health effects. Philips confirms that if its products are handled properly for their intended use, they are safe to use according to scientific evidence available today.

Philips plays an active role in the development of international EMF and safety standards, enabling Philips to anticipate further developments in standardization for early integration in its products.

Recycling

Do not throw away the product with the normal household waste at the end of its life, but hand it in at an official collection point for recycling. By doing this, you help to preserve the environment.

Follow your country's rules for the separate collection of electrical and electronic products. Correct disposal helps prevent negative consequences for the environment and human health.

Notice

App Store is a service mark of Apple Inc.

Google Play is a trademark of Google Inc.

“Air Matters” app developed by Air Matters Network Pty Ltd.

This Philips appliance and Air Matters app applied multiple open source softwares, Copies of open source software license text used in this product can be derived from website: www.philips.com/purifier-compatibility.

目錄

1 重要事項	22
安全	22
2 您的空氣清淨機	24
產品概覽 (圖 ①)	24
控制項目概覽 (圖 ②)	24
3 快速入門	25
安裝濾網	25
Wi-Fi 連線	25
4 使用產品	26
瞭解空氣品質指示燈	26
開關機	27
變更自動模式設定	28
變更風速	28
使用開/關燈按鈕	29
設定兒童鎖	29
5 清潔	29
清潔排程	29
清潔產品機體	29
清潔空氣品質感測器	30
清潔前層濾網	30
6 更換濾網	31
瞭解健康空氣保護鎖	31
更換濾網	31
7 收納	32
8 疑難排解	33

9 保固與服務	35
訂購零件或配件	35
10 聲明	35
電磁場 (EMF)	35
回收	35
注意	36

1 重要事項

安全

在使用本產品前，請先仔細閱讀本使用手冊，並保留使用手冊以供日後參考。

危險

- 請勿讓水或其他液體，或是易燃清潔劑進入產品內，以避免觸電和 / 或火災。
- 請勿用水、其他液體，或是 (易燃) 清潔劑清潔產品，以避免觸電和 / 或火災。
- 請勿在產品周圍噴灑殺蟲劑或芳香劑等任何易燃物質。

警告

- 插電之前請先確認產品標示的電壓是否與當地使用的電壓相符。
- 如果電源線損壞，您必須將其交由飛利浦、飛利浦授權之服務中心，或是具備相同資格的技師進行更換，以免發生危險。
- 當插頭、電源線或產品本身受損時，請勿使用本產品。
- 本產品可供 8 歲以上孩童及身體、知覺或精神能力障礙者或經驗與知識缺乏者使用，但需向他們提供安全使用產品相關的監督或指示說

明，且他們必須瞭解可能發生的危險。請勿讓孩童把玩本產品。若無人在旁監督，不得讓孩童清潔與維護本產品。

- 請勿在出風口上方或進風口前面放置物品，擋住進出風口。
- 確定沒有異物透過出風口掉入產品。
- 2.4 GHz 802.11b/g/n 標準 WiFi 介面，最大輸出功率為 31.62 mW EIRP。

注意

- 本產品不可用來作為維持良好通風的設備、替代吸塵器清潔，或烹調時用來當作抽油煙機使用。
- 如果供應產品電力的電源插座接觸不良，產品插頭會發熱。請確定將產品插頭插入接觸良好的插座。
- 請一律將本產品放置在乾燥平穩的水平面上使用。
- 產品的背面及側面須至少保留 20 公分的間隔距離，頂部則至少保留 30 公分的間隔距離。
- 產品頂部請勿放置任何物品。

- 請勿坐在或站在產品上。站或坐在本產品上可能引發潛在傷害。
- 請勿將產品放置在冷氣機正下方，以免冷氣機滴水，造成產品發生水滴凝結的現象。
- 請在開啟產品電源前，先確認所有濾網皆已正確安裝。
- 請僅使用產品專用的飛利浦原廠濾網。請勿使用其他濾網。
- 燃燒濾網可能會對人體造成不可逆危險和/或危及其他生命。請勿將濾網當成燃料，或以類似目的使用濾網。
- 切勿使用硬物敲打產品 (特別是進風口及出風口)。
- 請務必使用產品背面的握把提起或搬動產品。
- 請勿將手指或物體插入出風口或進風口，以避免身體受傷或損壞產品。
- 當您使用室內噴霧式驅蟲劑或在充滿油漬、燒香或化學煙霧的地方時，請勿使用本產品。
- 請勿在燃氣設備、加熱裝置或壁爐附近使用本產品。
- 使用完畢後，以及在進行清潔或其他維修或更換濾網之前，請務必先拔除產品的電源插頭。
- 請勿在溫差變化極大的室內使用本產品，因為室溫差距太大會造成產品內部凝結水珠。
- 請將本產品遠離使用無線電電波的電器至少 2 公尺以避免干擾，例如電視、無線電廣播、無線電信號控制的時鐘。
- 本產品為家用產品，僅限於在正常操作環境下使用。
- 請勿在極為潮濕或周遭溫度很高的環境下使用本產品，例如浴室、廁所或廚房。
- 本產品無法清除一氧化碳 (CO) 或氫氣 (Rn)。發生燃燒意外及危險化學物品意外時，本產品無法當作安全裝置使用。
- 若您需要搬動產品，請先切斷產品電源供應。
- 請勿以拉動電源線的方式移動本產品。
- 更換濾網後請務必清潔雙手。

2 您的空氣清淨機

感謝您購買本產品。歡迎來到飛利浦的世界！

請至 www.philips.com/welcome 註冊您的產品，以獲得飛利浦提供的完整支援。

本產品可搭配空氣過濾系統使用。在使用本產品前，請先仔細閱讀本使用手冊，並保留使用手冊以供日後參考。

產品概覽 (圖 ①)

A 顯示面板

B 空氣品質指示燈

C 奈米級勁護 HEPA 濾網*
(FY3433)

D 奈米級勁護 活性碳濾網*
(FY3432)

E 前層濾網

F 控制按鈕

G 前蓋

H 空氣品質感測器

*在此簡稱為「濾網」。

控制項目概覽 (圖 ②)

控制按鈕

 電源開/關按鈕

 指示燈調光按鈕

 自動模式按鈕

 風速按鈕

 重設按鈕

顯示面板：

 Wi-Fi 指示燈

Gas 氣體指示燈

PM2.5 PM2.5 指示燈

IAI 室內過敏原指數

 濾網更換提示

 睡眠模式

 前層濾網清潔提示

 兒童鎖指示燈**

**您可以透過在意空氣應用程式啟用兒童鎖功能。

3 快速入門

安裝濾網

使用本產品前，請先拆下濾網所有包裝材料。拆下後，再將其裝回產品中，如下所述：

≡ 備註

- 務必先將濾網裝入產品，再裝前層濾網。
- 安裝濾網時，請確認有拉片的一側朝向自己。

- 1 拉出前蓋的頂部，將它從產品中取出 (圖 ③)。
- 2 按壓兩個固定夾，再朝自己的方向拉出前層濾網 (圖 ④)。
- 3 取出所有濾網 (圖 ⑤)。
- 4 拆下濾網的所有包裝材料 (圖 ⑥)。
- 5 將拆下包裝的濾網放入產品 (圖 ⑦)。
- 6 將前層濾網裝入產品 (圖 ⑧)。

≡ 備註

- 請確認前層濾網的所有扣鉤皆已正確裝入清淨機。



- 7 若要重新裝入前蓋，請先將蓋子掛上產品底部 (1)。接著，輕輕將蓋子頂部推入產品機體 (2) (圖 ⑨)。

Wi-Fi 連線

第一次設定 Wi-Fi 連線

- 1 下載並安裝「在意空氣」應用程式：App Store 或 Google Play。

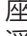

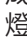
- 2 將空氣清淨機的插頭插入電源插座，然後按下  以開啟空氣清淨機。
↳ 第一次使用時，Wi-Fi 指示燈  會閃爍橘光。
- 3 請確定智慧型手機或平板裝置已成功連線至您的 Wi-Fi 網路。
- 4 啟動「在意空氣」應用程式，並按一下畫面頂端的「Connect an Air Purifier or Monitor」(連接清淨機或檢測器)。依照螢幕指示將空氣清淨機連接至您的網路。
- 5 成功配對和連線後，Wi-Fi 指示燈  會亮起白光。如果配對不成功，請參閱疑難排解部分，或「在意空氣」應用程式的說明部分，以深入掌握最新的疑難排解秘訣。





備註

- 此說明僅在第一次設定空氣清淨機時才適用。如果網路已變更或需要再次執行設定，請參閱第 26 頁的「重設 Wi-Fi 連線」部分。
- 如要將一台以上的空氣清淨機連線到智慧型手機或平板裝置，必須逐一設定。請先完成一台空氣清淨機的設定後，再開啟其他空氣清淨機。
- 務請確定您的智慧型手機或平板裝置與空氣清淨機之間的距離少於 10 公尺，且沒有任何阻礙物。
- 本應用程式支援最新版 Android 和 iOS。請至 www.philips.com/purifier-compatibility 查看最新更新的支援作業系統和裝置。

重設 Wi-Fi 連線

備註

- 這適用於空氣清淨機連線的預設網路已變更時。
- 在預設網路已變更時重設 Wi-Fi 連線。

- 1 將空氣清淨機的插頭插入電源插座，然後按下  以開啟空氣清淨機。
- 2 同時按下  和  3 秒鐘，直到聽到嗶聲。
 - ↳ 此時空氣清淨機會進入配對模式。
 - ↳ Wi-Fi 指示燈  會閃爍橘光。
- 3 請依照「第一次設定 Wi-Fi 連線」部分的步驟 4-5 進行。

4 使用產品

瞭解空氣品質指示燈

空氣品質指示燈顏色	空氣品質等級
藍色	良好
藍色 - 紫色	一般
紫色 - 紅色	不健康
紅色	非常不健康

空氣清淨機電源開啟後，空氣品質指示燈會自動亮起，並依序閃爍所有燈色。在約 30 秒後，空氣品質感測器會選擇符合周遭空氣粒子品質的相應顏色。

空氣品質指示燈的顏色取決於 IAI、氣體及 PM2.5 讀數間的最高等級。

IAI

專業級的 AeraSense 感測器能偵測到室內空氣過敏原的等級，並提供 1 到 12 的數據回饋資訊，顯示室內空氣過敏原的潛在危險等級。1 表示空氣品質最佳。

IAI 等級	空氣品質指示燈顏色
1-3	藍色
4-6	藍色 - 紫色
7-9	紫色 - 紅色
10-12	紅色

氣體

配備進階氣體感測器，範圍從 L1 到 L4 的指示燈會顯示潛在有害氣體的等級變更 (包括揮發性有機物 (VOC)、異味等)。L1 表示空氣品質最佳。

氣體等級	空氣品質指示燈顏色
L1	藍色
L2	藍色 - 紫色
L3	紫色 - 紅色
L4	紅色

PM2.5

AeraSense 感應技術能夠精確地偵測到空氣中最細小的微粒變化並快速反應。還能提供即時的 PM2.5 回饋資訊，讓您安心無憂。



大部分室內空氣汙染物未達 PM2.5 – 代表空氣微粒汙染物小於 2.5 微米。一般室內細小粒子來源為煙味、烹飪與燃燒的蠟燭。部分空氣中傳播的細菌和最小的黴菌孢子、寵物過敏原及塵蟎過敏原粒子也未達 PM2.5。

PM2.5 等級	空氣品質指示燈顏色
≤12	藍色
13-35	藍色 - 紫色
36-55	紫色 - 紅色
>55	紅色

開關機

備註

- 請務必將空氣清淨機放在平穩的水平表面上，產品正面背對牆壁或家具。
- 為達最佳淨化效能，請關閉門窗。
- 進風口或出風口需遠離窗簾。
- 請勿以衣物擋住進風口或出風口。

- 1 將空氣清淨機的插頭插入電源插座。
 - ↳ 空氣清淨機會發出嗶聲。
 - ↳ 所有燈號亮一次後，再次熄滅。
- 2 觸控  按鈕 以開啟產品電源 (圖 ⑩)。
 - ↳ 空氣清淨機預設以一般模式運作。
 - ↳ 空氣清淨機正在暖機時，螢幕上會顯示「---」。
 - ↳ 30 秒後，空氣清淨機螢幕會顯示 IAQ/Gas/PM2.5 間的最高等級。空氣品質感測器會自動選擇適當的空氣品質指示燈顏色 (圖 ⑪)。
- 3 按住  按鈕 3 秒鐘即可關閉空氣清淨機的電源。

備註

- 如果空氣清淨機在關閉之後保持連接至電源插座，則當空氣清淨機再次開啟時，會以先前的設定運作。

變更自動模式設定

您可以選擇 4 種自動模式：

一般模式、過敏原模式、氣體模式或污染源模式。

一般模式

一般模式經專門設計，即使空氣中最微小的變化，亦可快速回應自動調整風扇速度，以確保最佳效能。

- 按下自動模式按鈕 ，以選擇一般模式。(圖 12)。
 - 螢幕隨即顯示自動 (A) 3 秒鐘。
 - 接著，螢幕會顯示 PM2.5/Gas/IAI 間的最高等級。

過敏原模式

超敏感的過敏原模式經專門設計，即使周遭空氣中的過敏原等級只有小幅度變化，亦可做出因應(圖 13)。

- 按下自動模式按鈕 ，以選擇過敏原模式。
 - 螢幕會顯示 IAI 等級。

氣體模式

特殊設計的氣體模式可快速去除室內有害氣體，例如甲醛(一般位於膠合板內)、甲苯(一般位於油漆內)、地毯、天然氣、燃燒、烹飪、空氣清新劑、香水及噴霧造型品、清潔劑、吸煙、殺蟲劑等，並將其維持在安全等級(圖 14)。

- 按下自動模式按鈕 ，以選擇氣體模式。
 - 螢幕會顯示氣體等級。

污染源模式

特殊設計污染源模式可回應即時微粒含量，並有效地去除空氣傳播的污染物，例如 PM2.5 (圖 15)。

- 觸控自動模式按鈕 ，以選擇污染源模式。
 - 螢幕會顯示 PM2.5 等級。



變更風速

有多種風扇速度可選擇。

使用手動風速設定時，清淨機還是會監控空氣品質，但不會在偵測到空氣品質發生變化時自動調整風速。

睡眠模式 (C)

在睡眠模式中，空氣清淨機會以非常低的速度安靜地運作。

- 按下風速按鈕  以選擇睡眠模式(圖 16)。
 - 螢幕上會顯示「SL」3 秒後消失。
 - 睡眠模式指示燈  會亮起。
 - 所有圖示 3 秒後都會熄滅，只有睡眠模式指示燈  會亮起。

手動

- 重複按下風速按鈕  以選擇所需風速(速度 1 或速度 2)(圖 17)：
 - 顯示幕 3 秒後會顯示先前模式。

提示

- 如果空氣品質指示燈顯示藍色，表示空氣品質良好，您可選擇較低的風速。另一方面，如果空氣品質指示燈顯示為紅色 - 紫色或紅色，表示空氣品質有害健康，您可以選擇較高風速快速地淨化空氣。

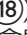

超高速 (t)

在超高速模式下，空氣清淨機會以最高速度運作。

- 按下風速按鈕 ，以選擇超高速模式 () (圖 18)。
- ↳ 螢幕上會顯示「t」。
- ↳ 顯示幕 3 秒後會顯示先前模式。

使用開/關燈按鈕

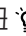
透過指示燈調光按鈕，就能視需要開啟或關閉空氣品質指示燈、顯示螢幕及功能指示燈。

- 按一下指示燈調光按鈕 ，空氣品質指示燈和所有按鈕隨即熄滅，螢幕會變暗 (圖 19)。
- 再次按下指示燈調光按鈕 ，所有燈號即會再次亮起 (圖 20)。

設定兒童鎖

您可以透過在意空氣應用程式使用此功能。此功能啟用時，螢幕上會顯示兒童鎖指示燈 ，所有其他按鈕不會有反應。(圖 21)。

5 清潔



備註

- 進行清潔前，請務必先拔掉電源插頭。
- 切勿將產品浸入水中或其他液體中。
- 切勿使用漂白劑或酒精等具磨蝕性、刺激性或易燃性的洗劑清潔產品的任何部分。
- 只有前層濾網可水洗。空氣清淨機濾網不得清洗，亦不得使用吸塵器清潔。

清潔排程

頻率	清潔方法
必要時	用柔軟的乾布擦拭產品表面
	清潔空氣出風口護蓋
每兩個月	使用乾棉棒清潔空氣品質感測器
當前層濾網清潔指示燈  亮起，且螢幕上顯示 FO	清潔前層濾網

清潔產品機體

定期清潔產品內部與外殼，可避免累積灰塵。

- 請使用柔軟乾布擦拭產品內外布以及出風口處。

清潔空氣品質感測器

每兩個月清潔空氣品質感測器，使產品發揮最佳功效。如果在佈滿灰塵的環境中使用產品，就要更常進行清潔。

≡ 備註

- 若在佈滿灰塵的環境中使用空氣清淨機，可能需要更常清潔。
- 若房間溼度過高，空氣品質感測器可能有水滴凝結，在這種情況下，縱使空氣品質良好，空氣品質指示燈也可能指示空氣品質不佳。若發生此種情形，請清潔空氣品質感測器，或依手動風速設定使用本空氣清淨機。

- 1 使用軟刷清潔空氣品質感測器的進風口和出風口 (圖 22)。
- 2 取下空氣品質感測器的護蓋 (圖 23)。
- 3 請使用溼棉棒清潔空氣品質感測器、覆有灰塵的進風口和出風口 (圖 24)。
- 4 使用乾棉棒擦乾所有零件。
- 5 重新裝上空氣品質感測器的護蓋 (圖 25)。

清潔前層濾網

當  亮起且螢幕顯示 F0 時，請清潔前層濾網 (圖 26)。

- 1 關閉空氣清淨機的電源，從電源插座拔掉插頭。
- 2 拉出前蓋的頂部，將它從產品中取出 (圖 3)。
- 3 按壓兩個固定夾，再朝自己的方向拉出前層濾網 (圖 4)。
- 4 若前層濾網很髒，請使用軟刷來清除灰塵。接著，以流動的自來水清洗前層濾網 (圖 27)。
- 5 先確保前層濾網徹底風乾後，再放回空氣清淨機。
- 6 將前層濾網裝入產品 (圖 8)。

≡ 備註

- 確認前層濾網皆已完全乾燥後，才可將其放回產品中。如果前層濾網未乾，細菌可能會在其中滋生，造成其使用壽命縮短。

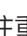
- 7 若要重新裝入前蓋，請先將蓋子掛上產品底部 (1)。接著，輕輕將蓋子頂部推入產品機體 (2) (圖 9)。
- 8 將空氣清淨機的插頭插入電源插座。
- 9 觸控  按鈕 以開啟產品電源。
- 10 按住重設按鈕  3 秒以重設前層濾網清潔時間。
- 11 裝好濾網後，請徹底清潔雙手。

6 更換濾網

瞭解健康空氣保護鎖

本空氣清淨機配備了濾網更換指示燈，用以確認空氣清淨機運作時濾網處於最佳狀態。濾網需要更換時，螢幕上會顯示濾網代碼，且濾網更換提示  會亮紅燈。



若未及時更換濾網，空氣清淨機會停止運作並自動鎖定，以保護房內的空氣品質。請根據濾網代碼盡速更換濾網。

更換濾網

備註

- 濾網不得水洗或重複使用。
- 更換濾網前，請務必關閉空氣清淨機電源，再從電源插座拔掉插頭。
- 請勿使用吸塵器清潔濾網。
- 如果前層濾網損壞、磨損或破裂，則請勿使用。請造訪 www.philips.com/support 或聯絡您所在國家/地區的客戶服務中心。



濾網更換提示表 (圖 28)

濾網更換提示燈	動作
螢幕上會顯示 A5，且濾網更換提示  亮起。	更換奈米級勁護 HEPA 濾網 (FY3433)
螢幕上會顯示 C7，且濾網更換提示  亮起。	更換奈米級勁護活性碳濾網 (FY3432)
螢幕上會交替顯示 A5 和 C7，且濾網更換提示  會亮起。	更換兩個濾網

- 1 關閉空氣清淨機的電源，從電源插座拔掉插頭。
- 2 根據螢幕顯示的濾網提示燈狀態取出用過的空氣濾網。請丟棄用過的濾網 (圖 29)。

備註

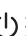
- 請勿碰觸有皺摺的濾網表面或嗅聞濾網，因為它收集了空氣中的污染物。

- 3 拆下新濾網的所有包裝材料 (圖 ⑥)。
- 4 將拆下包裝的濾網放回產品中 (圖 ⑦)。
- 5 將空氣清淨機的插頭插入電源插座。
- 6 觸控  按鈕 以開啟產品電源。
- 7 按住重設按鈕  3 秒鐘，可重設濾網使用壽命計數器。

備註

- 更換濾網後請清洗雙手。

7 收納

- 1 關閉空氣清淨機的電源，從電源插座拔掉插頭。
- 2 清潔空氣清淨機、空氣品質感測器和前層濾網 (參閱「清潔」單元)。
- 3 收納之前，請確保所有零件徹底風乾。
- 4 將濾網和前層濾網分別包在氣密塑膠袋中。
- 5 將空氣清淨機、濾網和前層濾網存放在涼爽乾燥處。
- 6 接觸過濾網後，請務必徹底清洗雙手。

8 疑難排解

本單元概述您使用本產品時可能遇到的最常見問題。如果您無法利用以下資訊解決您遇到的問題，請聯絡您所在國家/地區的客戶服務中心。

問題	可能的解決方法
產品即使已插電也無法運作。	<ul style="list-style-type: none"> 請檢查頂蓋是否已正確安裝。 濾網更換指示燈持續亮起時，但卻未更換相應濾網。結果導致產品鎖定。在此情況下，請更換濾網並重設濾網使用壽命計數器。
出風口流出的風速比之前慢很多。	<ul style="list-style-type: none"> 前層濾網髒污。清潔前層濾網 (參閱「清潔」單元)。
即使產品已經長時間運作，空氣品質仍未獲得改善。	<ul style="list-style-type: none"> 請檢查是否已拆下濾網的包裝材料。 其中一個濾網尚未裝入產品中。請確認所有濾網皆已按照下列順序正確安裝，由內至外順序為： <ol style="list-style-type: none"> 1) 奈米級勁護 HEPA 濾網 (FY3433)； 2) 奈米級勁護活性炭濾網 (FY3432)； 3) 前層濾網。 空氣品質感測器潮溼。室內的濕度很高，造成水珠凝結。確認空氣品質感測器乾淨且乾燥 (參閱「清潔」單元)。
空氣品質指示燈的顏色一直維持不變。	<ul style="list-style-type: none"> 空氣品質感測器髒污。清潔空氣品質感測器 (參閱「清潔」單元)。
使用產品時發出異味。	<ul style="list-style-type: none"> 使用本產品的前幾分鐘，可能會產生塑膠味。此為正常現象。然而，如果取下濾網後產品依然發出焦味，請聯絡您的飛利浦經銷商或授權的飛利浦服務中心。使用一段時間之後，濾網可能會因為吸收室內氣體而產生異味。建議將濾網拿到陽光下曝曬以供重複使用。如果異味仍然存在，請更換濾網。
產品噪音太大。	<ul style="list-style-type: none"> 如果產品噪音很大聲，可將風速變更為較低的速度等級。夜間在臥室使用產品時，請選擇靜音速度。
產品不斷指示需更換濾網，但濾網已經更換了。	<ul style="list-style-type: none"> 您或許未重設濾網使用壽命計時器。開啟產品。然後按住重設按鈕 (↶) 3 秒鐘。
螢幕顯示「E1」錯誤代碼。	<ul style="list-style-type: none"> 馬達故障。請聯絡您所在國家/地區的客戶服務中心。

問題	可能的解決方法
螢幕顯示錯誤代碼「E2」、「E3」、「E4」或「E5」。	<ul style="list-style-type: none"> 感測器故障。請聯絡您所在國家/地區的客戶服務中心。
Wi-Fi 設定不成功。	<ul style="list-style-type: none"> 如果清淨機連接的路由器為雙波段，且目前並未連接至 2.4GHz 網路，請切換到相同路由器的另一個波段 (2.4GHz) 並嘗試再次配對您的清淨機。不支援 5GHz 網路。 不支援 Web 認證網路。 檢查清淨機是否位於 Wi-Fi 路由器的範圍內。您可以嘗試將空氣清淨機移近 Wi-Fi 路由器。 檢查網路名稱是否正確。網路名稱需區分大小寫。 檢查 Wi-Fi 密碼是否正確。密碼需區分大小寫。 請依照「在網路已變更時設定 Wi-Fi 連線」一節中的指示，重試設定。 Wi-Fi 連線可能受到電磁干擾或其他干擾而中斷。請讓本產品盡量遠離可能造成干擾的其他電子裝置。 檢查行動裝置是否處於飛航模式。連接至 Wi-Fi 網路時，請務必先停用飛航模式。 請參閱應用程式的說明章節，以深入掌握最新的疑難排解秘訣。

9 保固與服務

如果您需要更多資訊或有任何問題，請造訪飛利浦網站 www.philips.com 或聯絡您所在國家/地區的飛利浦客戶服務中心 (您可在全球保證書上找到電話號碼)。若您所在國家/地區沒有客戶服務中心，請洽詢當地的飛利浦經銷商。

訂購零件或配件

如果您必須更換零件或想購買其他零件，請聯絡您的飛利浦經銷商，或造訪 www.philips.com/support。

如果您有取得零件方面的問題，請聯絡您所在國家/地區的飛利浦客戶服務中心 (您可在全球保證書上找到電話號碼)。

10 聲明

電磁場 (EMF)

本飛利浦產品符合所有電磁場暴露的相關適用標準和法規。

符合 EMF 標準

Koninklijke Philips N.V. 製造銷售多項消費性產品，這些產品就如同其他電器，通常能收發電磁訊號。

飛利浦的一大企業原則，就是針對自身的產品進行必要的健康與安全檢測，以符合所有適用的法律規定，以及在產品生產期間符合適用的 EMF 標準。

飛利浦致力於開發、生產及銷售不危害健康的產品。飛利浦保證，只要依照正確用途並妥善使用，根據現有的科學研究資料，使用本公司產品並無安全顧慮。

飛利浦積極參與國際 EMF 與安全標準的開發，因此得以掌握標準化的發展，及早將標準化與自身的產品整合。

回收

產品使用壽命結束時，請勿與一般家庭廢棄物一併丟棄。請將該產品送至政府指定的回收點進行回收。此舉能為環保盡一份心力。

請遵循您所在國家/地區對電氣與電子產品分類收集的規定。正確處理廢棄產品有助於避免對環境和人類健康帶來負面影響。

注意

App Store 是 Apple Inc 的服務標章。

Google Play 是 Google Inc 的商標。

「在意空氣」應用程式是由 Air Matters Network Pty Ltd. 研發。

本飛利浦產品與「在意空氣」應用程式含有多個開放原始碼軟體，本產品使用的開放原始碼軟體授權文本副本可於此網站取得：www.philips.com/purifier-compatibility。

第十二條

經型式認證合格之低功率射頻電機，非經許可，公司、商號或使用者均不得擅自變更頻率、加大功率或變更原設計之特性以及功能。

第十四條

低功率射頻電機之使用不得影響飛航安全及干擾合法通信；經發現有干擾現象時，應立即停用，並改善至無干擾方得繼續使用。

前項合法通信，指依電信法規定作業之無線電通信。低功率射頻電機須忍受合法通信或工業、科學及醫療用電波輻射性電機設備之干擾。

設備名稱：飛利浦空氣清淨機， 型號（型式）：AC4558	
Equipment name	Type designation (Type)
單元 Unit	限用物質及其化學符號 Restricted substances and its chemical symbols
	鉛 Lead (Pb) 汞 Mercury (Hg) 鎘 Cadmium (Cd) 六價鉻 Hexavalent chromium (Cr ⁺⁶) 多溴聯苯 Polybrominated biphenyls (PBB) 多溴二苯醚 Polybrominated diphenyl ethers (PBDE)
電源線組	— ○ ○ ○ ○ ○
塑膠外殼	○ ○ ○ ○ ○ ○
電源板組件	— ○ ○ ○ ○ ○
電動機	— ○ ○ ○ ○ ○
主電路板組件	— ○ ○ ○ ○ ○

備考1：“超出0.1 wt %”及“超出0.01 wt %”係指限用物質之百分比含量超出百分比含量基準值。

Note 1: “Exceeding 0.1 wt %” and “exceeding 0.01 wt %” indicate that the percentage content of the restricted substance exceeds the reference percentage value of presence condition.

備考2：“○”係指該項限用物質之百分比含量未超出百分比含量基準值。

Note 2: “○” indicates that the percentage content of the restricted substance does not exceed the percentage of reference value of presence.

備考3：“—”係指該項限用物質為排除項目。

Note 3: The “—” indicates that the restricted substance corresponds to the exemption.