

XEL SIS

Type HD8943 / HD8944

QUICK START GUIDE - 簡要說明



Before using the machine, please read the instruction manual completely.
Carefully read the safety regulations provided in the instruction manual.

使用本機之前請閱讀使用說明。
請仔細閱讀手冊中的安全準則。



The manufacturer reserves the right to make changes without prior notice.
製造商有權對本產品做出任何更改，恕不另行通知。

Type HD8943 / HD8944 - Cod.15002478 - Rev.00 - del 15-03-10

PHILIPS

 **Saeco**

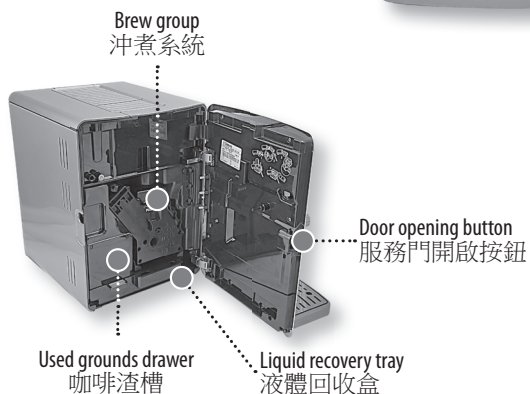
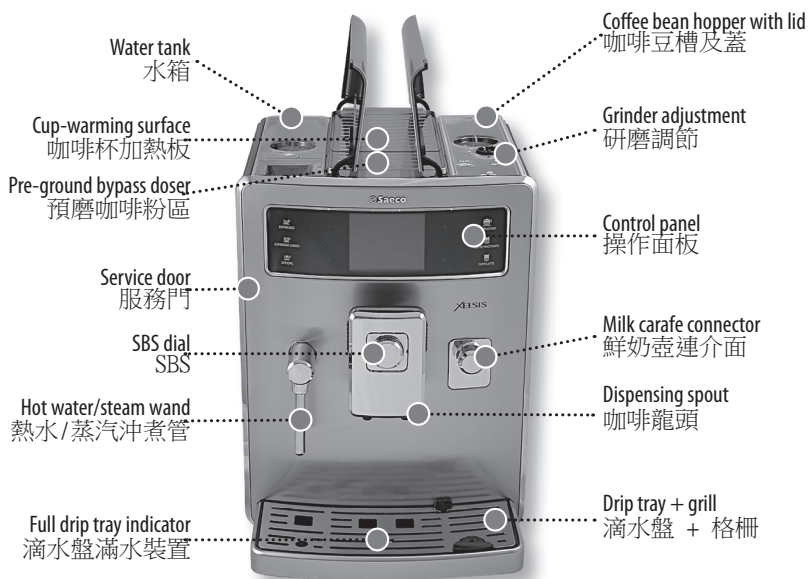

ACCESSORIES - 配件



Pre-ground coffee measuring scoop
預磨咖啡粉量匙

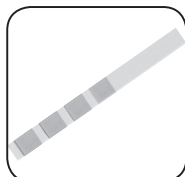

Water hardness tester
水質硬度測試



Brew group lubricant
沖煮系統潤滑劑



Descaling solution
除鈣劑



Brew group cleaning tablets
沖煮系統清潔劑



Power cord
電源線



Intenza water filter
Intenza 濾水器



Cleaning brush
清潔刷

STARTING THE MACHINE - 啟動咖啡機

Before turning on the machine, make sure that the power button is set to "0".
啟動咖啡機前，請確保電源開關位於 0 位。

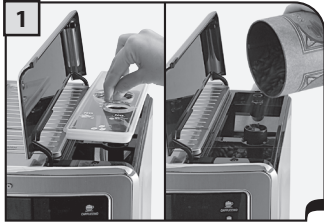

Remove the covers. Fill the hopper with coffee beans, then close the covers.

取下蓋子。添加咖啡豆。然後關閉蓋子。

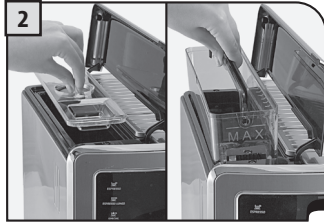

Remove the covers. Remove the water tank.

打開蓋子。取出水箱。

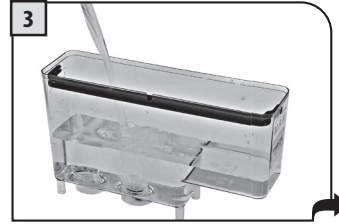

Fill the tank with fresh drinking water. Do not exceed the "max" level indicated on the water tank. Place the water tank back into the machine. 加入純淨飲用水（不要超出最大水量線）。放好水箱和蓋子。

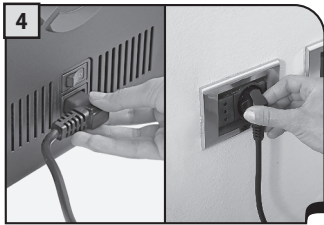

Insert the plug into the socket located on the back of the machine and insert the other end into a power outlet with suitable current.

將電源插頭插入咖啡機和相應插座中（參見標籤上的規格資料）。



Adjust the dispensing spout and place a cup beneath it.

調節咖啡龍頭並放上杯子。

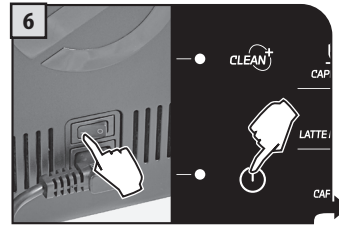

Set the power button to the "I" position. Press the stand-by button to start the machine.

將電源開關置於 I 位置。按下該按鈕啟動咖啡機。

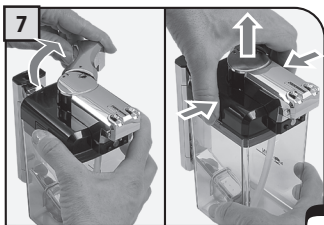

(Only for beverages with milk) Rotate the handle clockwise and press on the disengage buttons to allow the lid removal.

（僅限含有鮮奶的飲品）順時針方向旋轉手柄，按下解鎖按鈕取出手柄。

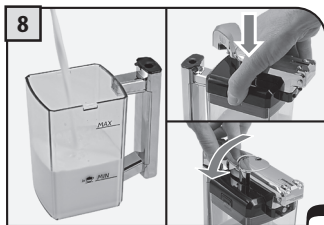

Fill the carafe with cold milk. Fill milk to above the "min" line, but do not exceed the "max" level indicated on the carafe. Replace the lid.

加入鮮奶，超過最小刻度線，但是不要超出最大刻度線。蓋上鮮奶壺蓋。



Insert the carafe inclined towards the front. The carafe base should be positioned on the hole (E) located on the drip tray. Insert the carafe by turning it towards the base through a round movement (as shown in the figure), until it is hooked to the hole (E) located in the drip tray. The carafe will be naturally back in place.

令鮮奶壺向前傾斜。鮮奶壺的底部應當插入滴水盤插槽 (E) 中。

如圖所示，將鮮奶壺以旋轉方式向下插入咖啡機，直到和滴水盤插槽 (E) 扣住。鮮奶壺將自然入位。



When the carafe with milk is not going to be used, or after using it, store it in the refrigerator.

不使用鮮奶壺時或用完後，必須將其放進冰箱保存。

CONTROL PANEL - 操作面板

The control panel has been designed to allow an ergonomic use of all machine functions.
操作面板符合人體工程學設計，可以控制本咖啡機所有功能。

Espresso button

義式濃縮咖啡按鈕

Cappuccino button

卡布奇諾按鈕

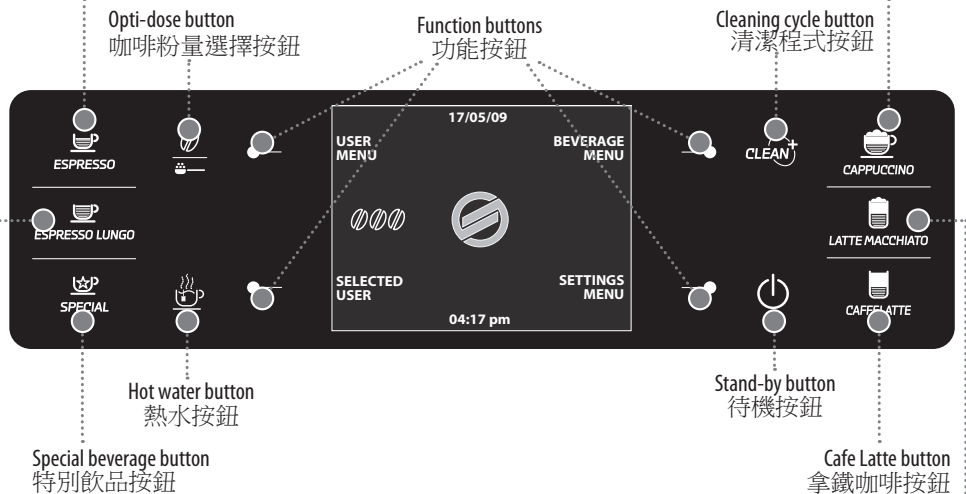

Long espresso button

義式淡咖啡按鈕

Cappuccino button

拿鐵瑪奇朵按鈕

ESPRESSO / LONG ESPRESSO - 義式濃縮咖啡/義式淡咖啡

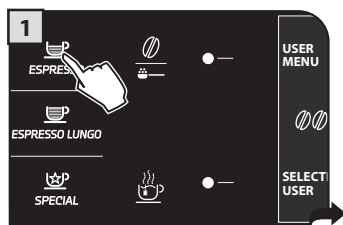

Press the espresso or long espresso button. Press once for 1 cup and twice for 2 cups.



The machine starts grinding the selected coffee quantity.



Coffee brewing can be stopped at any time by pressing the "STOP COFFEE" button.

If you wish to save the quantity of espresso being brewed, press and hold for 3 seconds.

Press "STOP COFFEE" to save the quantity.

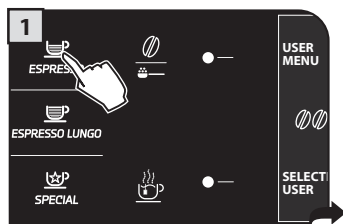

按下與所需飲品相關聯的按鈕。按 1 下為 1 杯，按 2 下為 2 杯。

如果需要記憶份量信息，請按下並保持 3 秒鐘。



開始研磨咖啡，準備沖煮。



可以隨時按下 STOP COFFEE 按鈕來終止該項操作。按下 STOP COFFEE 按鈕，記憶咖啡份量。

CAPPUCCINO / LATTE MACCHIATO / CAFE LATTE - 卡布奇諾 / 拿鐵瑪奇朵 / 拿鐵咖啡



WARNING: DISPENSING MAY BE PRECEDED BY SHORT SPURTS OF HOT WATER AND SCALDING IS POSSIBLE.

開始和結束沖煮時，可能會產生蒸汽和鮮奶液滴，有燙傷的危險。



Place a cup under the dispensing spout and rotate the upper part of the carafe clockwise.

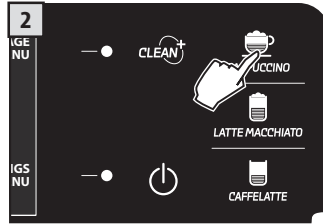

Press the button corresponding to the desired beverage.

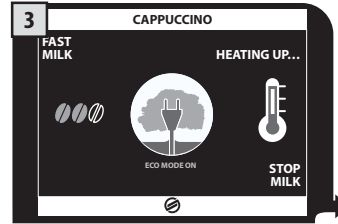

The machine starts brewing. It grinds the coffee and heats up for milk dispensing.

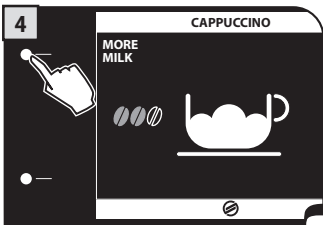

The machine allows dispensing an additional quantity of milk if the "More Milk" button is pressed.

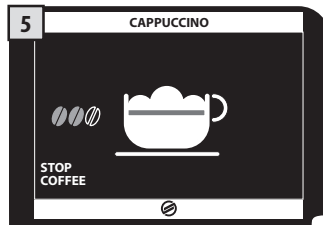

The machine brews the coffee.



At the end remove the cup with the beverage and replace the upper part of the milk carafe. The rinse cycle begins. (see the manual on page 17).



放進鮮奶壺並按順時針方向旋轉手柄。

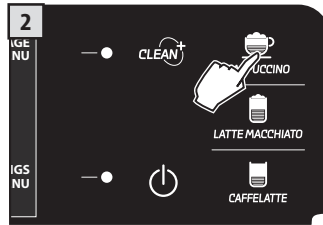

按下與所需飲品相對應的按鈕。

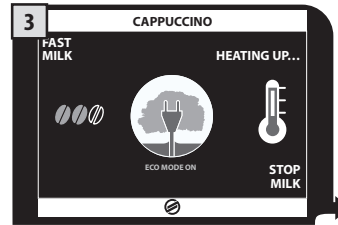

咖啡機開始準備工作。

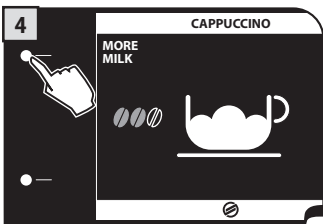

按下該按鈕後，咖啡機可以沖煮額外量的鮮奶。

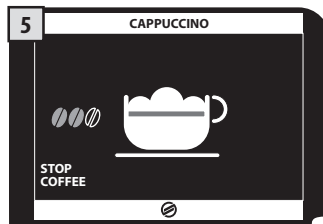

咖啡機沖煮咖啡。



結束後，將手柄放在待機位置上，開始沖洗程式。（參閱手冊第 17 頁）

HOT WATER DISPENSING - 沖煮熱水



WARNING: DISPENSING MAY BE PRECEDED BY SHORT SPURTS OF HOT WATER AND SCALDING IS POSSIBLE.
開始沖煮時，熱水可能濺出，存在燙傷危險



1 Place a container beneath the hot water/ steam wand.

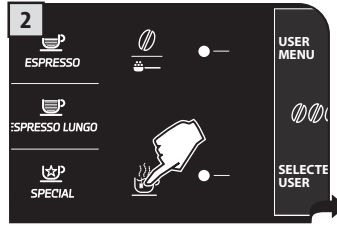

2 Press the hot water button to dispense the programmed quantity.



3 When hot water dispensing is complete, remove the container. Repeat the process to dispense another dose.



1 在熱水沖煮管下方放置一個器皿。

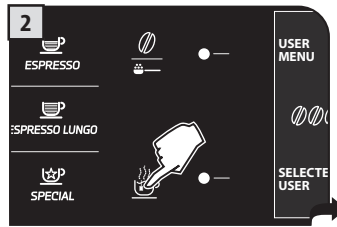

2 按下該按鈕沖煮預設份量的熱水。



3 完成後取出器皿。重複操作再沖煮一杯熱水。

STEAM DISPENSING - 沖煮蒸汽



WARNING: DISPENSING MAY BE PRECEDED BY SHORT SPURTS OF HOT WATER AND SCALDING IS POSSIBLE.
開始沖煮時，熱水可能濺出，存在燙傷危險。

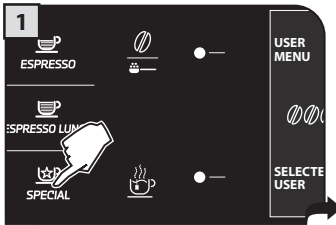

1 Press the special beverage to access the menu.



2 Place a container beneath the hot water/ steam wand.

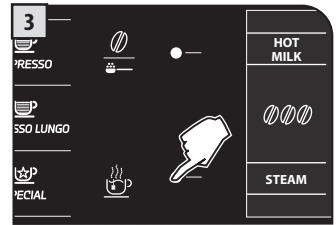

3 Press the special beverage button to dispense steam. Repeat the process to dispense another dose.

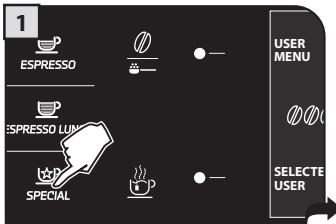

1 按下該按鈕進入選項。



2 在蒸汽沖煮管下方放置一個器皿。



3 按下該按鈕沖煮蒸汽。完成後重複該操作，再沖煮一份蒸汽。

MAINTENANCE DURING OPERATION - 運行過程中的維護

Operations to be performed with machine turned on when the following messages are displayed: "Empty coffee grounds drawer" and/or "Empty drip tray".
出現 EMPTY COFFEE GROUNDS DRAWER 和 EMPTY DRIP TRAY 訊息時，在開機狀態下執行下列操作。



Press the button and open the service door.

按下該按鈕，打開服務門。

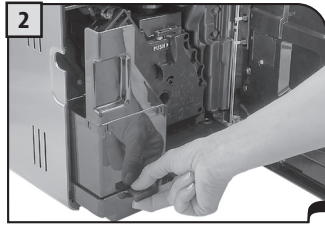

Remove the drip tray and used grounds drawer.

取出滴水盤及咖啡渣槽。

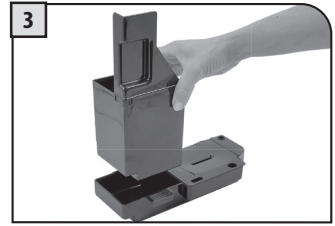

Empty the used grounds drawer and the drip tray, wash and replace back into machine.

倒空咖啡渣槽及滴水盤；用純淨水沖洗並放回原位。

GENERAL MACHINE CLEANING - 咖啡機常規清潔

The cleaning procedure described below must be carried out at least once a week.
下列清潔操作每週至少執行一次。

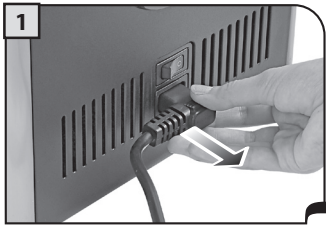

Turn off the machine and unplug it.

關閉咖啡機並拔掉電源插頭。

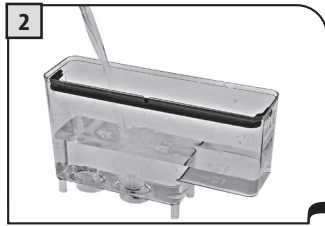

Take out the water tank and wash it with fresh water.

取出水箱，用乾淨的水清洗。

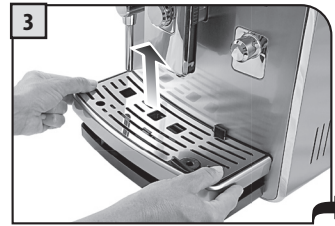

Remove the drip tray.

取出滴水盤。

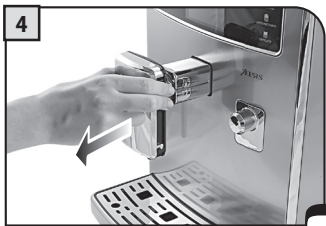

Remove the dispensing spout and wash it under running water.

取出咖啡龍頭，用乾淨的水清洗。



Clean the pre-ground bypass doser with a dry cloth.



















使用乾布擦淨預磨咖啡粉區。



Clean the steam wand and the display with a dry cloth.

使用濕布清潔蒸汽沖煮管和顯示幕。

MACHINE WARNINGS - 咖啡機警示訊息

Message	How to Reset the Message	訊息	如何令訊息復位
	Close the coffee bean hopper lid.		閉合咖啡豆槽蓋，以便沖煮飲品。
	Fill the coffee bean hopper with coffee beans.		將咖啡豆加入咖啡豆槽。
	Insert the brew group back in place.		將沖煮系統插入專用位置。
	Insert the used grounds drawer.		重新裝上咖啡渣槽。
	Open the service door and empty the liquid recovery tray, located under the brew group, and the used grounds drawer. The used grounds drawer must be emptied only when the machine requires it and with the machine on.		打開服務門蓋並清空沖煮系統下的咖啡渣槽和沖煮系統。 注意事項：僅在咖啡機要求且處於開機狀態時方可進行該項操作。
	Close the service door.		為了使咖啡機正常運轉，應當關閉服務門。
	Remove the water tank and refill it with fresh drinking water.		取出水箱並裝滿純淨飲用水。
	Open the service door and empty the liquid tray, located under the brew group, and the used grounds drawer.		打開服務門蓋並清空沖煮系統下的咖啡渣槽和沖煮系統。
	A beverage with milk has been selected. Press the "ESC" button to cancel the selection.		選擇了一種含有鮮奶的飲品。按 ESC 按鈕取消選擇。
	The carafe rinse function has been selected. Press the "ESC" button to cancel the selection.		選擇了鮮奶壺沖洗功能。按 ESC 按鈕取消選擇。
	An operation has been selected that requires dispensing milk from the milk carafe. Press the "ESC" button to cancel the selection.		選擇了需要鮮奶壺沖煮的操作。按 ESC 按鈕取消選擇。
	Perform a descaling cycle on the machine. Damages caused by failure to descale the machine are not covered by warranty.		咖啡機要求執行除鈣程式。因未能定期除鈣而導致的損壞不屬於保固範圍。
	Flashing red light. Machine in Stand-by. Press the "⏻" button.		指示燈閃爍紅光。咖啡機處於待機狀態。按下 ⏻ 按鈕。
	An event has occurred which requires the machine to restart. Take note of the code (E xx) shown at the bottom. Switch off the machine, wait 30 seconds and then switch it on again. If the problem persists, contact an authorized service center.		出現情況要求重新啟動咖啡機。請記錄下方顯示的故障代碼 (E xx)。關閉咖啡機，等待 30 秒鐘之後重新開機。若出現相同問題，請與服務中心聯繫。