

Keep me!

Keep me!

PHILIPS
Product support

Quick Start Guide

FastCare GC7700 series

Congratulations on the purchase of your Philips FastCare steam generator iron! It has a large detachable water tank for easy refill, more steam output and a smooth SteamGlide Ceramic soleplate that reduces ironing time. The carry lock and Smart CalcClean also make ironing more convenient.



1 Start



Press the water tank release button.



Remove the water tank from the base.



Fill the water tank up to the MAX indication.



Push the water tank back until you hear a click.

Use only tap water or demineralised water

Do not use the following types of water as they may cause leaking, brown staining and damage to your appliance: perfumed water, vinegar, descaling agents, ironing aids etc

2 Use



Check the fabric label.

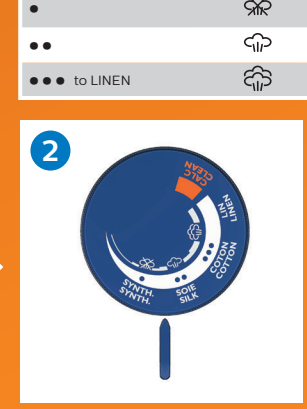

Set the temperature dial to the recommended temperature.



Press and hold the steam trigger to release steam for ironing.

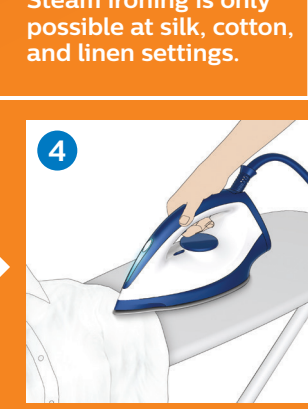

Keep the steam trigger pressed when you move the iron over the fabric.

Temperature setting	Automatic steam setting	Fabric type
•	☒	Synthetic fabrics (e.g., acetate, acrylic, nylon, polyamide)
••	☒	Wool, viscose, polyester and silk
••• to LINEN	☒	Cotton, linen.

Steam ironing is only possible at silk, cotton, and linen settings.

3 Extra features



For a steam boost, double press the trigger in quick succession.



Press the steam trigger and move the iron up and down the garment.

Safety auto-off mode (specific types only).
To save energy, the steam generator switches off automatically when it has not been used for 15 minutes. The 'iron ready' light flashes. To reactivate the steam generator, switch off the appliance and then switch on again.

Issue related to	Problem	Solution
The appliance has switched off.	The safety auto-off function was activated. This happens automatically when the steam generator has not been used or the steam trigger has not been pressed for more than 15 minutes.	Switch off the appliance and then switch on again.
The appliance produces a loud pumping sound.	The water tank is empty.	Fill the water tank with water and press the steam trigger until the pumping sound becomes softer and steam comes out of the soleplate.
Dirty water and impurities come out of the soleplate.	After the Calc-Clean process, remaining water may drip out of the soleplate. The Calc-Clean process has not been completed. Impurities or chemicals present in the water have deposited in the steam vents and/or soleplate.	Wipe the soleplate dry with a piece of cloth. If the Calc-Clean light still flashes and the appliance still beeps, perform the Calc-Clean process. See chapter 4 Calc-Clean. You have to perform the Calc-Clean process again. See chapter 4 Calc-Clean. Perform the Calc-Clean process regularly. See chapter 4 Calc-Clean.
Water flushes out of the soleplate.	You have accidentally started the Calc-Clean process. See chapter 4 Calc-Clean.	Switch off the appliance. Then switch it back on again. Turn the temperature dial to the desired temperature setting instead of CALC CLEAN. Let the iron heat up until the 'iron ready' light lights up steadily.
The Calc-Clean process does not start.	You have not set the temperature dial to CALC CLEAN, you have not waited for the iron to heat up or you have not pressed the Calc-Clean button for 2 seconds until the appliance started beeping.	See chapter 4 Calc-Clean.
There are water droplets visible in the appliance when I detach the water tank.	Water comes from the water path between the water tank and stand. This is normal.	These water droplets are harmless. If you want, you can wipe away the water droplets with a dry cloth.
Steam output is low.	You did not press the steam trigger continuously.	Keep the steam trigger pressed continuously when you move the iron over the fabric.



Any questions? Don't go back to the store, Philips is here to help. Contact us directly.

Call: 1300 363 391
www.philips.com/support

Call: 0800 658 224

Keep me!

4 Calc-Clean

Sound and light Calc-Clean reminder

- After 1 to 3 months of use, the Calc-Clean light starts flashing and the appliance starts beeping to indicate that you have to perform the Calc-Clean process.
- You can continue steam ironing for 1 hour while the Calc-Clean light flashes and the appliance beeps. After 1 hour, the steam function is automatically disabled. You have to perform the Calc-Clean process before you can continue steam ironing.
- Do not leave the appliance unattended during the Calc-Clean process.
- **Caution:** Do not interrupt the process by lifting the iron up from the Calc-Clean container, as hot water and steam will come out of the soleplate.



Perform the descaling procedure as soon as the Calc-Clean light starts to flash and the appliance beeps continuously. *Reminder: Use Calc-Clean container to collect dirty water.*



Fill up the water tank halfway.

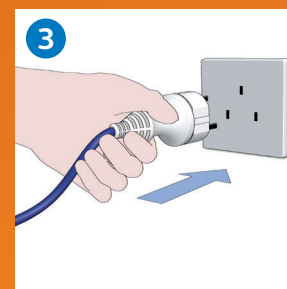

Make sure that the appliance is plugged in.



Switch ON the appliance.



Turn the temperature dial to CALC CLEAN.



Place the Calc-Clean container on the ironing board or any other even, stable surface.



Place the iron stably on the Calc-Clean container. *Note: It is perfectly safe to rest the iron on this container during the entire process.*

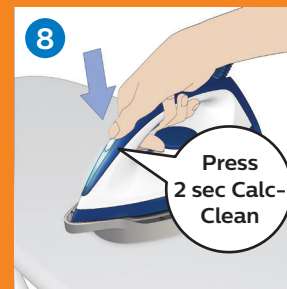

Press and hold the Calc-Clean button for 2 seconds until you hear short beeps.

During the calc-clean process, hot water and steam come out of the soleplate and you hear short beeps.



Wait approximately 2 minutes for the appliance to complete the process.



When the Calc-Clean process is completed, the iron stops beeping.



Wipe the iron with a piece of cloth and put the iron back on the base station.



Wait approximately 5 minutes for container to cool, pour away collected scale particles and hot water into the sink.

5 Storage



Place the iron on the base and press the carry lock to lock the iron into place.



Fold the supply hose and insert it into the hose storage compartment.

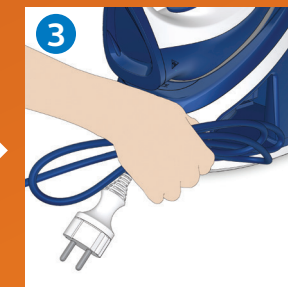

Fold the mains cord and insert it into the cord storage compartment.



Carry the appliance by the iron handle.

? Troubleshooting

Issue related to	Problem	Solution
The iron does not produce any steam.	There is not enough water in the water tank.	Fill the water tank beyond the MIN indication. Press and hold the steam trigger until steam comes out. It may take up to 30 seconds until steam comes out.
	You have not pressed the steam trigger.	Press and hold the steam trigger until steam comes out.
	You have set the temperature dial below ●●	Turn the temperature dial to ●● or higher.
	The steam function has been disabled until you have performed the Calc-Clean process.	Perform the Calc-Clean process to restore the steam function. See chapter 4 Calc-Clean.
The Calc-Clean light flashes and/or the appliance beeps continuously.	You have not placed the water tank in the appliance properly.	To put the water tank in the appliance properly, slide it into the appliance until it locks into place ('click').
	This is the Calc-Clean reminder.	Perform the Calc-Clean process before the steam function is disabled/to restore the steam function. See chapter 4 Calc-Clean.

Keep me!