

# PHILIPS

STE3160



---

EN User manual

---

IN Buku Petunjuk Pengguna

---

KO 사용 설명서

---

MS Manual pengguna

---

TH คู่มือผู้ใช้

---

VI Hướng dẫn sử dụng

















---

SC 用户手册

---

TC 使用手冊

---

	3		11
	4		11
	5		12
	6		15
	7		
	9		16
			17
	10		18
			

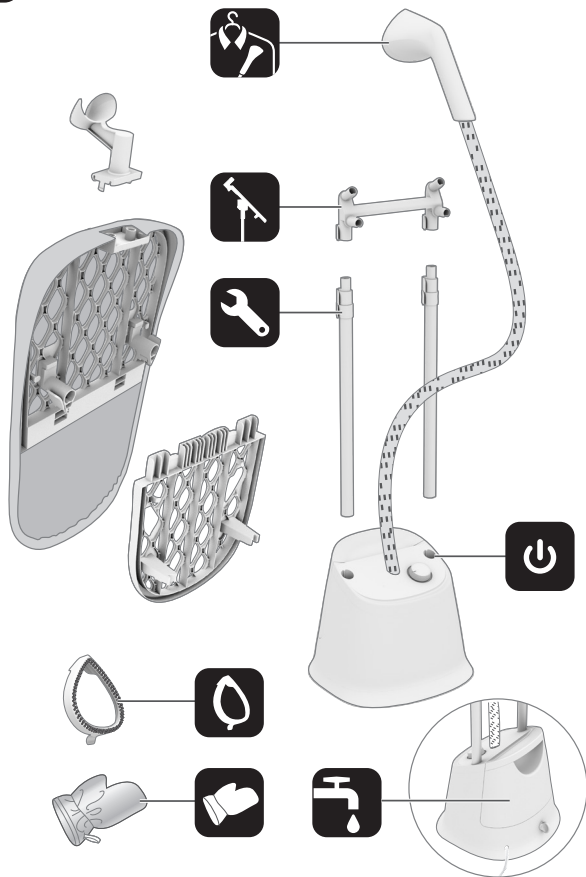

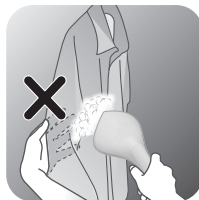

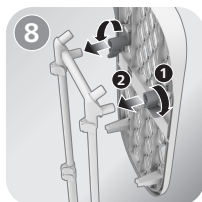
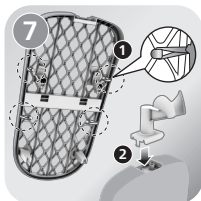
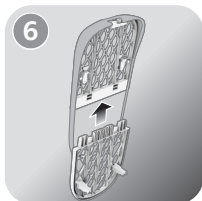
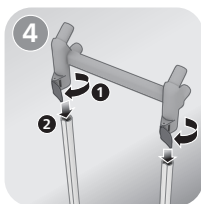
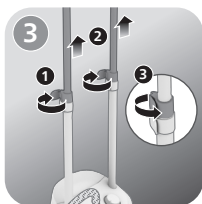
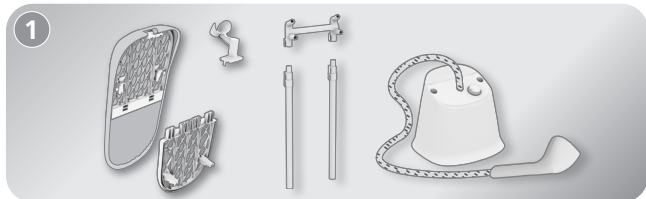

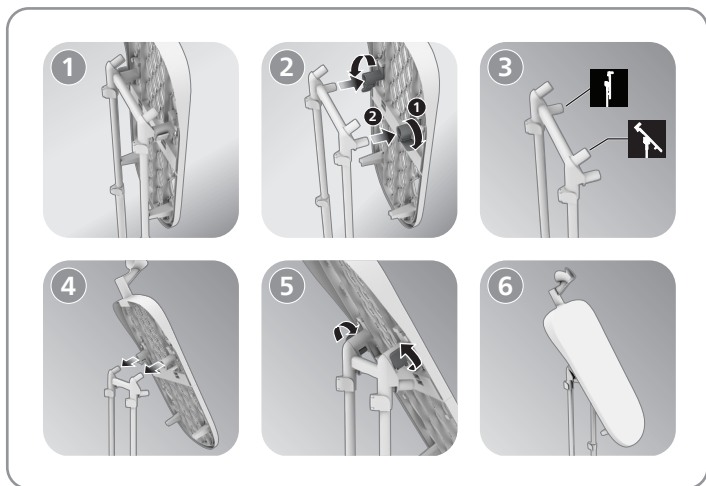



**EN** The appliance is suitable to be used with tap water. However, if you live in an area with hard water, we recommend that you mix an equal amount of tap water with distilled or demineralized water. This will prevent fast scale build up and prolong the lifetime of the appliance.

**Warning:** Do not use perfumed water, water from the tumble dryer, vinegar, starch, descaling agents, ironing aids, chemically descaled water or other chemicals, as they may cause water spitting, brown staining or damage to your appliance.

**ID** Alat ini bisa menggunakan air keran. Namun jika Anda tinggal di daerah dengan kesadahan air yang tinggi, kami sarankan untuk mencampurkan air keran dengan air suling dengan perbandingan yang sama.

Cara ini akan mencegah terbentuknya kerak dengan cepat dan memperpanjang masa pakai alat.

**Peringatan:** Jangan gunakan air berpewangi, air dari pengering pakaian, cuka, kanji, zat pembersih kerak, pelicin pakaian, air bebas kerak dengan proses kimia, atau bahan kimia lain, karena dapat menyebabkan semburan air, noda coklat, atau kerusakan pada alat.

**KO** 이 제품은 수도물로 사용하는 것이 적합합니다. 그러나 경수 지역에 거주하는 경우, 수도물과 같은 양의 증류수 또는 탈염수를 혼합하는 것이 좋습니다. 이로써 석회질이 빨리 쌓이지 않고, 제품의 수명이 연장됩니다.

**경고:** 향수, 회전식 건조기의 물, 식초, 풀, 석회질 제거제, 다림질 보조제, 이물질 제거용 화학 약품이나 기타 화학 용품을 넣지 마십시오. 물이 튀거나 갈색 얼룩이 생기거나 제품이 손상될 수 있습니다.

**MS** Perkakas sesuai untuk digunakan dengan air paip. Walau bagaimanapun, jika anda tinggal di kawasan dengan air liat, kami menasihatkan agar anda mencampurkan air paip dengan air suling atau air tanpa mineral dalam jumlah yang sama.

Langkah ini akan menghalang pembentukan karat yang cepat dan memanjangkan hayat perkakas anda.

**Amaran:** Jangan gunakan air berwangian, air dari mesin pengering pakaian, cuka, kanji, agen penyahkerak, bahan bantu penyeterikaan, air dinyahkerak secara kimia atau bahan kimia lain, kerana ini boleh menyebabkan air berdetus, kesan kotoran berwarna perang atau kerosakan pada perkakas anda.

**TH** เครื่องเหมาะสำหรับใช้งานกับน้ำประปา อย่างไรก็ตาม หากคุณอาศัยอยู่ในพื้นที่ที่น้ำกระด้างมาก เราขอแนะนำให้ให้คุณผสมน้ำประปาในปริมาณที่เท่ากันกับน้ำกลั่นหรือน้ำปราศจากแร่ธาตุ ซึ่งจะช่วยป้องกันไม่ให้เกิดตะกรันสะสมอย่างรวดเร็วและยืดอายุการใช้งานของเครื่อง

**คำเตือน:** ห้ามใช้น้ำหอม น้ำจากเครื่องอบผ้า น้ำส้มสายชู แป้ง น้ำยาขัดคราบตะกรัน ผลิตภัณฑ์สำหรับการรีดผ้า น้ำที่ขัดคราบตะกรันด้วยวิธีการทางเคมี หรือสารเคมีอื่นๆ เนื่องจากอาจทำให้น้ำกระด้าง เกิดคราบสีน้ำตาล หรือทำให้เครื่องเสียหายได้



**VI** Thiết bị thích hợp để sử dụng với nước máy. Tuy nhiên, nếu bạn sống ở khu vực có nước cứng, bạn nên hòa một lượng bằng nhau nước máy và nước cất hoặc nước đã khử khoáng.

Việc này sẽ ngăn đóng cặn nhanh và giúp kéo dài tuổi thọ của thiết bị.

**Cảnh báo:** Không thêm nước hoa, nước từ máy sấy đảo, giấm, hồ vải, chất làm sạch cặn, chất phụ trợ ủi, nước đã được tẩy sạch bằng hóa chất hoặc các hóa chất khác, do các chất này có thể gây tình trạng phun nước, ổ vàng hoặc làm hỏng thiết bị của bạn.

**SC** 本产品可使用自来水。但如果您居住的区域水质较硬，我们建议您将等量的自来水与蒸馏水或软化水混合使用。

这样可以防止水垢快速积聚，从而延长产品的使用寿命。

**警告:** 切勿使用香水、转筒式干燥机中的水、醋、淀粉、除垢剂、熨衣剂、化学除垢水或其他化学品，因为它们可能会导致喷水、留下褐色污垢或损坏产品。

**TC** 本产品適合搭配自來水使用。不過，如果您居住地區的水質偏硬，建議您將等量的自來水與蒸餾水或軟化水混合。

如此可避免快速累積水垢，並延長產品的使用壽命。

**警告:** 請勿使用香水、滾筒式烘乾機的水、醋、燙衣漿、除垢劑、熨燙添加劑、經化學除垢的水或其他化學物質，否則可能造成水噴濺溢漏、產生棕色汗漬或損壞產品。

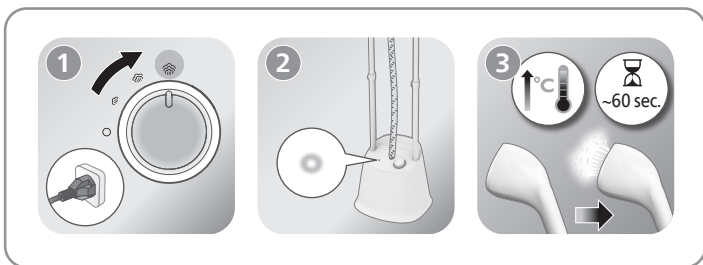

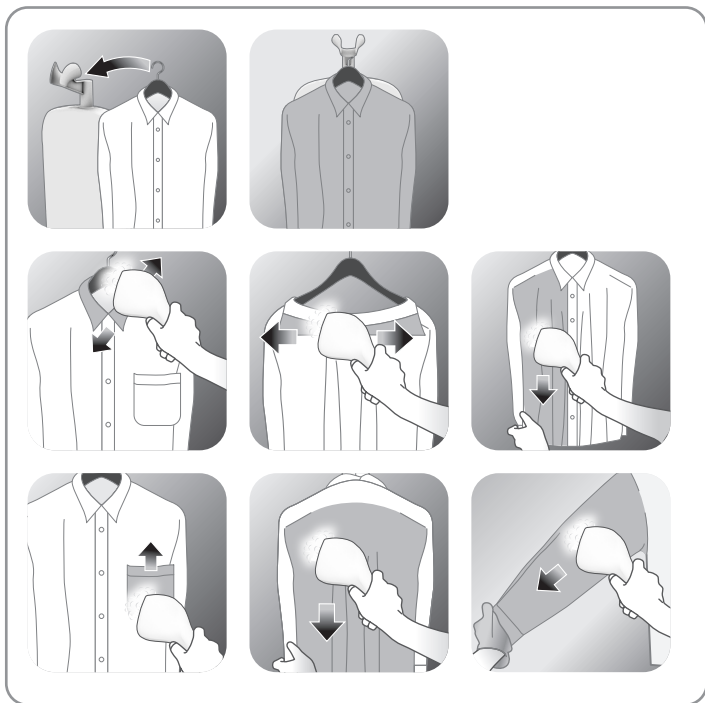

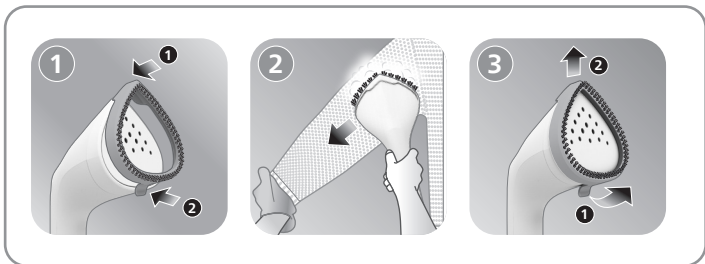
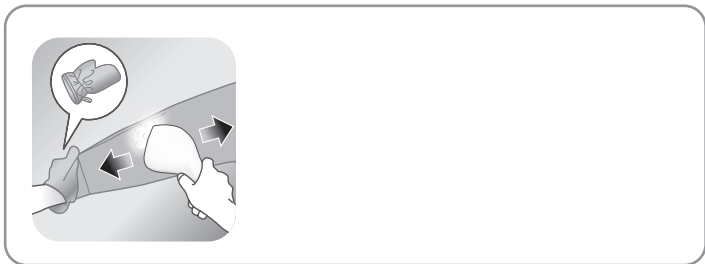

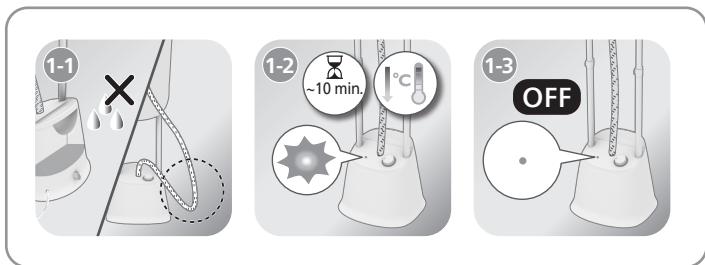

**EN** **Figure 1-1:** The appliance will go into auto-off mode (LED light will blink) when the water tank is empty or when the steam hose is bent. **Figure 1-3:** It switches off automatically after 10 minutes if the water tank is not refilled or the steam hose is not straightened.

**IN** **Gambar 1-1:** Alat akan masuk ke mode mati otomatis (lampu LED akan berkedip) jika tangki air kosong atau slang uap tertekuk. **Gambar 1-3:** Alat akan mati otomatis setelah 10 menit jika tangki air tidak diisi ulang atau slang uap tidak ditegakkan.

**KO** **그림 1-1:** 물탱크가 비어 있거나 스팀 호스가 구부러지면 제품은 자동 전원 차단 모드(LED 표시등이 깜박임)로 전환됩니다.

**그림 1-3:** 물탱크에 물을 채우지 않거나 스팀 호스를 곧게 펴지 않으면 10분 후에 자동으로 전원이 꺼집니다.

**MS** **Rajah 1-1:** Perkakas akan memasuki mod pematian automatik (lampu LED akan berkelip) apabila tangki air kosong atau apabila hos stim dibengkokkan.

**Rajah 1-3:** Dimatikan secara automatik selepas 10 minit jika tangki air tidak diisi semula atau hos stim tidak diluruskan.

**TH** **รูป 1-1:** เครื่องจะเข้าสู่โหมดปิดเครื่องอัตโนมัติ (ไฟ LED จะกะพริบ) เมื่อแทงคน้ำว่างเปล่าหรือเมื่อท่ส่งไอน้ำคดงอ

**รูป 1-3:** เครื่องจะปิดโดยอัตโนมัติหลังจากผ่านไป 10 นาทีหากไม่ได้เติมน้ำในแทงค์หรือท่ส่งไอน้ำไม่ยืดตรง

**VI** **Hình 1-1:** Thiết bị sẽ chuyển sang chế độ tự động tắt (dèn LED sẽ nhấp nháy) khi ngăn chứa nước cạn hoặc khi ống cấp hơi phun bị uốn cong.

**Hình 1-3:** Thiết bị tự động tắt sau 10 phút nếu ngăn chứa nước không được châm đầy lại hoặc ống cấp hơi phun không được duỗi thẳng.

**SC** **图 1-1:** 当水箱为空或蒸汽管弯折时, 产品将进入自动关闭模式 (LED 指示灯将闪烁)。

**图 1-3:** 如果水箱未重新加水或蒸汽管未拉直, 则 10 分钟后, 产品会自动关闭。

**TC** **圖 1-1:** 水箱空了或蒸氣軟管彎折時, 產品會進入自動關機模式 (LED 指示燈會閃爍)。

**圖 1-3:** 若超過 10 分鐘後水箱仍未加水或蒸氣軟管仍未拉直, 將自動關機。



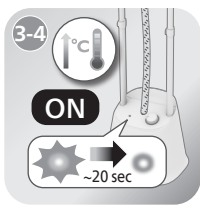
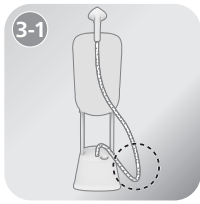

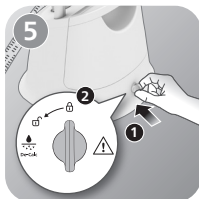
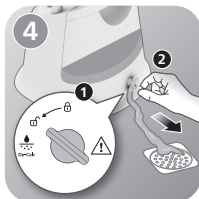





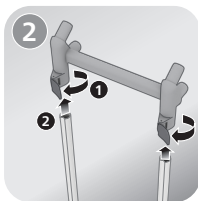



**EN** If you have any problems, visit [www.philips.com/support](http://www.philips.com/support) for a list of frequently asked questions or contact the Consumer Care Center in your country.

**IN** Jika Anda mengalami masalah, kunjungi [www.philips.com/support](http://www.philips.com/support) untuk melihat daftar pertanyaan yang sering diajukan, atau hubungi Pusat Layanan Konsumen di negara Anda.

**KO** 문제가 있을 경우 [www.philips.com/support](http://www.philips.com/support)를 방문하여 자주 묻는 질문(FAQ) 목록을 참조하거나 해당 지역의 고객 상담실로 문의하십시오.

**MS** Jika anda mempunyai sebarang masalah, lawati [www.philips.com/support](http://www.philips.com/support) untuk mendapatkan senarai soalan lazim atau hubungi Pusat Layanan Pelanggan di negara anda.

**TH** หากมีปัญหา โปรดเยี่ยมชม [www.philips.com/support](http://www.philips.com/support) สำหรับรายการคำถามที่พบบ่อยหรือติดต่อศูนย์บริการลูกค้าในประเทศของคุณ

**VI** Nếu bạn gặp bất kỳ sự cố nào, hãy truy cập [www.philips.com/support](http://www.philips.com/support) để xem danh sách các câu hỏi thường gặp hoặc liên hệ với Trung tâm Chăm sóc Khách hàng tại quốc gia của bạn.

**SC** 如果您有任何问题，请访问 [www.philips.com/support](http://www.philips.com/support) 查阅常见问题列表，或联系您所在国家/地区的客户服务中心。

**TC** 如有任何問題，請造訪 [www.philips.com/support](http://www.philips.com/support) 查看常見問題集清單，或聯絡您所在國家/地區的客户服務中心。





PHILIPS and the Philips Shield Emblem are registered trademarks of Koninklijke Philips N.V. and are used under license.

飞利浦及飞利浦盾徽标志是Koninklijke Philips N.V. 的注册商标且经许可使用。

This product has been manufactured by and is sold under the responsibility of Versuni Holding B.V., and Versuni Holding B.V. is the warrantor in relation to this product.

本产品由 Versuni Holding B.V. 负责生产并销售，且 Versuni Holding B.V. 是本产品的担保方。

2023 © Versuni Holding B.V.

642001002359 (24/07/2023)

